



**Price**  
**£270,000**

**Leasehold**

2x  1x  1x 

**Trotwood, Chigwell,  
Essex IG7**



## Main features

- First floor purpose built flat
- Lease being extended to 148 years from 1982
- Close to Central Line station and amenities
- Ideal first purchase or rental investment
- Communal garden

## Accommodation

### FIRST FLOOR

Entrance Hall

Bedroom 2: 9'0 x 6'8 (2.75m x 2.03m)

Bedroom 1: 12'7 x 9'2 (3.84m x 2.80m)

Bathroom

Lounge/Diner: 15'8 x 11'3 (4.78m x 3.43m)

Kitchen: 8'5 x 8'5 (2.57m x 2.57m)

### OUTSIDE

Communal Garden

## First Floor

Approx. 50.1 sq. metres (539.1 sq. feet)

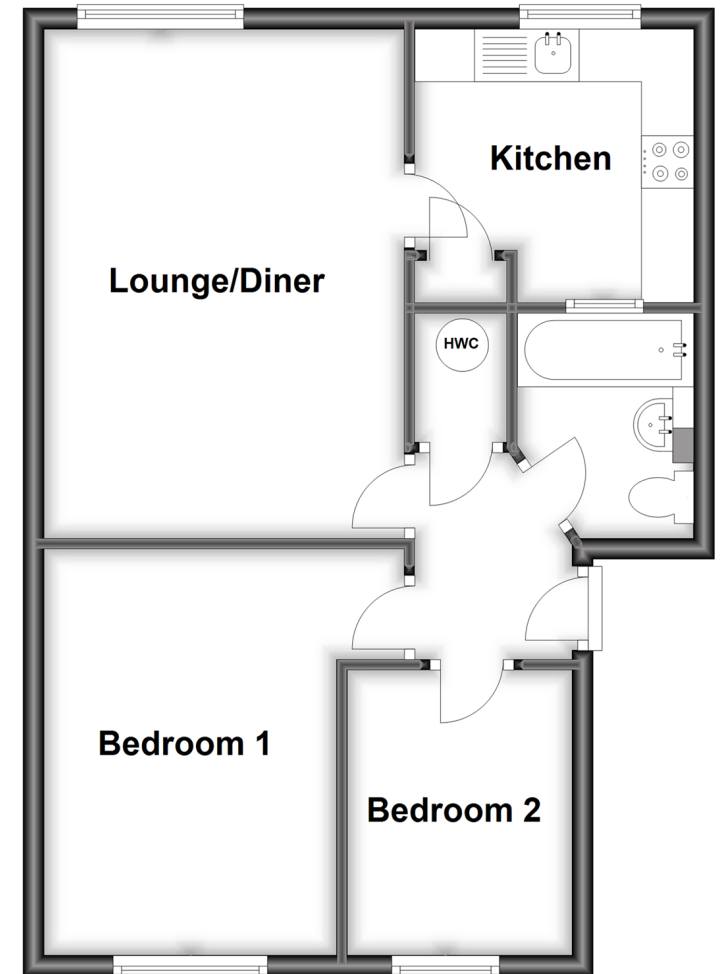

Call Chigwell - 020 8501 2131 ■ [douglasallen.co.uk](http://douglasallen.co.uk)

- A private rental licensing scheme applies to some properties in this area, please contact us before proceeding
- Legal advice should be taken to verify fixtures/fittings, planning, alterations and/or lease details
- Appliances & services are untested, dimensions are approximate and floor plans are not to scale



50907264/20230509/FC/CR