



**Price**

**£280,000**

**Leasehold**

2x  1x  1x 

**Burns Avenue, Chadwell  
Heath, Essex, RM6**

**OVER 60?**

Secure this property  
for up to **59% less!**

 **DOUGLAS  
ALLEN**  
Helping you move forwards



## Main features

- Second floor purpose built flat situated in the Redbridge Borough
- Ideal purchase for any first time buyers
- Walking distance to Chadwell Heath station & Elizabeth Line
- Close to local amenities
- Allocated parking space
- CHAIN FREE

## Accommodation

### SECOND FLOOR

Entrance Hall

Lounge/Diner: 15'8 x 13'7 (4.78m x 4.14m)

Kitchen: 8'3 x 6'3 (2.52m x 1.91m)

Bedroom 1: 13'6 x 9'3 (4.12m x 2.82m)

Bedroom 2: 9'4 x 6'8 (2.85m x 2.03m)

### OUTSIDE

Allocated Parking  
Communal Garden

## Second Floor

Approx. 51.7 sq. metres (556.1 sq. feet)

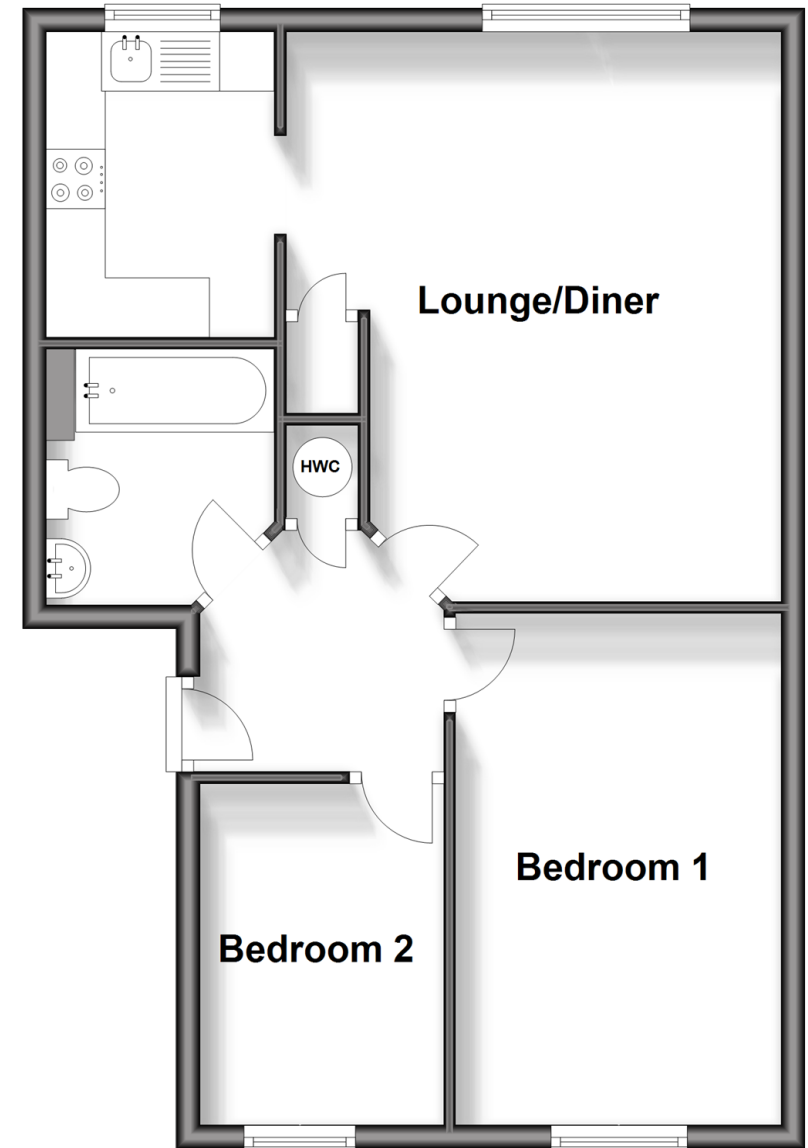

Call Chadwell Heath - 020 8597 0043 ■ [douglasallen.co.uk](http://douglasallen.co.uk)

- A private rental licensing scheme applies to some properties in this area, please contact us before proceeding
- Legal advice should be taken to verify fixtures/fittings, planning, alterations and/or lease details
- Appliances & services are untested, dimensions are approximate and floor plans are not to scale
- Through a Homewise Home For Life Plan people aged 60+ can secure this property for up to 59% less, by purchasing a Lifetime Lease.



50713887/20240615/CN/AV