



Price

£330,000

Leasehold

2x  1x  1x 

**Brambledown Road,
Wallington, Surrey, SM6**

cubitt&west
Helping you move forwards



Main features

- Excellent apartment situated in a popular residential road
- Presented beautifully throughout
- Within easy reach of Wallington high street, train station and popular schools
- Spacious lounge/diner and modern fitted shower room
- Communal gardens

Accommodation

GROUND FLOOR

Entrance Hall

Lounge/Diner: 19'9 x 11'6 (6.02m x 3.51m)

Kitchen: 8'8 x 7'8 (2.64m x 2.34m)

Bedroom 1: 12'9 x 8'8 (3.89m x 2.64m)

Bedroom 2: 8'8 x 7'10 (2.64m x 2.39m)

Shower Room

OUTSIDE

Communal Gardens

Ground Floor

Approx. 59.8 sq. metres (643.8 sq. feet)

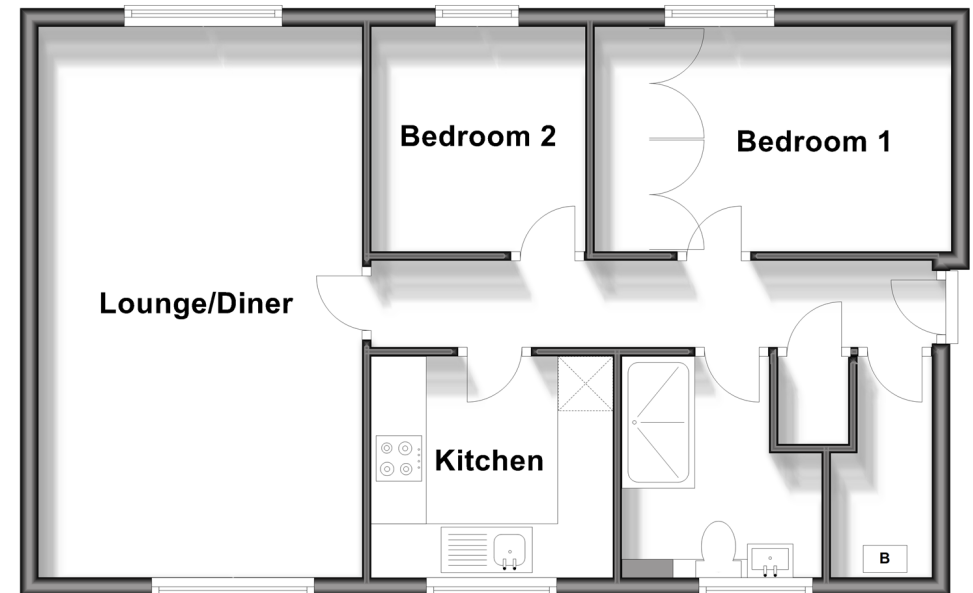

Call Wallington - 020 8647 0011 ■ cubittandwest.co.uk

- A private rental licensing scheme applies to some properties in this area, please contact us before proceeding
- Legal advice should be taken to verify fixtures/fittings, planning, alterations and/or lease details

- If buying to let, the energy rating will need to be improved to at least 'E' rating before you can let the property
- Appliances & services are untested, dimensions are approximate and floor plans are not to scale



22109371/20240415/GG/DK