



OVER 60?

Secure this property
for up to **59% less!**

Guide Price
£270,000

Leasehold

2x  1x  1x 

**Boniface House,
Canterbury Road,
Croydon, Surrey, CR0**

cubitt&west
Helping you move forwards



Main features

- **Modern second floor apartment in an ideal location**
- **Bright open plan kitchen/lounge to relax and entertain in**
- **Benefits from its own private balcony and communal gardens to enjoy the summer sunshine**
- **Spacious entrance hall**
- **Situated in a highly convenient location with amenities, bus and tram stops all within walking distance**

Accommodation

SECOND FLOOR

Entrance Hall
Lounge/Kitchen/Diner: 21'3 x 13'1 (6.48m x 3.99m)
Bedroom 1: 14'9 x 10'2 (4.50m x 3.10m)
Bedroom 2: 13'9 x 8'6 (4.19m x 2.59m)
Bathroom

OUTSIDE

Private Balcony
Residents Only Parking

Second Floor

Approx. 65.8 sq. metres (708.8 sq. feet)

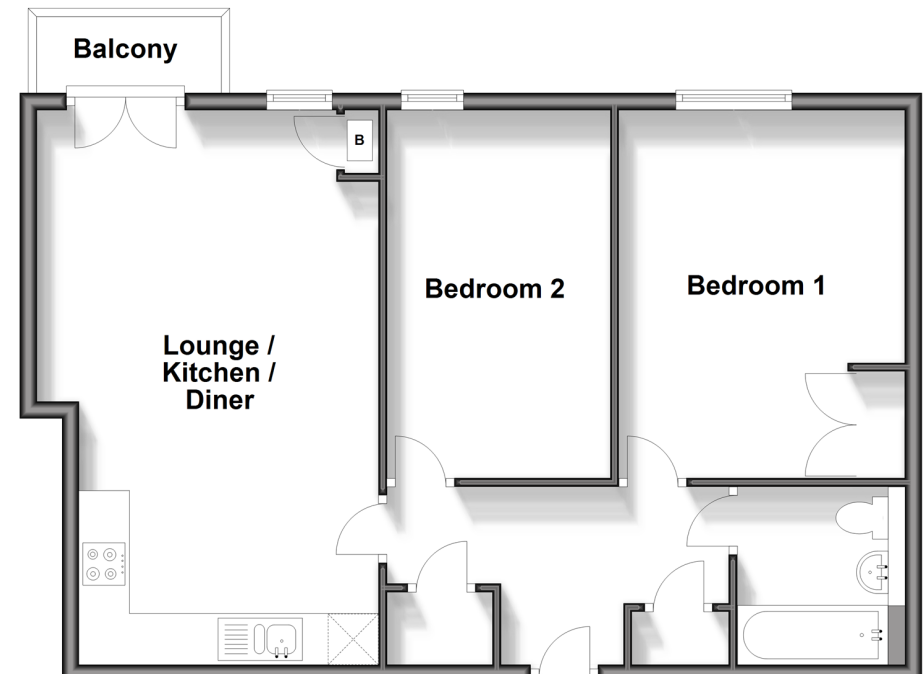

Call Shirley - 020 8654 3037 ■ cubittandwest.co.uk

- A private rental licensing scheme applies to some properties in this area, please contact us before proceeding
- Appliances & services are untested, dimensions are approximate and floor plans are not to scale

- Legal advice should be taken to verify fixtures/fittings, planning, alterations and/or lease details
- Through a Homewise Home For Life Plan people aged 60+ can secure this property for up to 59% less, by purchasing a Lifetime Lease.

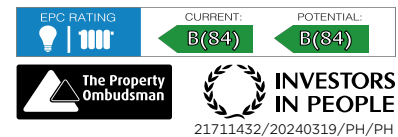

21711432/20240319/PH/PH