



Price

£100,000

1x  1x  1x 

**Sycamore Walk,
Broadway Park,
Petersfield, Hampshire,
GU31**

cubitt & west
Helping you move forwards



Main features

- Property was new in 2017
- Open plan living space
- Over 50's residential park site
- Beautiful peaceful undisturbed views of Broadway Farm
- Great location for Petersfield town centre and offered with no forward chain

Accommodation

GROUND FLOOR

Entrance Hall

Lounge: 10'9 x 9'0 (3.28m x 2.75m)

Kitchen: 9'0 x 8'8 (2.75m x 2.64m)

Bedroom 1: 9'0 x 8'4 (2.75m x 2.54m)

Bathroom

OUTSIDE

Rear Garden

Ground Floor

Approx. 29.3 sq. metres (315.2 sq. feet)

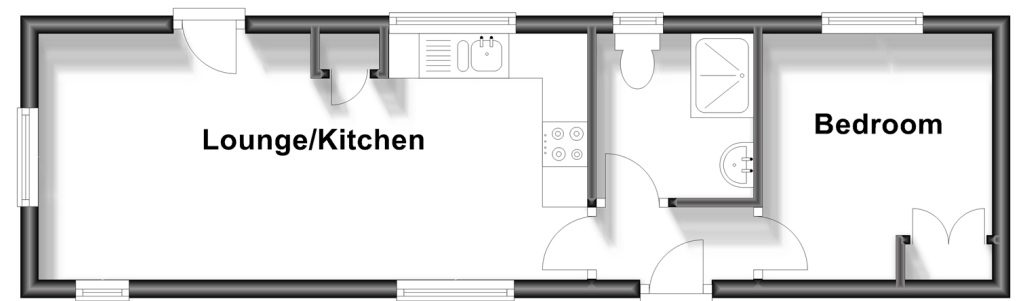

Call Petersfield - 01730 262931 ■ cubittandwest.co.uk

- If buying to let, the energy rating will need to be improved to at least 'E' rating before you can let the property
- Legal advice should be taken to verify fixtures/fittings, planning, alterations and/or lease details
- Appliances & services are untested, dimensions are approximate and floor plans are not to scale



23316565/20241031/EC/SA