

OVER 60?

Secure this property
for up to **59% less!**



Price

£400,000

Freehold

3x  1x  1x 

Malling Street, Lewes, East Sussex, BN7

cubitt & west
Helping you move forwards



Main features

- Double fronted period cottage, full of charm
- Character features including fireplaces
- Surprisingly close to the town centre
- Excellent road and bus links nearby
- Private, walled courtyard garden
- In need of some modernisation

Accommodation

Lounge: 14'3 x 10'2 (4.35m x 3.10m)

Kitchen: 12'0 x 11'4 (3.66m x 3.46m)

Conservatory: 11'4 x 7'8 (3.46m x 2.34m)

Bedroom 1: 13'3 x 10'3 (4.04m x 3.13m)

Bedroom 2: 12'1 x 11'8 (3.69m x 3.56m)

Bedroom 3: 9'2 x 7'6 (2.80m x 2.29m)

Bathroom

Ground Floor

Approx. 47.0 sq. metres (506.1 sq. feet)

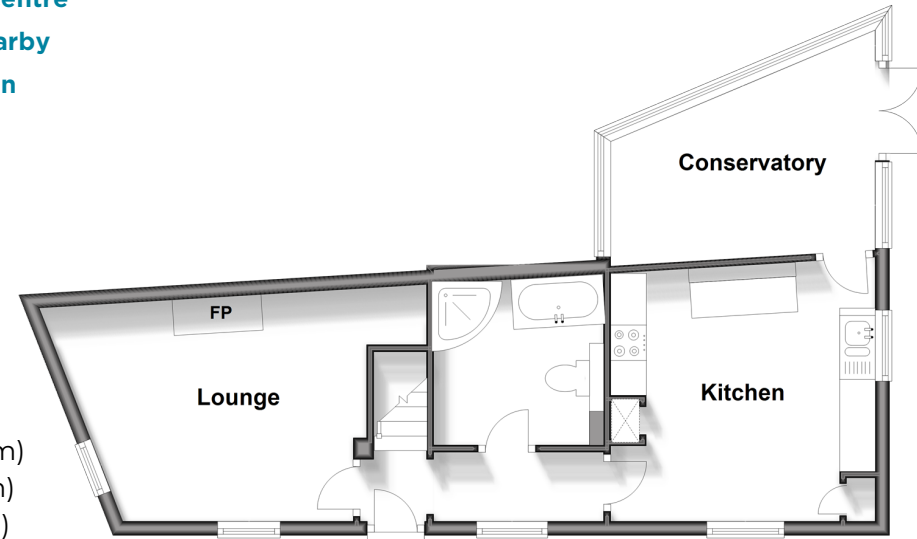

First Floor

Approx. 37.6 sq. metres (405.2 sq. feet)

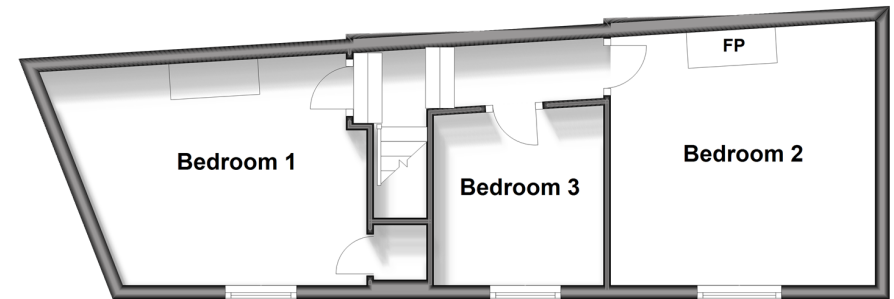

Call Lewes - (01273) 471231 ■ cubittandwest.co.uk

- Legal advice should be taken to verify fixtures/fittings, planning, alterations and/or lease details
- Appliances & services are untested, dimensions are approximate and floor plans are not to scale
- Through a Homewise Home For Life Plan people aged 60+ can secure this property for up to 59% less, by purchasing a Lifetime Lease.



23008956/20240923/JL1/TW