



Price
£550,000

Freehold

3x  1x  2x 

**The Crescent, Horsham,
West Sussex, RH12**

OVER 60?

Secure this property
for up to **59% less!**

cubitt & west
Helping you move forwards



Main features

- Located towards the end of a quiet and peaceful cul de sac
- Spacious property with a good size lounge and dining room
- A fantastic large rear garden
- Within walking distance for most to local shops and the town centre
- Scope to improve and add value, subject to any necessary consents

Accommodation

GROUND FLOOR

Kitchen: 13'6 at widest point x 9'8 at widest point (4.12m x 2.95m)

Utility Room

Lounge: 14'11 at widest point x 13'5 at widest point (4.55m x 4.09m)

Dining Room: 15'0 at widest point x 13'7 at widest point (4.58m x 4.14m)

Inner Hallway: 6'0 x 5'11 (1.83m x 1.80m)

Bathroom: 5'11 x 5'5 (1.80m x 1.65m)

Bedroom 1: 13'6 at widest point x 10'9 at widest point (4.12m x 3.28m)

Bedroom 2: 13'6 at widest point x 10'9 at widest point (4.12m x 3.28m)

Bedroom 3

OUTSIDE

Front & Rear Garden

Off Road Parking

Ground Floor

Approx. 107.2 sq. metres (1153.9 sq. feet)

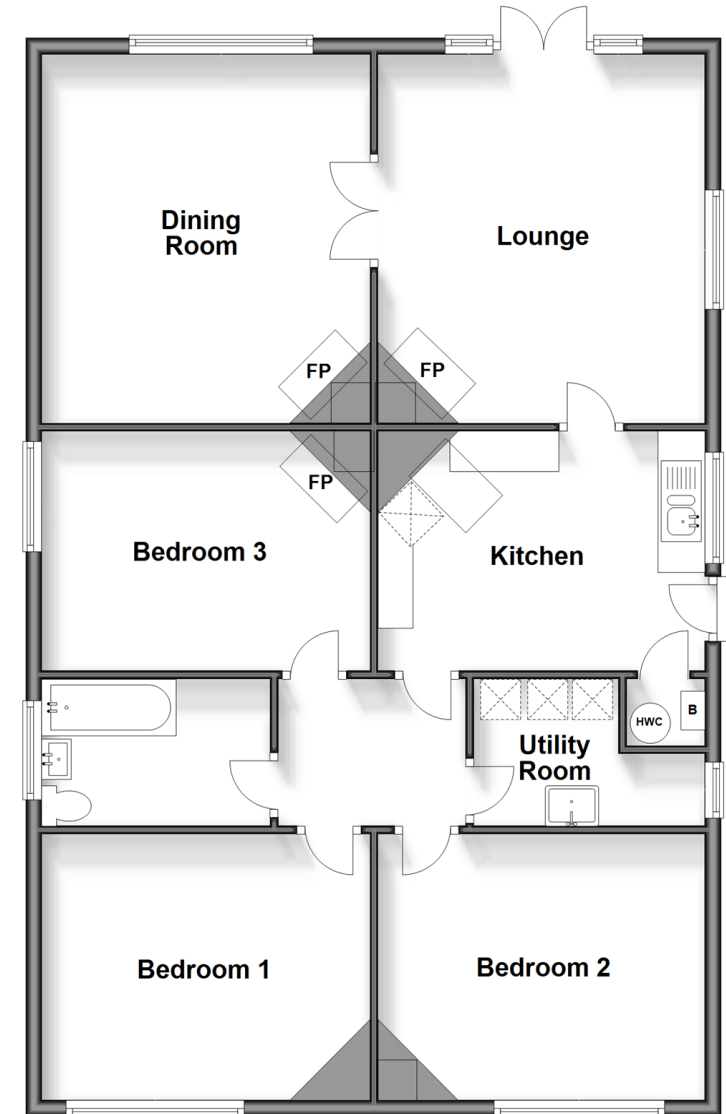

Call Horsham - 01403 269268 ■ cubittandwest.co.uk

- Legal advice should be taken to verify fixtures/fittings, planning, alterations and/or lease details
- Appliances & services are untested, dimensions are approximate and floor plans are not to scale
- Through a Homewise Home For Life Plan people aged 60+ can secure this property for up to 59% less, by purchasing a Lifetime Lease.



20916693/20240923/CB/CB