



Fenmen Place, Wisbech PE13 3FA

Welcome to

Fenmen Place, Wisbech

A PERFECT FIRST FAMILY HOME! Situated in the popular Walsoken area of Wisbech, this modern mid terraced house is presented in immaculate condition throughout and would make a fantastic home for the young family! With three bedrooms (the master having en-suite facilities) and a 15' lounge/dining room, the property also benefits from air source pump heating system, a downstairs cloakroom, PVCu double glazing and allocated parking for two cars.



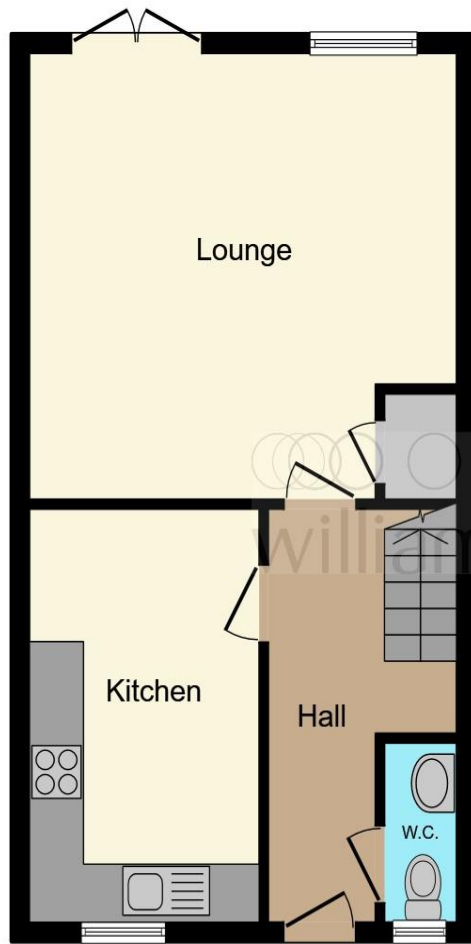

Ground Floor

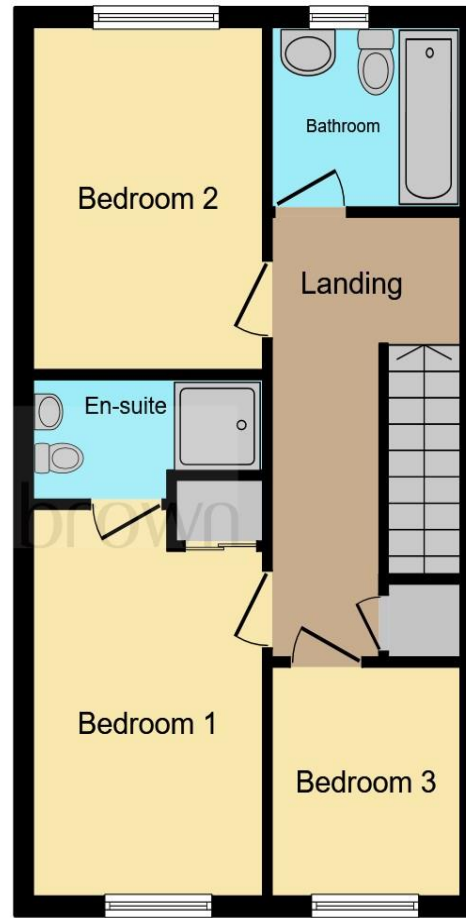

First Floor

Entrance Hall

Downstairs Cloakroom

5' 6" x 2' 10" (1.68m x 0.86m)

Kitchen

13' 11" x 8' 5" (4.24m x 2.57m)

Lounge/Dining Room

15' 1" x 15' 6" maximum (4.60m x 4.72m maximum)

First Floor Landing

Master Bedroom

13' 4" into wardrobes x 8' 5" (4.06m into wardrobes x 2.57m)

En-Suite

4' 1" x 8' 5" maximum (1.24m x 2.57m maximum)

Bedroom Two

11' 7" x 8' 5" (3.53m x 2.57m)

Bedroom Three

7' 9" x 6' 9" (2.36m x 2.06m)

Family Bathroom

6' 1" x 6' 9" (1.85m x 2.06m)

This floor plan is for illustrative purposes only. It is not drawn to scale. Any measurements, floor areas (including any total floor area), openings and orientation are approximate. No details are guaranteed, they cannot be relied upon for any purpose and they do not form part of any agreement. No liability is taken for any error, omission or misstatement. A party must rely upon its own inspection(s). Powered by www.focalagent.com

Welcome to

Fenmen Place, Wisbech

- Modern mid terraced house
- Three bedrooms
- En-suite to master
- Allocated parking
- Immaculate Condition

Tenure: Freehold EPC Rating: B

£185,000



Directions to this property:

From Wisbech Freedom Bridge roundabout take the Lynn Road signposted Walsoken & Port Area. Proceed to the mini roundabout and turn right into Lerowe Road. Follow along and turn right into Fenmen place where the property is on the left hand side.



Please note the marker reflects the postcode not the actual property

view this property online williamhbrown.co.uk/Property/WSB124116



Property Ref:
WSB124116 - 0004

1. MONEY LAUNDERING REGULATIONS Intending purchasers will be asked to produce identification documentation at a later stage and we would ask for your co-operation in order that there is no delay in agreeing the sale. 2. These particulars do not constitute part or all of an offer or contract. 3. The measurements indicated are supplied for guidance only and as such must be considered incorrect. Potential buyers are advised to recheck measurements before committing to any expense. 4. We have not tested any apparatus, equipment, fixtures or services and it is in the buyers interest to check the working condition of any appliances. 5. Where an EPC, or a Home Report (Scotland only) is held for this property, it is available for inspection at the branch by appointment. If you require a printed version of a Home Report, you will need to pay a reasonable production charge reflecting printing and other costs. 6. We are not able to offer an opinion either written or verbal on the content of these reports and this must be obtained from your legal representative. 7. Whilst we take care in preparing these reports, a buyer should ensure that his/her legal representative confirms as soon as possible all matters relating to title including the extent and boundaries of the property and other important matters before exchange of contracts.

William H Brown is a trading name of Sequence (UK) Limited which is registered in England and Wales under company number 4268443, Registered Office is Cumbria House, 16-20 Hockliffe Street, Leighton Buzzard, Bedfordshire, LU7 1GN. VAT Registration Number is 500 2481 05.



william h brown



01945 464451



Wisbech@williamhbrown.co.uk



20 High Street, WISBECH, Cambridgeshire,
PE13 1DE



williamhbrown.co.uk