



Beechfield Road, Welwyn Garden City AL7 3RG

welcome to

Beechfield Road, Welwyn Garden City

This fantastic CHAIN FREE three bedroom end of terrace property is ideally located close to local schooling, Welwyn Garden City Town centre and main line train station into London Kings Cross and Moorgate. Internally on the ground floor the property comprises of entrance hall, large lounge that leads into the kitchen/diner with door to the rear garden. Upstairs offers three great sized bedrooms and family bathroom. Externally the property benefits from a generous rear garden with side access and driveway with parking for two cars.



Entrance Hall

Laminate wood flooring, radiator.

Lounge

12' 7" x 11' 11" (3.84m x 3.63m)

Double glazed window to front, laminate wood flooring, gas fireplace, under stairs storage.

Kitchen/Diner

16' 1" x 9' 4" (4.90m x 2.84m)

Double glazed window to rear, back door to garden, tiled flooring, integrated dishwasher, electric oven, gas hob, sink, extractor.

Bedroom One

12' 6" x 10' 4" (3.81m x 3.15m)

Double glazed window to front, laminate wood flooring, radiator.

Bedroom Two

10' 4" x 9' 4" (3.15m x 2.84m)

Double glazed window to rear, carpet, radiator.

Bedroom Three

8' 9" x 7' 6" (2.67m x 2.29m)

Double glazed window to side, radiator, carpet.

Bathroom

Double glazed window to side, tiled flooring, bath, electric shower, W/C, wash hand basin, radiator.

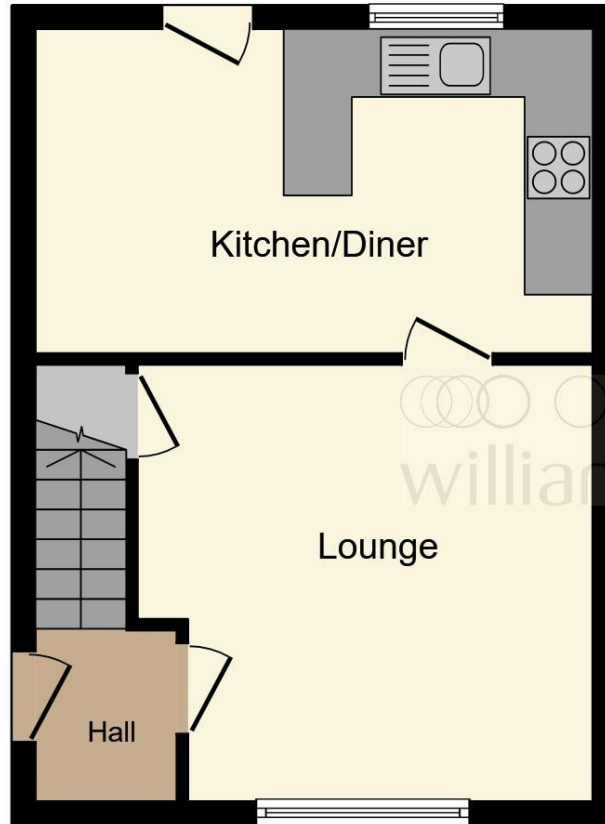

Ground Floor

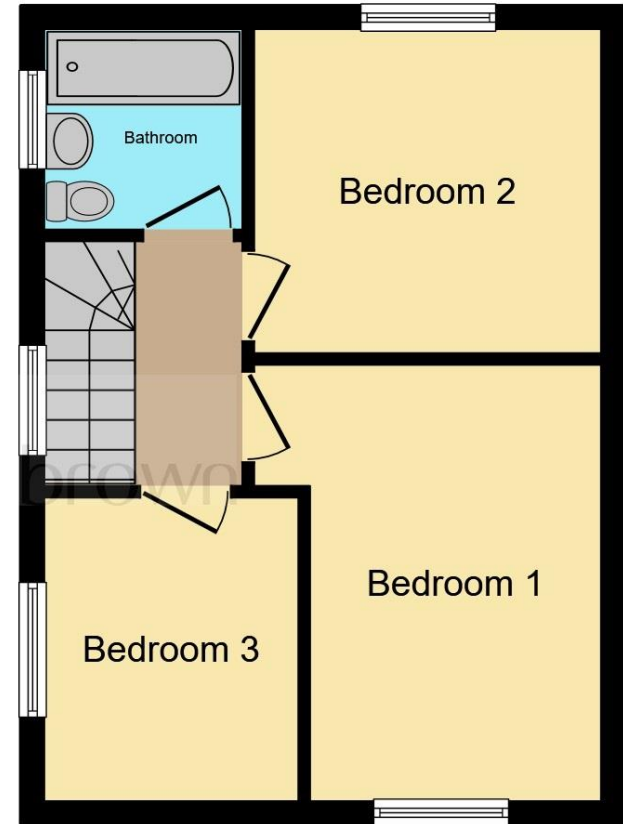

First Floor

Total floor area 66.9 m² (720 sq.ft.) approx

This floor plan is for illustrative purposes only. It is not drawn to scale. Any measurements, floor areas (including any total floor area), openings and orientation are approximate. No details are guaranteed, they cannot be relied upon for any purpose and they do not form part of any agreement. No liability is taken for any error, omission or misstatement. A party must rely upon its own inspection(s). Powered by www.focalagent.com



check out more properties at williamhbrown.co.uk



welcome to

Beechfield Road, Welwyn Garden City

- Three Bedrooms
- End of Terrace
- Driveway for Two Cars
- CHAIN FREE
- Close To Shops

Tenure: Freehold EPC Rating: C
Council Tax Band: C



guide price

£425,000



check out more properties at williamhbrown.co.uk



Property Ref:
WGN109132 - 0003

1. MONEY LAUNDERING REGULATIONS Intending purchasers will be asked to produce identification documentation at a later stage and we would ask for your co-operation in order that there is no delay in agreeing the sale. 2. These particulars do not constitute part or all of an offer or contract. 3. The measurements indicated are supplied for guidance only and as such must be considered incorrect. Potential buyers are advised to recheck measurements before committing to any expense. 4. We have not tested any apparatus, equipment, fixtures or services and it is in the buyers interest to check the working condition of any appliances. 5. Where an EPC, or a Home Report (Scotland only) is held for this property, it is available for inspection at the branch by appointment. If you require a printed version of a Home Report, you will need to pay a reasonable production charge reflecting printing and other costs. 6. We are not able to offer an opinion either written or verbal on the content of these reports and this must be obtained from your legal representative. 7. Whilst we take care in preparing these reports, a buyer should ensure that his/her legal representative confirms as soon as possible all matters relating to title including the extent and boundaries of the property and other important matters before exchange of contracts.

William H Brown is a trading name of Sequence (UK) Limited which is registered in England and Wales under company number 4268443, Registered Office is Cumbria House, 16-20 Hockliffe Street, Leighton Buzzard, Bedfordshire, LU7 1GN. VAT Registration Number is 500 2481 05.

william h brown



01707 324361



WelwynGardenCity@williamhbrown.co.uk



53 Wigmores North, WELWYN GARDEN CITY,
Hertfordshire, AL8 6PG



williamhbrown.co.uk

Please note the marker reflects the
postcode not the actual property