



Scholars Mews, Welwyn Garden City AL8 7JQ

welcome to

Scholars Mews, Welwyn Garden City

This beautifully presented three double bedroom terraced house is located in the desirable West Side of Welwyn Garden City, close to the town centre and mainline train station into London Kings Cross. The ground floor boasts cloakroom, study, large lounge, fully fitted kitchen/diner with doors to the rear garden and utility room. Upstairs offers master bedroom with walk in wardrobe and en-suite bathroom, two further double bedrooms with built in wardrobes and family bathroom. Externally there is off street parking, a garage and large rear garden.



Entrance Hall

Wooden flooring, under stairs storage.

Cloakroom

Tiled flooring, W/C, radiator, wash hand basin.

Study

14' 3" x 8' (4.34m x 2.44m)

Double glazed window to front, carpet, radiator.

Lounge

21' 2" x 15' 10" (6.45m x 4.83m)

Double glazed window to front, wooden flooring, gas fire place, radiator.

Kitchen/ Diner

17' 4" x 12' (5.28m x 3.66m)

Double glazed window to rear, tiled flooring, skylights, radiator, double oven, integrated dishwasher, electric hob, microwave, extractor fan.

Utility Room

8' 7" x 5' 8" (2.62m x 1.73m)

Back door to garden, work tops, sink.

Bedroom One

16' x 14' 9" (4.88m x 4.50m)

French doors to Juliet balcony, carpet, radiator, walk in wardrobe.

En-Suite

Double glazed window to rear, tiled flooring, wash hand basin, W/C, shower cubicle.

Bedroom Two

16' 8" x 12' 8" (5.08m x 3.86m)

Double glazed window to front and rear, radiator, built in wardrobe.

Bedroom Three

12' x 11' 6" (3.66m x 3.51m)

Double glazed window to front, carpet, radiator, built in wardrobe.

Bathroom

Tiled flooring, W/C, wash hand basin, bath, shower head, radiator.



GROUND FLOOR
983 sq.ft. (91.4 sq.m.) approx.

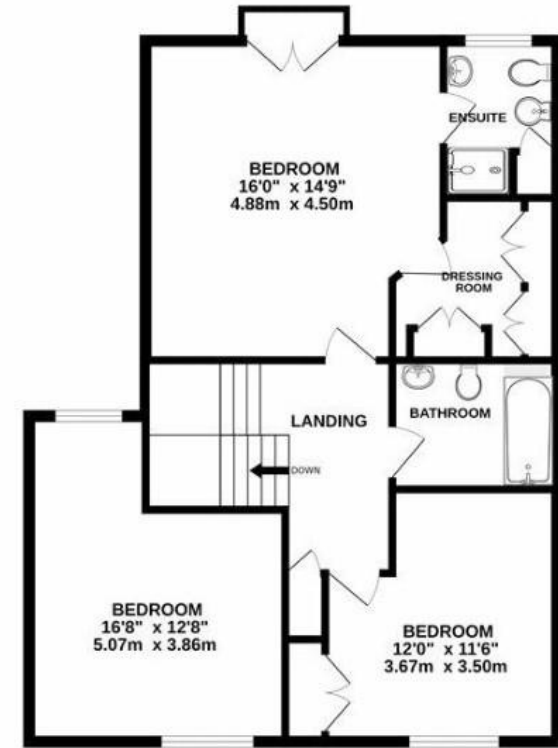

1ST FLOOR
801 sq.ft. (74.5 sq.m.) approx.

TOTAL FLOOR AREA: 1785 sq.ft. (165.8 sq.m.) approx.

This floorplan is for illustrative purposes only. The measurement and position of each element is approximate and must be checked on site.



check out more properties at williamhbrown.co.uk



welcome to

Scholars Mews, Welwyn Garden City

- Three Bedrooms
- Terraced
- Off Street Parking & Garage
- Two Bathrooms
- Downstairs Cloakroom & Utility Room

Tenure: Freehold EPC Rating: C

Offers in excess of

£855,000



check out more properties at williamhbrown.co.uk



Property Ref:
WGN108448 - 0004

1. MONEY LAUNDERING REGULATIONS Intending purchasers will be asked to produce identification documentation at a later stage and we would ask for your co-operation in order that there is no delay in agreeing the sale. 2. These particulars do not constitute part or all of an offer or contract. 3. The measurements indicated are supplied for guidance only and as such must be considered incorrect. Potential buyers are advised to recheck measurements before committing to any expense. 4. We have not tested any apparatus, equipment, fixtures or services and it is in the buyers interest to check the working condition of any appliances. 5. Where an EPC, or a Home Report (Scotland only) is held for this property, it is available for inspection at the branch by appointment. If you require a printed version of a Home Report, you will need to pay a reasonable production charge reflecting printing and other costs. 6. We are not able to offer an opinion either written or verbal on the content of these reports and this must be obtained from your legal representative. 7. Whilst we take care in preparing these reports, a buyer should ensure that his/her legal representative confirms as soon as possible all matters relating to title including the extent and boundaries of the property and other important matters before exchange of contracts.

William H Brown is a trading name of Sequence (UK) Limited which is registered in England and Wales under company number 4268443, Registered Office is Cumbria House, 16-20 Hockliffe Street, Leighton Buzzard, Bedfordshire, LU7 1GN. VAT Registration Number is 500 2481 05.

william h brown



01707 324361



WelwynGardenCity@williamhbrown.co.uk



53 Wigmores North, WELWYN GARDEN CITY,
Hertfordshire, AL8 6PG



williamhbrown.co.uk

Please note the marker reflects the
postcode not the actual property