



**Knightsfield, Welwyn Garden City, AL8 7JE**



## welcome to Knightsfield

A rarely available three bedroom family home located in the desirable AL8 area of Welwyn Garden City. The property benefits from easy access to both Welwyn Garden City and Welwyn North train stations with quick links into London as well as a double-storey extension, off street parking and a beautifully presented south facing garden. Internally the property comprises of entrance hall, spacious lounge diner with wood burner and modern fitted kitchen with ample storage space. Upstairs offers three spacious bedrooms and a well presented family bathroom with free standing bath. Further benefits include being within the catchment of some of the best local schools, a short walk to Shire Park and easy access to commuter links via the A414 and A1(M).



### Entrance Hall

Tiled floor, radiator, door to front

### Lounge

11' x 19' 7" (3.35m x 5.97m)

Porcelain tiled floor, double glazed to front, wood burning stove, TV point, wooden shutters, radiator

### Dining Room

13' 9" x 10' (4.19m x 3.05m)

Double glazed to side, porcelain tiles, patio doors with floor to ceiling wooden shutters

### Kitchen

16' 7" x 9' 8" (5.05m x 2.95m)

Fitted wall and base units, granite work surfaces, double glazed to rear, under cupboard lighting, integrated AEG oven, integrated Neff microwave, ceramic hob, stainless steel sink, integrated washing machine and dishwasher, integrated fridge freezer, under stairs storage, porcelain tiled floor

### Bedroom One

13' 8" x 16' 6" (4.17m x 5.03m)

Wooden walnut floor, quadruple wardrobe, double glazed to rear.

### Bedroom Two

11' x 11' 5" (3.35m x 3.48m)

Double glazed to front, laminate Amtico floor, radiator, fitted triple wardrobes with shelves, over stairs storage and cupboard,

### Bedroom Three

11' 5" x 6' 5" (3.48m x 1.96m)

Laminate Amtico floor, double glazed to front, over stairs storage cupboard, radiator

### Bathroom

Laminate Amtico floor, double glazed to rear, W/C, wash hand basin, freestanding bath, tiled walls



**Ground Floor**

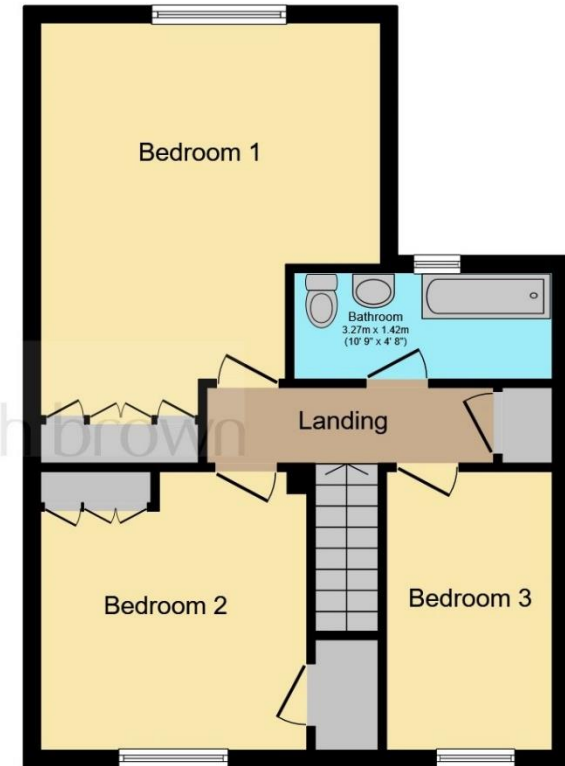

**First Floor**

This floorplan is for illustrative purposes only and is not drawn to scale. Measurements, floor-areas, openings and orientations are approximate. They should not be relied upon for any purpose and do not form any part of an agreement. No liability is taken for any error or mis-statement. All parties must rely on their own inspections.



**check out more properties at** [williamhbrown.co.uk](http://williamhbrown.co.uk)





## welcome to Knightsfield, Welwyn Garden City

- Off street parking
- Desirable location
- South facing garden
- Double storey extension
- Walking distance to mainline station

Tenure: Freehold EPC Rating: D

offers in excess of  
**£475,000**



Please note the marker reflects the  
postcode not the actual property

**check out more properties at** [williamhbrown.co.uk](http://williamhbrown.co.uk)  
**see all our properties on** [zoopla.co.uk](http://zoopla.co.uk) | [rightmove.co.uk](http://rightmove.co.uk) | [williamhbrown.co.uk](http://williamhbrown.co.uk)



Property Ref:  
WGN107379 - 0008

1. MONEY LAUNDERING REGULATIONS Intending purchasers will be asked to produce identification documentation at a later stage and we would ask for your co-operation in order that there is no delay in agreeing the sale. 2. These particulars do not constitute part or all of an offer or contract. 3. The measurements indicated are supplied for guidance only and as such must be considered incorrect. Potential buyers are advised to recheck measurements before committing to any expense. 4. We have not tested any apparatus, equipment, fixtures or services and it is in the buyers interest to check the working condition of any appliances. 5. Where an EPC, or a Home Report (Scotland only) is held for this property, it is available for inspection at the branch by appointment. If you require a printed version of a Home Report, you will need to pay a reasonable production charge reflecting printing and other costs. 6. We are not able to offer an opinion either written or verbal on the content of these reports and this must be obtained from your legal representative. 7. Whilst we take care in preparing these reports, a buyer should ensure that his/her legal representative confirms as soon as possible all matters relating to title including the extent and boundaries of the property and other important matters before exchange of contracts.

  
william h brown



**01707 324361**



[WelwynGardenCity@williamhbrown.co.uk](mailto:WelwynGardenCity@williamhbrown.co.uk)



53 Wigmores North, WELWYN GARDEN CITY,  
Hertfordshire, AL8 6PG



**[williamhbrown.co.uk](http://williamhbrown.co.uk)**