



Eastern Road, Watton Thetford IP25 6PA

welcome to

Eastern Road, Watton Thetford

> > **PARKING!** A three bedroom semi-detached family home, located within the market town of Watton. Boasting allocated parking, fully enclosed rear garden, ground floor w.c, modern kitchen & bathroom, spacious lounge, this immaculately presented property should not be missed!



The Accommodation

UPVC part glazed external entrance door opening to:

Entrance Hall

Tiled flooring, radiator, under-stairs storage, built-in storage cupboard, staircase rising to the first floor accommodation.

Cloakroom

Suite comprising low level w.c, hand wash basin, radiator, UPVC double glazed window to rear aspect.

Lounge

15' 4" x 11' (4.67m x 3.35m)

Laminate flooring, radiator, UPVC double glazed windows to front and side aspects.

Kitchen

12' x 10' 11" (3.66m x 3.33m)

A comprehensive range of wall and floor mounted fitted kitchen units with work surfaces over, built-in storage, plumbing for washing machine, electric double oven, gas-fired hob with extractor over, sink and drainer, radiator, tiled flooring, UPVC double glazed window to rear aspect, UPVC external entrance door opening to rear aspect.

First Floor Landing

Laminate flooring, airing cupboard, loft hatch access.

Bedroom 1

12' 2" x 10' 11" (3.71m x 3.33m)

Carpet flooring, radiator, built-in wardrobe, UPVC double glazed window to rear aspect.

Bedroom 2

12' 7" x 8' 8" (3.84m x 2.64m)

Carpet flooring, radiator, built-in wardrobe, UPVC double glazed window to front aspect.

Bedroom 3

9' 1" x 8' 10" (2.77m x 2.69m)

Carpet flooring, radiator, UPVC double glazed window to front aspect.

Family Bathroom

Part tiled suite comprising low level w.c, hand wash basin, shower cubicle, UPVC double glazed window to rear aspect.

Outside

To the front of the property, a walkway leads up to the front external entrance door from the allocated parking spaces. To the rear, a fully enclosed south-facing rear garden is mainly laid to artificial grass with patio seating area, beds, shed, and a side access perfect for additional storage.

Parking

Two allocated parking spaces, visitors parking.

Location

Watton has a range of amenities including a post office, supermarket, chemist, infant, junior and secondary schools. There is a weekly market with lots to offer. For golf enthusiasts, Richmond Park Golf Club has an 18-hole course, driving range and practice green. Furthermore, there is a sports centre which offers a fitness suite, all weather courts, badminton, squash and snooker facilities. Watton is surrounded by beautiful Norfolk countryside and woodlands including Thetford Forest and Wayland Wood.

The City of Norwich is approx. a 30 minute drive away providing a further wide range of shopping and leisure activities. The picturesque Norfolk coastal areas can be reached in under an hour also.

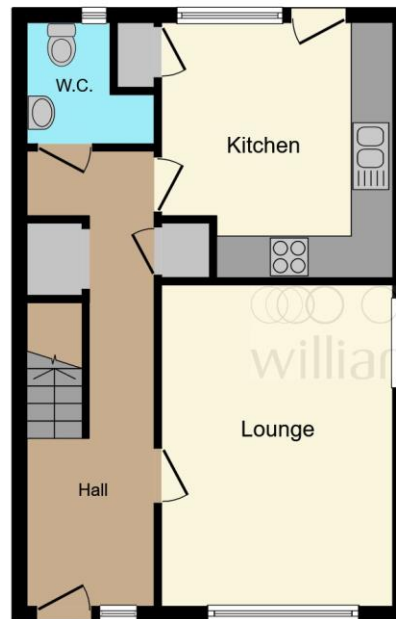

Ground Floor



First Floor

This floor plan is for illustrative purposes only. It is not drawn to scale. Any measurements, floor areas (including any total floor area), openings and orientation are approximate. No details are guaranteed, they cannot be relied upon for any purpose and they do not form part of any agreement. No liability is taken for any error, omission or misstatement. A party must rely upon its own inspection(s). Powered by www.focalagent.com



view this property online williamhbrown.co.uk/Property/WAT108523



welcome to

Eastern Road, Watton Thetford

- Three bedroom semi-detached family home
- Beautifully presented throughout
- UPVC double glazed windows, gas-fired central heating
- Allocated parking spaces
- Modern fitted kitchen & bathroom

Tenure: Freehold EPC Rating: B

offers in excess of

£220,000



Please note the marker reflects the postcode not the actual property

view this property online williamhbrown.co.uk/Property/WAT108523



Property Ref:
WAT108523 - 0003

1. MONEY LAUNDERING REGULATIONS Intending purchasers will be asked to produce identification documentation at a later stage and we would ask for your co-operation in order that there is no delay in agreeing the sale. 2. These particulars do not constitute part or all of an offer or contract. 3. The measurements indicated are supplied for guidance only and as such must be considered incorrect. Potential buyers are advised to recheck measurements before committing to any expense. 4. We have not tested any apparatus, equipment, fixtures or services and it is in the buyers interest to check the working condition of any appliances. 5. Where an EPC, or a Home Report (Scotland only) is held for this property, it is available for inspection at the branch by appointment. If you require a printed version of a Home Report, you will need to pay a reasonable production charge reflecting printing and other costs. 6. We are not able to offer an opinion either written or verbal on the content of these reports and this must be obtained from your legal representative. 7. Whilst we take care in preparing these reports, a buyer should ensure that his/her legal representative confirms as soon as possible all matters relating to title including the extent and boundaries of the property and other important matters before exchange of contracts.

William H Brown is a trading name of Sequence (UK) Limited which is registered in England and Wales under company number 4268443, Registered Office is Cumbria House, 16-20 Hockliffe Street, Leighton Buzzard, Bedfordshire, LU7 1GN. VAT Registration Number is 500 2481 05.



william h brown



01953 881951



Watton@williamhbrown.co.uk



9 High Street, Watton, THETFORD, Norfolk,
IP25 6AB



williamhbrown.co.uk