



Beaucourt Place, Walcott Norwich NR12 0PH

welcome to

Beaucourt Place, Walcott Norwich

Wonderful two-bedroom semi-detached coastal holiday home with a private garden and allocated parking, perfect for seaside getaways.



Description

****STUNNING SEA VIEWS**** Nestled in the picturesque coastal location of Walcott, this delightful two-bedroom semi-detached holiday home offers the perfect retreat. Featuring a well-maintained private garden for outdoor relaxation and dedicated parking for your convenience, this property combines comfort and practicality. Ideal for families, couples, or friends looking to enjoy serene seaside escapes, the home is just a stones throw from stunning beaches and local attractions. Don't miss the opportunity to experience coastal living at its finest. Call us to arrange your viewing!

Exterior

To the front, there is a gravel driveway for ample parking and access to the garden from the side of the property. There is a wonderful undisturbed view of the sea and access to the sea front.

To the rear, the garden is surrounded by fencing, laid to lawn, there is a patio area and storage for gas bottles.

Living/Kitchen/Dining Room

24' 10" Max x 14' 5" Max (7.57m Max x 4.39m Max)

The downstairs of the property has been made open plan allowing for plenty of natural light.

The living room has laminate flooring, a ceiling light, windows and doors to the front and side, stairs to the first floor and a beautiful sea view.

The kitchen has laminate flooring with matching base and wall units with worktop over. There is a sink and drainer, space and plumbing for a washing machine and electric oven, tiled splashback, windows to the rear and side and space for a dining table. There are double doors to the rear garden.

Cloakroom

The cloakroom has a window to the rear, a ceiling light, a toilet and sink along with a radiator.

First Floor

The hallway is carpeted and has a ceiling light.

Bedroom One

14' 7" Max x 11' 10" Max (4.45m Max x 3.61m Max)

The main bedroom has carpeted flooring, a radiator, windows and double doors to the front with a sea view and Juliet balcony along with access to the loft.

Bedroom Two

8' 3" x 11' 10" (2.51m x 3.61m)

The second bedroom has carpeted flooring, a window to the side, a sloped roof and a radiator.

Bathroom

The family bathroom has a toilet, sink and bath with a shower over. There is vinyl flooring and tiled walls along with a Velux skylight window, a radiator and spotlight ceiling lights.



Ground Floor

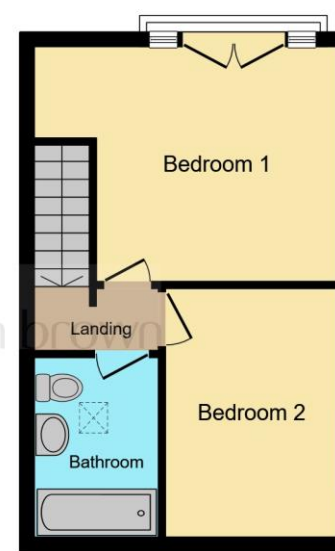

First Floor

This floor plan is for illustrative purposes only. It is not drawn to scale. Any measurements, floor areas (including any total floor area), openings and orientation are approximate. No details are guaranteed, they cannot be relied upon for any purpose and they do not form part of any agreement. No liability is taken for any error, omission or misstatement. A party must rely upon its own inspection(s). Powered by www.focalagent.com



view this property online williamhbrown.co.uk/Property/NWS108309



welcome to

Beaucourt Place, Walcott Norwich

- Seaside Holiday Home with Great Rental Income
- Two Bedrooms
- Open Plan Living Room, Kitchen and Dining Area
- Stunning Location with Wonderful Views
- Walcott NR12

Tenure: Freehold EPC Rating: D

£250,000



Please note the marker reflects the postcode not the actual property

view this property online williamhbrown.co.uk/Property/NWS108309



Property Ref:
NWS108309 - 0004

1. MONEY LAUNDERING REGULATIONS Intending purchasers will be asked to produce identification documentation at a later stage and we would ask for your co-operation in order that there is no delay in agreeing the sale. 2. These particulars do not constitute part or all of an offer or contract. 3. The measurements indicated are supplied for guidance only and as such must be considered incorrect. Potential buyers are advised to recheck measurements before committing to any expense. 4. We have not tested any apparatus, equipment, fixtures or services and it is in the buyers interest to check the working condition of any appliances. 5. Where an EPC, or a Home Report (Scotland only) is held for this property, it is available for inspection at the branch by appointment. If you require a printed version of a Home Report, you will need to pay a reasonable production charge reflecting printing and other costs. 6. We are not able to offer an opinion either written or verbal on the content of these reports and this must be obtained from your legal representative. 7. Whilst we take care in preparing these reports, a buyer should ensure that his/her legal representative confirms as soon as possible all matters relating to title including the extent and boundaries of the property and other important matters before exchange of contracts.

William H Brown is a trading name of Sequence (UK) Limited which is registered in England and Wales under company number 4268443, Registered Office is Cumbria House, 16-20 Hockliffe Street, Leighton Buzzard, Bedfordshire, LU7 1GN. VAT Registration Number is 500 2481 05.



william h brown



01692 581034



stalham@williamhbrown.co.uk



52 High Street, Stalham, NORWICH, Norfolk,
NR12 9AS



williamhbrown.co.uk