



**The Needles, Skegness PE25 1EQ**

**welcome to**

## **The Needles, Skegness**

**\*\*NO CHAIN\*\***

2 Bedroom Semi-Detached Bungalow - The Needles, Beacon Park

This delightful home offers comfortable and versatile accommodation comprising a spacious lounge, a modern kitchen/diner, two bedrooms, a study, and a family bathroom. Driveway to the front and rear garden with field views

### **Entrance Hall**

Loft hatch, storage cupboard and radiator.

### **Lounge**

11' 10" x 15' ( 3.61m x 4.57m )

Window to front elevation & radiator.

### **Study**

8' 5" x 6' 6" ( 2.57m x 1.98m )

Opaque window.

### **Kitchen**

10' 6" x 11' 10" ( 3.20m x 3.61m )

Wall, base & drawer units with worktop space over, inset sink & drainer, integrated oven, hob & extractor, radiator, window & door to rear elevation.

### **Bedroom One**

11' x 9' ( 3.35m x 2.74m )

Window & radiator.

### **Bedroom Two**

9' x 10' 6" ( 2.74m x 3.20m )

Window & radiator.

### **Bathroom**

Bath with shower over, Wc, sink, radiator & opaque window.

### **External**

The front of the property offers a gravelled front with a concrete driveway. There is a car port to the side of the property and the rear garden offers a low maintenance area with patio, shed and open field views.





***view this property online*** [williamhbrown.co.uk/Property/SKG109737](http://williamhbrown.co.uk/Property/SKG109737)



**welcome to**

## **The Needles, Skegness**

- Two bedroom semi-detached bungalow
- Sought after location of Beacon Park
- Spacious Lounge
- Separate Study/ Home Office
- Private rear garden with open field views

Tenure: Freehold EPC Rating: D

Council Tax Band: B

offers in the region of

**£175,000**

### **directions to this property:**

See Multi-map illustration

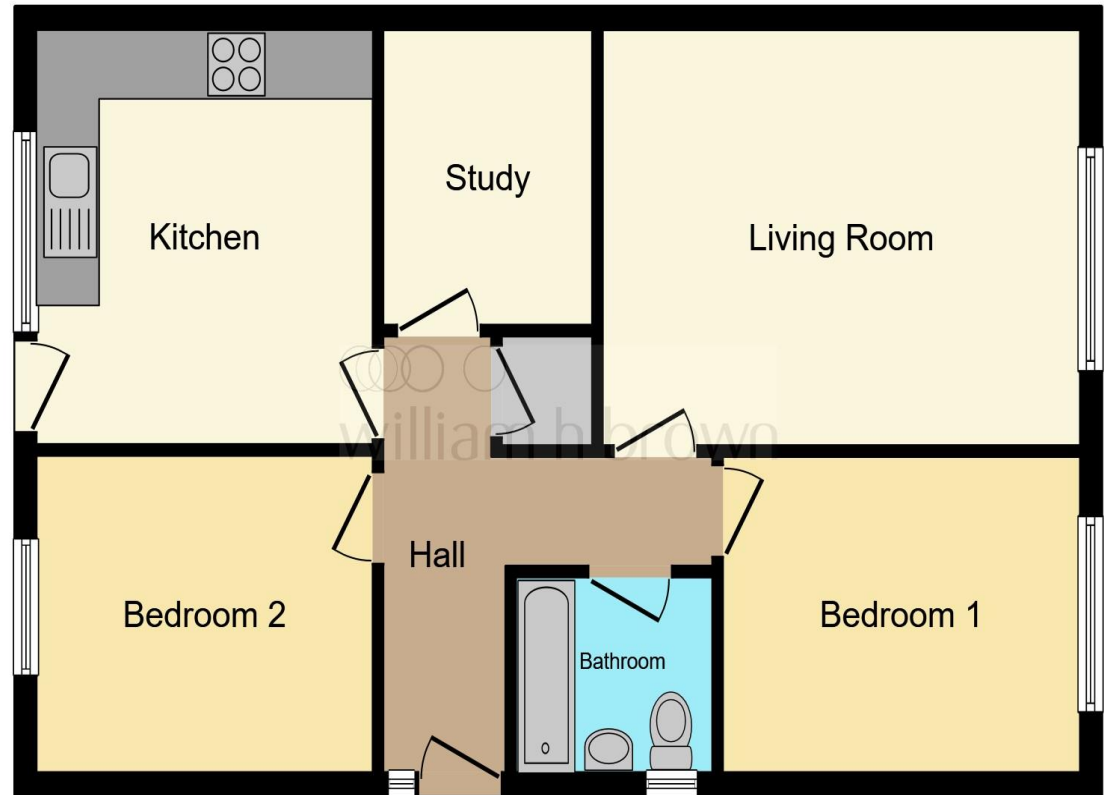

This floor plan is for illustrative purposes only. It is not drawn to scale. Any measurements, floor areas (including any total floor area), openings and orientation are approximate. No details are guaranteed, they cannot be relied upon for any purpose and they do not form part of any agreement. No liability is taken for any error, omission or misstatement. A party must rely upon its own inspection(s). Powered by [www.focalagent.com](http://www.focalagent.com)

**view this property online** [williamhbrown.co.uk/Property/SKG109737](http://williamhbrown.co.uk/Property/SKG109737)



Property Ref:  
SKG109737 - 0005

1. MONEY LAUNDERING REGULATIONS Intending purchasers will be asked to produce identification documentation at a later stage and we would ask for your co-operation in order that there is no delay in agreeing the sale. 2. These particulars do not constitute part or all of an offer or contract. 3. The measurements indicated are supplied for guidance only and as such must be considered incorrect. Potential buyers are advised to recheck measurements before committing to any expense. 4. We have not tested any apparatus, equipment, fixtures or services and it is in the buyers interest to check the working condition of any appliances. 5. Where an EPC, or a Home Report (Scotland only) is held for this property, it is available for inspection at the branch by appointment. If you require a printed version of a Home Report, you will need to pay a reasonable production charge reflecting printing and other costs. 6. We are not able to offer an opinion either written or verbal on the content of these reports and this must be obtained from your legal representative. 7. Whilst we take care in preparing these reports, a buyer should ensure that his/her legal representative confirms as soon as possible all matters relating to title including the extent and boundaries of the property and other important matters before exchange of contracts.

William H Brown is a trading name of Sequence (UK) Limited which is registered in England and Wales under company number 4268443, Registered Office is Cumbria House, 16-20 Hockliffe Street, Leighton Buzzard, Bedfordshire, LU7 1GN. VAT Registration Number is 500 2481 05.



**william h brown**



**01754 768311**



[Skegness@williamhbrown.co.uk](mailto:Skegness@williamhbrown.co.uk)



20 Roman Bank, SKEGNESS, Lincolnshire, PE25 2RU



**[williamhbrown.co.uk](http://williamhbrown.co.uk)**