



**Sycamore Lodge Wainfleet Bank, Wainfleet Skegness PE24 4ND**

**welcome to**

## **Sycamore Lodge Wainfleet Bank, Wainfleet Skegness**

1 Bedroom Residential Parkhome Located in Wainfleet. The property has 1 Double Bedroom, Shower Room, Kitchen & Lounge. Externally, the property has a driveway, decking to the side leading to entrance door as well as patio area with shed.

### **Lounge**

10' 6" x 9' 9" ( 3.20m x 2.97m )

From the entrance door you enter the lounge which has a window to the front and side and a radiator.

### **Kitchen**

9' 9" x 9' 4" ( 2.97m x 2.84m )

Comprises of wall, base and drawer units with worktop space over, a sink, radiator, window to two sides and a storage cupboard.

### **Inner Hall**

Has an additional entrance door and doors leading into:

### **Bedroom One**

9' 7" x 7' 1" ( 2.92m x 2.16m )

Has a window and a radiator.

### **Bathroom**

Consists of a walk in shower, WC, sink with vanity, a radiator and an opaque window.

### **External**

To the side of the property it has a decking area as well as parking to the side. To the rear the property has a shed.





***view this property online*** [williamhbrown.co.uk/Property/SKG108817](http://williamhbrown.co.uk/Property/SKG108817)



welcome to

## Sycamore Lodge Wainfleet Bank, Wainfleet Skegness

- RESIDENTIAL PARKHOME
- 1 BEDROOM
- PARKING
- SCENIC
- AMENITIES NEARBY

Tenure: Leasehold EPC Rating: Exempt

This is a Leasehold property with details as follows; Term of Lease 25 years from 20 Jan 2024. Should you require further information please contact the branch. Please Note additional fees could be incurred for items such as Leasehold packs.

# £25,000

### directions to this property:

See Multi-Map Illustration

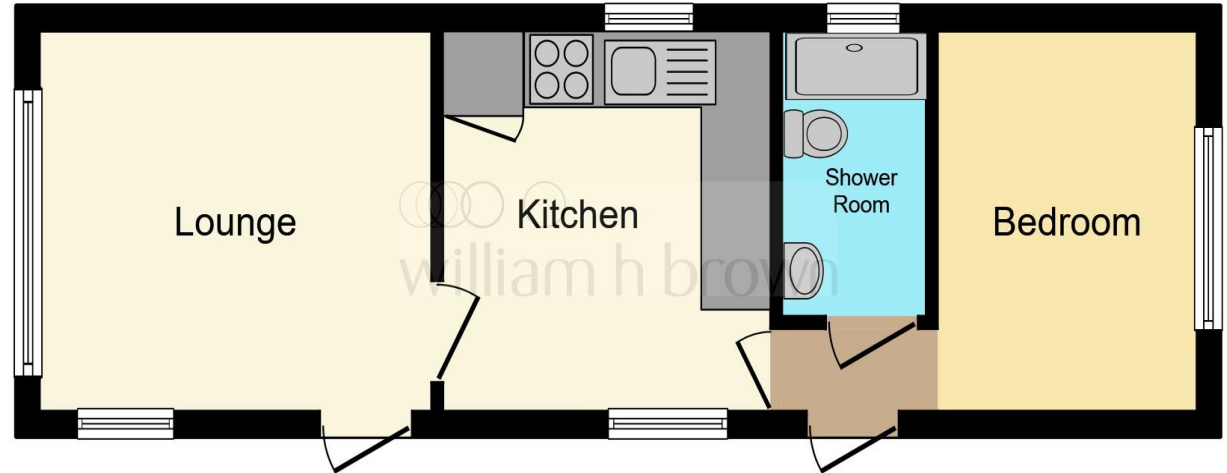

This floorplan is for illustrative purposes only and is not drawn to scale. Measurements, floor-areas, openings and orientations are approximate. They should not be relied upon for any purpose and do not form any part of an agreement. No liability is taken for any error or mis-statement. All parties must rely on their own inspections.

**view this property online** [williamhbrown.co.uk/Property/SKG108817](http://williamhbrown.co.uk/Property/SKG108817)



Property Ref:  
SKG108817 - 0004

1. MONEY LAUNDERING REGULATIONS Intending purchasers will be asked to produce identification documentation at a later stage and we would ask for your co-operation in order that there is no delay in agreeing the sale. 2. These particulars do not constitute part or all of an offer or contract. 3. The measurements indicated are supplied for guidance only and as such must be considered incorrect. Potential buyers are advised to recheck measurements before committing to any expense. 4. We have not tested any apparatus, equipment, fixtures or services and it is in the buyers interest to check the working condition of any appliances. 5. Where an EPC, or a Home Report (Scotland only) is held for this property, it is available for inspection at the branch by appointment. If you require a printed version of a Home Report, you will need to pay a reasonable production charge reflecting printing and other costs. 6. We are not able to offer an opinion either written or verbal on the content of these reports and this must be obtained from your legal representative. 7. Whilst we take care in preparing these reports, a buyer should ensure that his/her legal representative confirms as soon as possible all matters relating to title including the extent and boundaries of the property and other important matters before exchange of contracts.

William H Brown is a trading name of Sequence (UK) Limited which is registered in England and Wales under company number 4268443, Registered Office is Cumbria House, 16-20 Hockliffe Street, Leighton Buzzard, Bedfordshire, LU7 1GN. VAT Registration Number is 500 2481 05.

  
william h brown



**01754 768311**



[Skegness@williamhbrown.co.uk](mailto:Skegness@williamhbrown.co.uk)



20 Roman Bank, SKEGNESS, Lincolnshire, PE25  
2RU



[williamhbrown.co.uk](http://williamhbrown.co.uk)