

**Woodland
Edge**

**The Weaver
3 bedroom home**



Woodland Edge

The Weaver 3 bedroom home

Plot as drawn: 12, 38, 40, 75, 81, 83 and 89
Handed: 11, 39, 43, 50, 57, 74, 80, 82 and 88

78.97 sq.m / 850 sq.ft



GROUND FLOOR

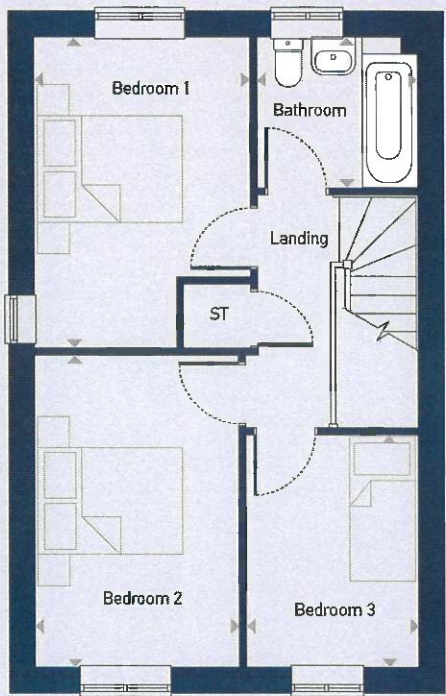

FIRST FLOOR

ST: Store WC: Water Closet

| DIMENSIONS | m | ft |
|----------------|---------------|---------------|
| Living | 4.93m x 3.09m | 16'2" x 10'1" |
| Kitchen/Dining | 4.90m x 3.86m | 16'1" x 12'7" |

| DIMENSIONS | m | ft |
|------------|---------------|--------------|
| Bedroom 1 | 3.98m x 2.80m | 13'1" x 9'2" |
| Bedroom 2 | 4.01m x 2.65m | 13'2" x 8'7" |
| Bedroom 3 | 3.00m x 2.22m | 9'8" x 7'3" |
| Bathroom | 2.06m x 1.94m | 6'8" x 6'4" |



01274 531233 | centralandnorthsales@placesforpeople.co.uk | placesforpeople.co.uk/woodland-edge
Bierley Lane, Bradford BD4 6DU

Please note: All layouts and floor plans, configurations, maps and information are intended for guidance only and accuracy of this information cannot be relied upon by prospective purchasers who must make their own enquiries to satisfy themselves by inspection or otherwise as to the correct detail. April 2025 06015-05.

KITCHENS

- Symphony fitted kitchen
- Laminate worktop
- Stainless steel single oven, gas hob & splashback
- Extractor hood
- Stainless steel sink with mixer tap
- Integrated Fridge Freezer
- Space for Washing machine and Dishwasher*

PLUMBING AND HEATING

- Gas fired combi boiler
- Dual zone thermostats

ELECTRICAL

- Low energy light fittings
- White sockets and switches
- TV aerial point to lounge with co-axial cable to loft
- Mains wired, with battery backup, smoke and heat detectors

INTERNAL FINISHES

- Walls and Ceilings painted in white
- Woodwork painted Satin White
- Carpets and Vinyl throughout

BATHROOMS

- White bathroom suite
- Thermostatic shower to ensuite*
- Porcelanosa tiles to walls

DOORS AND WINDOWS

- Black front door with multi-point locking
- Door numerals fitted
- PVC double glazed windows with white frame

EXTERNAL

- Solar panels
- Electric vehicle charging point
- Front garden landscaped**
- Rear garden turfed
- Outside tap
- External lighting to front



01274 531 233 | placesforpeople.co.uk/woodland-edge
Woodland Edge, Bierley Lane, Bradford, BD4 6DR

Please note: The specifications outlined above are for indication purposes only. There may be changes throughout the build process to specific brand, materials and appliances referred to in the specification. In such cases, an alternative of similar quality will be provided. Any alterations of the specification will be of equal to or greater value, and Places for People reserve the right to implement changes to the specification without warning. This information is for guidance only and does not form any part of any contract or constitute a warranty. Please consult your Sales Executive for further information.

*Subject to house type design and working drawings. **Please refer to landscape plan, Correct as of October 2024.

Key information about the home

There are variations of shared ownership models which have different features. The model of shared ownership may vary depending on:

- what rules were in place at the time the home was funded or planning permission granted
- where the home is located
- whether the home is for a specific group of people

The table below highlights the key features of common shared ownership schemes. The information in this document is for the new model shared ownership.

| Shared ownership model | Older model shared ownership | Standard model shared ownership | New model shared ownership |
|---------------------------------------|-----------------------------------------------------|--------------------------------------------------------------------------------|----------------------------------------------------|
| Minimum initial share | 25% | 25% | 10% |
| Lease length | Typically, leases were issued for 99 years from new | Leases are for a minimum of 99 years from new but typically at least 125 years | Leases will be for a minimum of 990 years from new |
| Initial repair period | No | No | Yes |
| Buying more shares - minimum purchase | 10% or 25% | 10% | 5% |
| 1% share purchase | No | No | Yes |
| Landlord's nomination period | 8 weeks or 12 weeks | 8 weeks | 4 weeks |

When you are looking for shared ownership homes, you should always check the Key Information Document to see which model covers that specific home.

When you buy a home through shared ownership, you enter into a shared ownership lease. The lease is a legal agreement between you (the 'leaseholder') and the landlord. It sets out the rights and responsibilities of both parties.

Before committing to buy a shared ownership property, you should take independent legal and financial advice.

This key information document is to help you decide if shared ownership is right for you. You should read this document carefully so that you understand what you are buying, and then keep it safe for future reference. This document 'Key information about the home' is a summary and you should consider the information in 'Summary of costs' and 'Guide to shared ownership' before making a decision.

This does not form part of the lease. You should carefully consider the information and the accompanying lease and discuss any issues with your legal adviser before signing the lease.

Failure to pay your rent, service charge, or mortgage could mean your home is at risk of repossession.

The costs in this document are the costs as at the date issued. These will increase (typically on an annual basis) and you should take financial advice on whether this will be sustainable for you.

Property Details

| Address | 17 Tweed Drive Bradford | | | | | | | | | | | | | | | | | | | | | | | | | | | | |
|----------------------------------------|---------------------------------------------------------------------------------------------------------------------------------------------------------------------------------------------------------------------------------------------------------------------------------------------------------------------------------------------------------------------------------------------------------------------------------------------------------------------------------------------------------------------------------------------------------------------------------------------------------------------------------------------------------------------------------------------------------------------------------------------------------------------------------------------------------------------------------------------------------------------------------------------------------------------------------------------------------------------------------------------------------------------------------------------------------------------------------------------------------------------------------------------------------|--------------|-------|----------------------|--------------|-----|------------|---------|-----|------------|---------|-----|------------|---------|-----|------------|---------|-----|-------------|---------|-----|-------------|---------|-----|-------------|---------|-----|-------------|---------|
| Property type | 3 Bedroom Semi | | | | | | | | | | | | | | | | | | | | | | | | | | | | |
| Scheme | Shared ownership | | | | | | | | | | | | | | | | | | | | | | | | | | | | |
| Full market value | £212,000 | | | | | | | | | | | | | | | | | | | | | | | | | | | | |
| Share Purchase Price and Rent Examples | <p>The share purchase price is calculated using the full market value and the percentage share purchased.</p> <p>If you buy a 25% share, the rent will be £364.38 a month.</p> <p>If you buy a larger share, you'll pay less rent.</p> <table border="1"> <thead> <tr> <th>Share</th><th>Share Purchase Price</th><th>Monthly rent</th></tr> </thead> <tbody> <tr> <td>10%</td><td>£21,200.00</td><td>£437.25</td></tr> <tr> <td>20%</td><td>£42,400.00</td><td>£388.67</td></tr> <tr> <td>30%</td><td>£63,600.00</td><td>£340.08</td></tr> <tr> <td>40%</td><td>£84,800.00</td><td>£291.50</td></tr> <tr> <td>50%</td><td>£106,000.00</td><td>£242.92</td></tr> <tr> <td>60%</td><td>£127,200.00</td><td>£194.33</td></tr> <tr> <td>70%</td><td>£148,400.00</td><td>£145.75</td></tr> <tr> <td>75%</td><td>£159,000.00</td><td>£121.46</td></tr> </tbody> </table> <p>The percentage share and rent amount will change depending on the amount you can afford. You'll receive a worked example after a financial assessment.</p> <p>Your annual rent is calculated as 2.75% of the remaining share of the full market value owned by the landlord.</p> | | Share | Share Purchase Price | Monthly rent | 10% | £21,200.00 | £437.25 | 20% | £42,400.00 | £388.67 | 30% | £63,600.00 | £340.08 | 40% | £84,800.00 | £291.50 | 50% | £106,000.00 | £242.92 | 60% | £127,200.00 | £194.33 | 70% | £148,400.00 | £145.75 | 75% | £159,000.00 | £121.46 |
| Share | Share Purchase Price | Monthly rent | | | | | | | | | | | | | | | | | | | | | | | | | | | |
| 10% | £21,200.00 | £437.25 | | | | | | | | | | | | | | | | | | | | | | | | | | | |
| 20% | £42,400.00 | £388.67 | | | | | | | | | | | | | | | | | | | | | | | | | | | |
| 30% | £63,600.00 | £340.08 | | | | | | | | | | | | | | | | | | | | | | | | | | | |
| 40% | £84,800.00 | £291.50 | | | | | | | | | | | | | | | | | | | | | | | | | | | |
| 50% | £106,000.00 | £242.92 | | | | | | | | | | | | | | | | | | | | | | | | | | | |
| 60% | £127,200.00 | £194.33 | | | | | | | | | | | | | | | | | | | | | | | | | | | |
| 70% | £148,400.00 | £145.75 | | | | | | | | | | | | | | | | | | | | | | | | | | | |
| 75% | £159,000.00 | £121.46 | | | | | | | | | | | | | | | | | | | | | | | | | | | |

Monthly payment
to the landlord

In addition to the rent above, the monthly payment to the landlord includes:

| | |
|----------------------|--------|
| Service charge | £0.00 |
| Estate charge | £18.52 |
| Buildings insurance | £27.15 |
| Management fee | £10.67 |
| Reserve fund payment | £0.00 |

Total monthly payment *excluding rent* £56.34

Reservation fee

£ 500

You'll need to pay a reservation fee to secure your home. When you pay the fee, no one else will be able to reserve the home.

The reservation fee secures the home for 70 days. If you buy the home, the fee will be taken off the final amount you pay on completion. If you do not buy the home, the fee is partially refundable.

Eligibility and requirements

Eligibility

You can apply to buy the home if both of the following apply:

your household income is £80,000/£90,000 or less
you cannot afford all of the deposit and mortgage payments to buy a home that meets your needs

One of the following must also be true:

you're a first-time buyer
you used to own a home but cannot afford to buy one now
you're forming a new household - for example, after a relationship breakdown
you're an existing shared owner, and you want to move
you own a home and want to move but cannot afford to buy a new home for your needs

If you own a home, you must have completed the sale of the home on or before the date you complete your shared ownership purchase.

As part of your application, your finances and credit history will be assessed to ensure that you can afford and sustain the rental and mortgage payments.

Tenure

Leasehold

Lease type

Shared ownership House lease

Lease term

999 years

For more information, see section 2.5, 'Lease extensions', in the 'Key information about shared ownership' document.

Shared ownership details

| | |
|---------------------------|----------------------------------------------------------------------------------------------------------------------------------------------------------------------------------------------------------------------------------------------------------------------------------------------------------------------------------------------------------------------------------------------------|
| Maximum share you can own | You can buy up to 100% of your home. |
| Transfer of freehold | At 100% ownership, the freehold will transfer to you |
| Landlord | <p>Places for People Homes Limited 305 Gray's Inn Road, London WC1X 8QR</p> <p>Under a shared ownership lease, you pay for a percentage share of the market value of a home. You enter into a lease agreement with the landlord, and agree to pay rent to the landlord on the remaining share.</p> |
| Rent review | <p>Your rent will be reviewed each year by a set formula using the for the previous 12 months [plus 1%]</p> <p>For more information, see the Rent Review section in the 'Summary of Costs' document which includes an example of how rent could increase over a 5 year period. A worked example demonstrating how the rent is calculated at review is also set out in Appendix 2 of the lease.</p> |

Other details

Initial repair period

Up to £500 a year for the first 10 years to help with essential repairs. For more information, see section 5, 'Maintaining and living in the home', in the 'Key information about shared ownership' document.

Landlord's first option to buy

When you give the landlord notice that you intend to sell your share in your home, the landlord has 4 weeks to find a buyer. (The landlord may offer to buy back your share, but only in exceptional circumstances and if they have funds available.) If they do not find a buyer within 4 weeks, you can sell your share yourself on the open market. For example, through an estate agent.

Pets

You can keep pets at the home but must obtain the landlords written permission, please consult your conveyancer

Subletting

Subletting

You can rent out a room in the home at any time, but you must live there at the same time.

You cannot sublet (rent out) your entire home unless either:

- **you own a 100% share**
- **you have your landlord's permission, which they will only give in exceptional circumstances**

If you're a serving member of the armed forces, and you're required to serve away from the area where you live for a fixed period, you may sublet the entire home subject to the landlord's permission.