



Kite Place, Brympton, Yeovil, BA22 8BS

welcome to

Kite Place, Brympton, Yeovil

A three bedroom semi detached family home, offered for sale with no onward chain, situated within the desirable Brympton Development. The accommodation is well presented throughout and offered a wealth of space and natural light. Externally benefitting allocated parking & enclosed rear garden.



Entrance

Double glazed door to the front, opening into:

Entrance Hall

Stairs rising to the first floor with understairs storage cupboard. Radiator. Door opening into:

Downstairs Cloakroom

Double glazed window to the front. Suite comprising wash hand basin with tiled splashback and WC. Extractor fan. Radiator.

Lounge

16' 10" x 9' 4" (5.13m x 2.84m)

A lovely light room with double glazed windows to the front and rear. Double glazed door to the rear opening to the garden. Sky Connection. Two radiators,

Fitted Kitchen

16' 4" x 9' 9" (4.98m x 2.97m)

Two double glazed windows to the rear. A range of fitted wall, base and drawer units with work surface over. Single bowl stainless steel sink and drainer with mixer tap. Integrated gas hob with cooker hood over and electric oven below. Plumbing for washing machine and dishwasher. Space for fridge/freezer. Wall mounted central heating boiler. Space for dining table and chairs. Radiator.

First Floor Landing

Double glazed window to the front. Airing cupboard.

Bedroom One

12' 2" max x 9' 6" max (3.71m max x 2.90m max)

Double glazed window to the rear overlooking the garden. Radiator.

Bedroom Two

13' 8" max x 8' 1" + door recess (4.17m max x 2.46m + door recess)

Double glazed window to the rear overlooking the garden. Access to the loft space. Radiator.

Bedroom Three

8' 8" x 8' 5" (2.64m x 2.57m)

Double glazed window to the front. Radiator.

Bathroom

Double glazed window to the front. Suite comprising enclosed bath with mixer tap and shower over, wash hand basin and WC. Radiator.

Parking

There are two allocated parking space to the front of the property.

Rear Garden

A fully enclosed rear garden with a good size decking area abutting the property, providing an ideal seating area to enjoy the summer sunshine. The garden is then laid to lawn with garden shed and gated side access.



Ground Floor

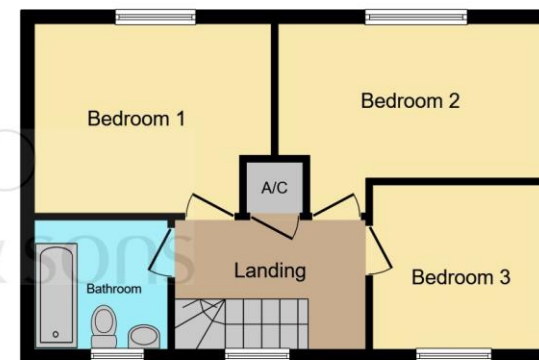

First Floor

Total floor area 82.4 sq.m. (887 sq.ft.) approx

This floorplan is for illustrative purposes only and is not drawn to scale. Measurements, floor-areas, openings and orientations are approximate. They should not be relied upon for any purpose and do not form any part of an agreement. No liability is taken for any error or mis-statement. All parties must rely on their own inspections.



view this property online fox-and-sons.co.uk/Property/YEO107342



welcome to

Kite Place, Brympton, Yeovil

- Semi Detached Family Home
- Three Bedrooms
- Allocated Parking for Two Cars
- Desirable Development
- NO ONWARD CHAIN

Tenure: Leasehold EPC Rating: C

£240,000



Please note the marker reflects the postcode not the actual property

view this property online fox-and-sons.co.uk/Property/YEO107342

This is a Leasehold property. We are awaiting further details about the Term of the lease. For further information please contact the branch. Please note additional fees could be incurred for items such as Leasehold packs.



Property Ref:
YEO107342 - 0003

1. MONEY LAUNDERING REGULATIONS Intending purchasers will be asked to produce identification documentation at a later stage and we would ask for your co-operation in order that there is no delay in agreeing the sale. 2. These particulars do not constitute part or all of an offer or contract. 3. The measurements indicated are supplied for guidance only and as such must be considered incorrect. Potential buyers are advised to recheck measurements before committing to any expense. 4. We have not tested any apparatus, equipment, fixtures or services and it is in the buyers interest to check the working condition of any appliances. 5. Where an EPC, or a Home Report (Scotland only) is held for this property, it is available for inspection at the branch by appointment. If you require a printed version of a Home Report, you will need to pay a reasonable production charge reflecting printing and other costs. 6. We are not able to offer an opinion either written or verbal on the content of these reports and this must be obtained from your legal representative. 7. Whilst we take care in preparing these reports, a buyer should ensure that his/her legal representative confirms as soon as possible all matters relating to title including the extent and boundaries of the property and other important matters before exchange of contracts.

Fox & Sons is a trading name of Sequence (UK) Limited which is registered in England and Wales under company number 4268443, Registered Office is Cumbria House, 16-20 Hockliffe Street, Leighton Buzzard, Bedfordshire, LU7 1GN. VAT Registration Number is 500 2481 05.

fox & sons



01935 412100



Yeovil@fox-and-sons.co.uk



14 Princes Street, YEOVIL, Somerset, BA20 1EW



fox-and-sons.co.uk