



Flat 3, Station House, Market Street, Watchet TA23 0AW

welcome to

Flat 3, Station House, Market Street, Watchet

Forming part of the historic old station house is this two bedroom ground floor flat situated within the heart of Watchet town centre & close to the harbour. The property benefits from period features, open plan sitting room/kitchen, two bedrooms, bathroom.



Stable Front Door

Leading to

Entrance Lobby

With tiled floor, door to the bathroom, double doors to the lounge.

Sitting Room/ Kitchen

21' 10" x 11' 9" (6.65m x 3.58m)

Sitting Room Area with fitted carpet, exposed beams, doors to

Kitchen Area with single glazed window to the rear, tiled floor, base units, tiled worktop surfaces, space for cooker, space & plumbing for washing machine, space for fridge, Belfast sink unit.

Bedroom One

11' 2" x 9' 2" (3.40m x 2.79m)

Single glazed window to the front, fitted carpet, exposed beams.

Bedroom Two

Irregular Shaped Room 11' 3" x 9' 10" (3.43m x 3.00m)

Single glazed window to the front, fitted carpet, built in cupboard housing gas fired boiler serving the hot water system.

Bathroom

Single glazed window to the front, pedestal wash hand basin, low level WC, a small panelled bath with Victorian style mixer taps/shower attached over, tiled splashback, tiled floor, extractor unit.

Location

Watchet is an historic harbour town with a modern marina, a good selection of shops and amenities, a surgery, nursery facilities and a primary school. The town is ideally placed between The Quantock Hills, Exmoor and The Bristol Channel, with easy access to the A39, Bridgwater and the M5 (North) and to the A358, Taunton, the A303 and the M5 (South). The near-by village of Williton has further good facilities including a middle school. Minehead, 15 minutes away, has a wider range of amenities, including a hospital and West Somerset College.

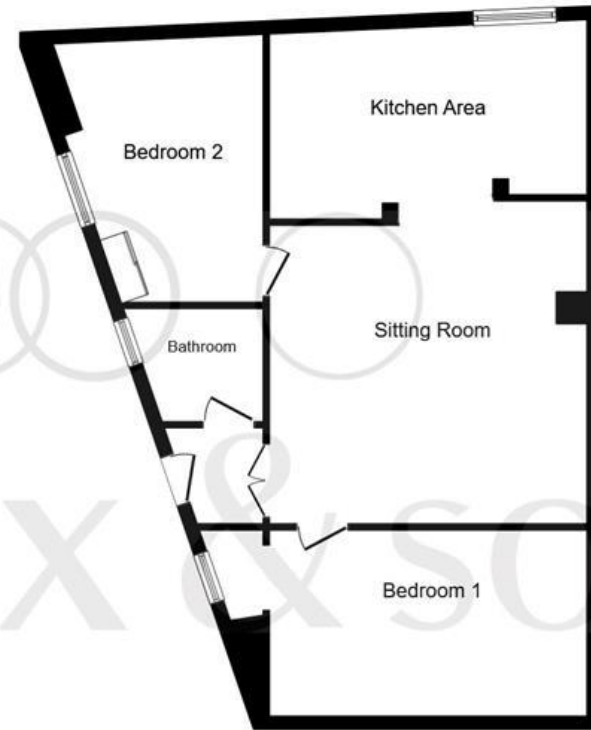

Floor Plan



view this property online fox-and-sons.co.uk/Property/MIH106680



welcome to

Flat 3, Station House, Market Street, Watchet

- Situated within the Heart of Watchet Town Centre
- Ground Floor Flat - Two Bedrooms
- Period Features - Open Plan Sitting Room/Kitchen
- Bathroom - Close to Watchet Harbour
- Council Tax Band - A

Tenure: Leasehold EPC Rating: F

£110,000



Please note the marker reflects the postcode not the actual property

view this property online fox-and-sons.co.uk/Property/MIH106680

This is a Leasehold property. We are awaiting further details about the Term of the lease. For further information please contact the branch. Please note additional fees could be incurred for items such as Leasehold packs.



Property Ref:
MIH106680 - 0004

1. MONEY LAUNDERING REGULATIONS Intending purchasers will be asked to produce identification documentation at a later stage and we would ask for your co-operation in order that there is no delay in agreeing the sale. 2. These particulars do not constitute part or all of an offer or contract. 3. The measurements indicated are supplied for guidance only and as such must be considered incorrect. Potential buyers are advised to recheck measurements before committing to any expense. 4. We have not tested any apparatus, equipment, fixtures or services and it is in the buyers interest to check the working condition of any appliances. 5. Where an EPC, or a Home Report (Scotland only) is held for this property, it is available for inspection at the branch by appointment. If you require a printed version of a Home Report, you will need to pay a reasonable production charge reflecting printing and other costs. 6. We are not able to offer an opinion either written or verbal on the content of these reports and this must be obtained from your legal representative. 7. Whilst we take care in preparing these reports, a buyer should ensure that his/her legal representative confirms as soon as possible all matters relating to title including the extent and boundaries of the property and other important matters before exchange of contracts.

Fox & Sons is a trading name of Sequence (UK) Limited which is registered in England and Wales under company number 4268443, Registered Office is Cumbria House, 16-20 Hockliffe Street, Leighton Buzzard, Bedfordshire, LU7 1GN. VAT Registration Number is 500 2481 05.

fox & sons



01643 702281



minehead@fox-and-sons.co.uk



13 The Parade, MINEHEAD, Somerset, TA24 5NL



fox-and-sons.co.uk