



Fuchsia Way, Rushden NN10 0XF

welcome to

Fuchsia Way, Rushden

This Four bedroom Detached home and on the ground floor is; entrance hall, cloakroom, lounge, kitchen and utility room. On the first floor are the Four bedrooms, two with en suite and the family bathroom. The rear garden is laid with lawn has a patio providing a seating area and gated access.



Entrance Hall

Entered via double glazed door to the front aspect, stairs rising to the first floor landing, storage cupboard, radiator and doors to all rooms.

Cloakroom

Double glazed obscure window to the front aspect, WC, wash hand basin, tiling and radiator.

Lounge

25' 1" x 13' 1" (7.65m x 3.99m)

Two double glazed windows to the rear aspect, double glazed French doors to the rear aspect, fire place with electric fire, three radiators, media wall and telephone point.

Kitchen

10' 9" x 8' 9" (3.28m x 2.67m)

Fitted kitchen comprising a range of matching wall and base units with work surfaces over, sink and drainer, splash backs, electric oven and gas hob with cooker hood over, integrated dishwasher, double glazed window to the front aspect and radiator.

Utility Room

8' 10" x 5' 3" (2.69m x 1.60m)

Matching base units with work surfaces over, a stainless steel sink and drainer, splash backs, plumbing for washing machine, central heating boiler and double glazed door to the side aspect.

First Floor Landing

Double glazed window to the side aspect, stairs rising from the entrance hall, airing cupboard, access to loft space partially boarded, radiator, doors to the bedrooms and bathroom.

Bedroom One

13' 2" x 9' 3" (4.01m x 2.82m)

Two double glazed window to the front aspect, built in wardrobe, radiator and door to en suite.

En Suite

WC, wash hand basin with vanity unit, shower cubicle, extractor fan and radiator.

Bedroom Two

9' 7" x 8' 7" plus recess (2.92m x 2.62m plus recess)

Double glazed window to the rear aspect, built in wardrobe, radiator and door to en suite.

En Suite

Double glazed obscure window to the side aspect, WC, wash hand basin, shower cubicle and radiator.

Bedroom Three

8' 2" x 7' 6" (2.49m x 2.29m)

Double glazed window to the rear aspect, built in wardrobe and radiator.

Bedroom Four

9' 11" x 6' 11" (3.02m x 2.11m)

Double glazed window to the rear aspect and radiator.

Bathroom

Double glazed window to the side aspect, WC, wash hand basin, bath, extractor fan, part tiling and radiator.

Externally

Front

Driveway providing off road parking for several cars.

Rear Garden

Mainly laid to lawn, patio providing a seating area, outside tap, power sockets and gated side access.



view this property online williamhbrown.co.uk/Property/RSD109289



welcome to

Fuchsia Way, Rushden

- DETACHED HOME
- FOUR BEDROOMS
- TWO EN SUITES
- OFF ROAD PARKING
- UTILITY ROOM

Tenure: Freehold EPC Rating: C

offers over

£325,000

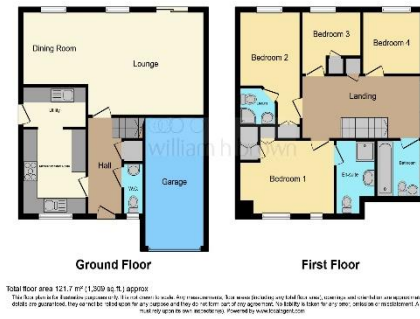

view this property online [williambrown.co.uk/Property/RSD109289](https://www.williambrown.co.uk/Property/RSD109289)

Please note the marker reflects the postcode not the actual property



Property Ref:
RSD109289 - 0007

1. MONEY LAUNDERING REGULATIONS Intending purchasers will be asked to produce identification documentation at a later stage and we would ask for your co-operation in order that there is no delay in agreeing the sale. 2. These particulars do not constitute part or all of an offer or contract. 3. The measurements indicated are supplied for guidance only and as such must be considered incorrect. Potential buyers are advised to recheck measurements before committing to any expense. 4. We have not tested any apparatus, equipment, fixtures or services and it is in the buyers interest to check the working condition of any appliances. 5. Where an EPC, or a Home Report (Scotland only) is held for this property, it is available for inspection at the branch by appointment. If you require a printed version of a Home Report, you will need to pay a reasonable production charge reflecting printing and other costs. 6. We are not able to offer an opinion either written or verbal on the content of these reports and this must be obtained from your legal representative. 7. Whilst we take care in preparing these reports, a buyer should ensure that his/her legal representative confirms as soon as possible all matters relating to title including the extent and boundaries of the property and other important matters before exchange of contracts.



william h brown



01933 410717



rushden@williambrown.co.uk



52 High Street, RUSHDEN, Northamptonshire,
NN10 0PJ



[williambrown.co.uk](https://www.williambrown.co.uk)

William H Brown is a trading name of Sequence (UK) Limited which is registered in England and Wales under company number 4268443, Registered Office is Cumbria House, 16-20 Hockliffe Street, Leighton Buzzard, Bedfordshire, LU7 1GN. VAT Registration Number is 500 2481 05.