



Church Close, West Chinnock, Crewkerne TA18 7PZ

welcome to

Church Close, West Chinnock, Crewkerne

For sale with the benefit of NO ONWARD CHAIN and situated in the popular village of West Chinnock, this Grade II Listed end of terrace character cottage offers accommodation briefly comprising lounge/diner with log burner, kitchen, two bedrooms and bathroom. Outside there is a paved front garden.



Ground Floor

Lounge / Diner

13' 4" max x 11' 11" (4.06m max x 3.63m)

Single glazed door to front. Front aspect double glazed window with window seat. Log burner. Fitted carpet. Electric heater.

Kitchen

13' 3" max x 7' max (4.04m max x 2.13m max)

Rear aspect single glazed window. Fitted base and wall units. Work surfaces incorporating a sink and drainer. Tiled splashbacks. Electric oven and hob. Space and plumbing for washing machine. Under stairs cupboard. Stairs rising to first floor.

First Floor

Landing

Cupboard. Access to loft. Fitted carpet. Electric heater.

Bedroom 1

9' 8" max x 9' 2" (2.95m max x 2.79m)

Rear aspect single glazed window. Fitted wardrobe. Fitted carpet. Electric heater.

Bedroom 2

10' 2" x 8' 2" max (3.10m x 2.49m max)

Front aspect single glazed window. Fitted wardrobe. Fitted carpet. Electric heater.

Bathroom

Front aspect single glazed window. Fitted with a suite comprising a panelled bath with mixer taps, wash hand basin and WC. Part tiled. Shaver point. Fitted carpet. Towel heater.

Outside

The enclosed front garden is laid to paving and planted with trees and shrubs. There is a garden room and bin store/shed.

Garden Room

12' 3" x 7' 1" (3.73m x 2.16m)

Front aspect single glazed window. Door to front.

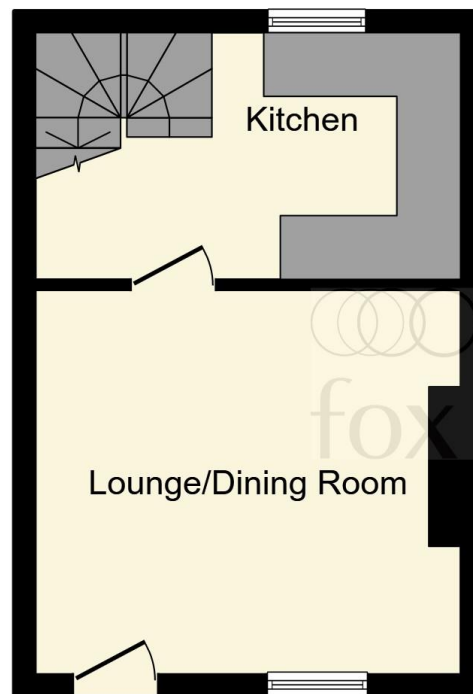

Ground Floor

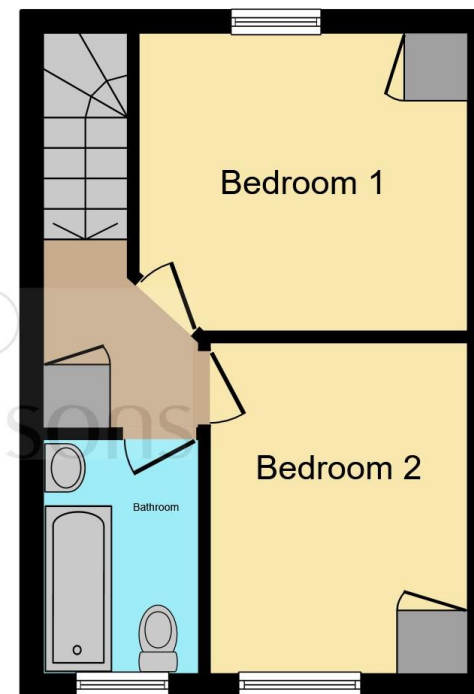

First Floor

This floor plan is for illustrative purposes only. It is not drawn to scale. Any measurements, floor areas (including any total floor area), openings and orientation are approximate. No details are guaranteed, they cannot be relied upon for any purpose and they do not form part of any agreement. No liability is taken for any error, omission or misstatement. A party must rely upon its own inspection(s). Powered by www.focalagent.com



view this property online fox-and-sons.co.uk/Property/CRK106207



welcome to

Church Close, West Chinnock, Crewkerne

- End of Terrace Cottage
- Two Bedrooms
- Grade II Listed
- Popular Village Location
- NO ONWARD CHAIN!
- Council Tax Band: C

Tenure: Freehold EPC Rating: Exempt

£200,000



Please note the marker reflects the postcode not the actual property

view this property online fox-and-sons.co.uk/Property/CRK106207



Property Ref:
CRK106207 - 0002

1. MONEY LAUNDERING REGULATIONS Intending purchasers will be asked to produce identification documentation at a later stage and we would ask for your co-operation in order that there is no delay in agreeing the sale. 2. These particulars do not constitute part or all of an offer or contract. 3. The measurements indicated are supplied for guidance only and as such must be considered incorrect. Potential buyers are advised to recheck measurements before committing to any expense. 4. We have not tested any apparatus, equipment, fixtures or services and it is in the buyers interest to check the working condition of any appliances. 5. Where an EPC, or a Home Report (Scotland only) is held for this property, it is available for inspection at the branch by appointment. If you require a printed version of a Home Report, you will need to pay a reasonable production charge reflecting printing and other costs. 6. We are not able to offer an opinion either written or verbal on the content of these reports and this must be obtained from your legal representative. 7. Whilst we take care in preparing these reports, a buyer should ensure that his/her legal representative confirms as soon as possible all matters relating to title including the extent and boundaries of the property and other important matters before exchange of contracts.

Fox & Sons is a trading name of Sequence (UK) Limited which is registered in England and Wales under company number 4268443, Registered Office is Cumbria House, 16-20 Hockliffe Street, Leighton Buzzard, Bedfordshire, LU7 1GN. VAT Registration Number is 500 2481 05.

fox & sons



01460 73421



Crewkerne@fox-and-sons.co.uk



1-3 Market Square, CREWKERNE, Somerset,
TA18 7LE



fox-and-sons.co.uk