



Eldridge House Chard Road, Axminster EX13 5GB

welcome to

Eldridge House Chard Road, Axminster

Fox & Sons are delighted to bring to the market this lovely three bedroom end terrace home, conveniently located on the outskirts of the historic market town of Axminster.

Entrance Hallway

Entered via Everest uPVC door with double glazed insert panel, stairs rising to first floor, radiator, ceiling light point

Lounge

14' 6" max x 14' 5" max (4.42m max x 4.39m max)
uPVC double glazed window to front aspect, understairs storage cupboard, radiators, ceiling light point

Kitchen

13' 2" x 11' 1" (4.01m x 3.38m)
uPVC double glazed window to rear aspect, range of matching wall and base units with worktop over and tiled splashback, integrated fridge, integrated electric oven with gas hob and cooker hood over, 1.5 Belfast drainer sink, space and plumbing for washing machine, dishwasher and fridge/freezer, island unit, radiator, ceiling light point

Conservatory

9' 6" x 14' 3" (2.90m x 4.34m)
uPVC double glazed floor to ceiling windows on three sides, double doors leading out to garden, electric radiator, wall light point

Outer Back Porch

Doors lading to conservatory and downstairs cloakroom, radiator, ceiling light point

Downstairs Cloakroom

uPVC opaque double glazed window to side aspect, hand wash basin, low level WC, part tiled walls, radiator, ceiling light point

Landing

uPVC double glazed window to side aspect at top of stairs, doors leading to subsequent first floor rooms,

airing cupboard housing hot water tank, built in storage cupboard, loft hatch, ceiling light point

Master Bedroom

14' 2" max x 10' 4" max (4.32m max x 3.15m max)
uPVC double glazed window to rear aspect, built in wardrobe, radiator, ceiling light point

En-Suite

uPVC opaque double glazed window to rear aspect, shower cubicle, hand wash basin, low level WC, part tiled walls, ceiling light point

Bedroom 2

10' 3" x 9' 3" (3.12m x 2.82m)
uPVC double glazed window to front aspect with views to the countryside beyond, radiator, ceiling light point

Bedroom 3

6' 6" max x 9' 8" max (1.98m max x 2.95m max)
uPVC double glazed window to front aspect, built in over stairs cupboard, radiator, ceiling light point

Bathroom

Panel bath with shower over, hand wash basin, low level WC, part tiled walls, radiator, ceiling light point

Rear Garden

Timber fence enclosed rear garden, predominantly laid to lawn with established trees and plants, side gravel area leading to shed, paved path leading to rear gate, water supply, outside light

Parking

One allocated off road parking space under car port to the rear of the property





view this property online fox-and-sons.co.uk/Property/AXM104728



welcome to

Eldridge House Chard Road, Axminster

- THREE BEDROOM END TERRACED HOME
- PRETTY REAR ENCLOSED GARDEN
- COUNCIL TAX BAND B
- CONSERVATORY
- MASTER BEDROOM WITH EN-SUITE

Tenure: Freehold EPC Rating: C

Council Tax Band: B

£240,000

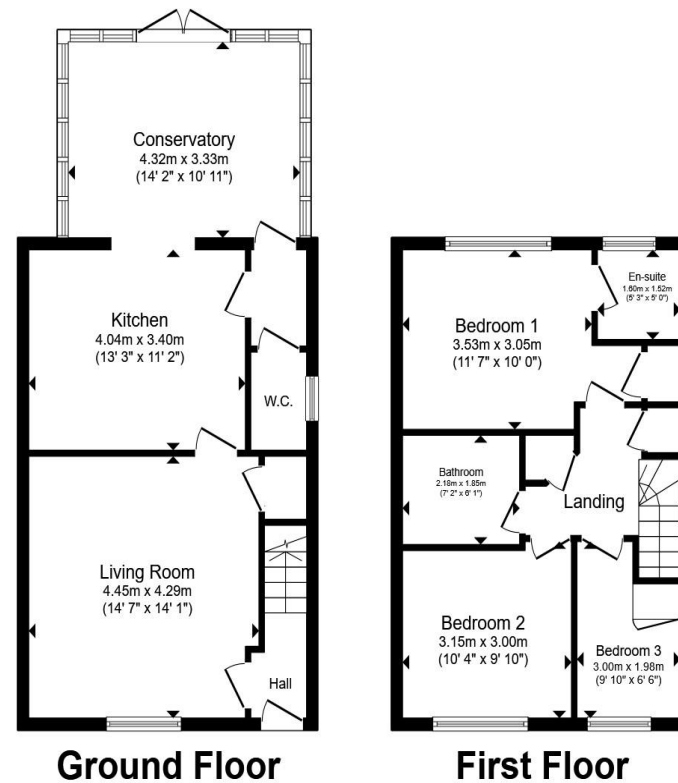

Total floor area 97.6 m² (1,050 sq.ft.) approx

This floor plan is for illustrative purposes only. It is not drawn to scale. Any measurements, floor areas (including any total floor area), openings and orientation are approximate. No details are guaranteed, they cannot be relied upon for any purpose and they do not form part of any agreement. No liability is taken for any error, omission or misstatement. A party must rely upon its own inspection(s). Powered by www.propertybox.io

 fox & sons

view this property online fox-and-sons.co.uk/Property/AXM104728



Property Ref:
AXM104728 - 0010

1. MONEY LAUNDERING REGULATIONS Intending purchasers will be asked to produce identification documentation at a later stage and we would ask for your co-operation in order that there is no delay in agreeing the sale. 2. These particulars do not constitute part or all of an offer or contract. 3. The measurements indicated are supplied for guidance only and as such must be considered incorrect. Potential buyers are advised to recheck measurements before committing to any expense. 4. We have not tested any apparatus, equipment, fixtures or services and it is in the buyers interest to check the working condition of any appliances. 5. Where an EPC, or a Home Report (Scotland only) is held for this property, it is available for inspection at the branch by appointment. If you require a printed version of a Home Report, you will need to pay a reasonable production charge reflecting printing and other costs. 6. We are not able to offer an opinion either written or verbal on the content of these reports and this must be obtained from your legal representative. 7. Whilst we take care in preparing these reports, a buyer should ensure that his/her legal representative confirms as soon as possible all matters relating to title including the extent and boundaries of the property and other important matters before exchange of contracts.

Fox & Sons is a trading name of Sequence (UK) Limited which is registered in England and Wales under company number 4268443, Registered Office is Cumbria House, 16-20 Hockliffe Street, Leighton Buzzard, Bedfordshire, LU7 1GN. VAT Registration Number is 500 2481 05.

 fox & sons



01297 32323



axminster@fox-and-sons.co.uk



West Street, AXMINSTER, Devon, EX13 5NU



fox-and-sons.co.uk