



Rose Cottage, Lovedean Lane, Waterlooville PO8 9RW

welcome to

Rose Cottage Lovedean Lane, Waterloo

This beautiful and unique three bedroom detached; thatched cottage must be seen to be appreciated. Built in the mid-18th Century this building has a myriad of original features including original fireplaces, a built-in bread oven and original wooden beams. Internal viewing essential.

Entrance Hall

Wooden front door. Textured ceiling. Textured walls. Radiator. Ceramic tiled flooring.

Cloakroom

Single glazed to front elevation. Textured ceiling. Textured and panelled walls. Radiator. Basin over vanity. Low level WC. Ceramic tiled flooring.

Lounge

15' x 13' (4.57m x 3.96m)
Single glazed windows to front elevation. Smooth ceiling. Wooden beams. Ornamental fireplace. Radiator. Carpeted flooring. Door to Bedroom 3.

Dining Room

12' 4" + recess x 10' 8" (3.76m + recess x 3.25m)
Single glazed windows to front elevation. Fireplace with wood burner. Radiator. Bread oven. Cupboard housing meters. Storage under stairs. Open plan to Kitchen. Door to Lounge. Carpeted flooring.

Kitchen

15' 3" x 5' 6" (4.65m x 1.68m)
Single glazed to rear elevation. Textured ceiling with beams. Textured and tiled walls. Radiator. Base unit storage. Space for appliances. Laminate flooring. Barn style door to side elevation.

Landing

Single glazed to rear elevation. Textured ceiling. Textured walls. Carpeted flooring.

Bedroom One

15' 1" x 13' 7" (4.60m x 4.14m)
Single glazed to front and side elevations. Textured ceiling. Wooden beams. Radiator. Ornamental fireplace. Carpeted flooring.

Bedroom Two

14' 9" max x 13' 7" max (4.50m max x 4.14m max)
Single glazed to front and rear elevations. Textured ceiling. Wooden beams. Textured walls. Radiator. Basin over vanity. Carpeted flooring.

Bedroom Three

14' 7" x 5' 9" (4.45m x 1.75m)
Single glazed to rear and side elevations. Textured ceiling. Textured walls. Radiator. Cupboard housing boiler. Carpeted flooring.

Bathroom

Single glazed to rear elevation. Textured ceiling. Spotlights. Panelled walls. Radiator. Bath. Electric shower. Pedestal wash hand basin. Low level WC. Ceramic tiled flooring.

Garage

15' 7" x 16' 9" (4.75m x 5.11m)
Brick built. Electric up and over door. Power and lighting. Storage in rafters. Concrete flooring. Double glazed to rear elevation. Side door.

Summer House

11' 8" x 11' 6" (3.56m x 3.51m)
Boarded 'Thatched Summer House'. Single glazed to side elevation. Single glazed door to rear elevation. Storage in loft. Power sockets.

Front Garden

Gated driveway. Mature shrubs and flowers. Tarmac. Pedestrian access to rear garden. gated access with pedestrian path to entrance.

Rear Garden

Laid to lawn. Shrubs and flowers. Greenhouse. 'Fruit & Veg plots'. Three Apple Trees, One Pear Tree, Two Plum Trees, One Damson Tree. Raised beds.

Wash House

5' 2" x 8' 1" (1.57m x 2.46m)
Single glazed to side elevation. Smooth ceiling. Brick walls. Space for appliances. Ceramic tiled flooring. featuring original washtub with lid.



Ground Floor

fox & sons

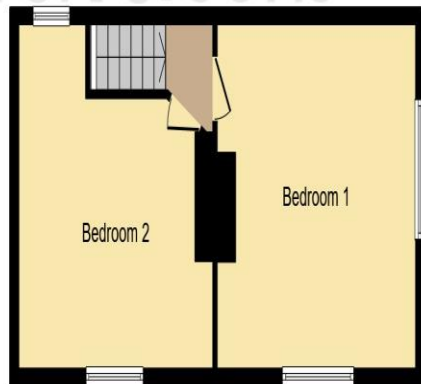

First Floor

This floor plan is for illustrative purposes only. It is not drawn to scale. Any measurements, floor areas (including any total floor area), openings and orientation are approximate. No details are guaranteed, they cannot be relied upon for any purpose and they do not form part of any agreement. No liability is taken for any error, omission or misstatement. A party must rely upon its own inspection(s). Powered by www.focalagent.com



welcome to
Rose Cottage Lovedean Lane,
Waterlooville

- Council Tax Band: E
- Opportunity to Own a Piece of History
- Grade II Listed Building
- Three Bedroom Thatched Cottage
- Situated on a Third of an Acre

Tenure: Freehold EPC Rating: Exempt

£635,000



view this property online fox-and-sons.co.uk/Property/WLV108783



Property Ref:
WLV108783 - 0005

1. MONEY LAUNDERING REGULATIONS Intending purchasers will be asked to produce identification documentation at a later stage and we would ask for your co-operation in order that there is no delay in agreeing the sale. 2. These particulars do not constitute part or all of an offer or contract. 3. The measurements indicated are supplied for guidance only and as such must be considered incorrect. Potential buyers are advised to recheck measurements before committing to any expense. 4. We have not tested any apparatus, equipment, fixtures or services and it is in the buyers interest to check the working condition of any appliances. 5. Where an EPC, or a Home Report (Scotland only) is held for this property, it is available for inspection at the branch by appointment. If you require a printed version of a Home Report, you will need to pay a reasonable production charge reflecting printing and other costs. 6. We are not able to offer an opinion either written or verbal on the content of these reports and this must be obtained from your legal representative. 7. Whilst we take care in preparing these reports, a buyer should ensure that his/her legal representative confirms as soon as possible all matters relating to title including the extent and boundaries of the property and other important matters before exchange of contracts.

Fox & Sons is a trading name of Sequence (UK) Limited which is registered in England and Wales under company number 4268443, Registered Office is Cumbria House, 16-20 Hockliffe Street, Leighton Buzzard, Bedfordshire, LU7 1GN. VAT Registration Number is 500 2481 05.

fox & sons



023 9226 2447



Waterlooville@fox-and-sons.co.uk



81B London Road, WATERLOOVILLE,
Hampshire, PO7 7ES



fox-and-sons.co.uk