



**Park Avenue, Waterlooville PO7 5DW**

**welcome to**

## **Park Avenue, Waterloo**

A lovely terraced bungalow offering three bedrooms, a shower room, lounge, kitchen and spacious conservatory. The front garden is laid to lawn, while the rear garden is low maintenance with patio and shingle. The property also benefits from a garage and parking to the rear.

### **Entrance Hall**

Via front door with doors to:

### **Bedroom One**

14' 1" x 9' 10" ( 4.29m x 3.00m )

Double glazed box bay window to front aspect.  
Laminate flooring, radiator. Built-in wardrobes.

### **Bedroom Two**

11' 8" x 7' 10" ( 3.56m x 2.39m )

Double glazed window to rear aspect. Laminate flooring, radiator.

### **Lounge**

13' 1" x 11' 5" ( 3.99m x 3.48m )

Double glazed sliding patio door leading to conservatory. Wall mounted feature fire, laminate floor, radiator.

### **Conservatory**

20' 4" x 7' 6" ( 6.20m x 2.29m )

Brick and double glazed with polycarbonate roofing. Laminate floor, cupboard storage space with work surface over, giving space for tumble dryer. Space for dining table and chairs.

### **Bedroom Three**

8' 6" x 6' 6" ( 2.59m x 1.98m )

Window through to conservatory. Currently being used as an office.

### **Kitchen**

11' 9" x 7' 6" ( 3.58m x 2.29m )

Double glazed window to front aspect. Range of wall and base cupboards and drawers with work surface over incorporating sink unit with mixer tap over. Built-in oven and hob with extractor hood over, space for washing machine. Built-in fridge/freezer. Tiled floor.

### **Shower Room**

Double glazed window to front aspect. Shower with sliding door, wash hand basin and low level WC set in vanity unit with enclosed cistern. Tiled floor, heating towel rail.

### **Outside**

#### **Front Garden**

Laid to lawn with central pathway leading to front door, with mature shrubs.

#### **Rear Garden**

Low maintenance garden with raised flower bed, patio and shingled area. Personal door to garage. Gate to rear.

### **Garage**

To the rear of the property with up and over door.



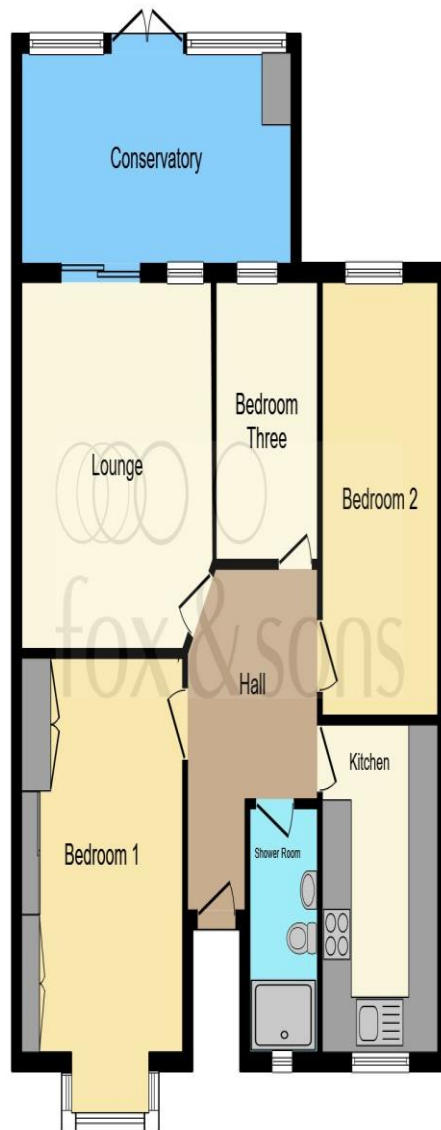

This floor plan is for illustrative purposes only. It is not drawn to scale. Any measurements, floor areas (including any total floor area), openings and orientation are approximate. No details are guaranteed, they cannot be relied upon for any purpose and they do not form part of any agreement. No liability is taken for any error, omission or misstatement. A party must rely upon its own inspection(s). Powered by [www.focalagent.com](http://www.focalagent.com)



**welcome to**  
**Park Avenue,**  
**Waterlooville**

- Terraced Bungalow
- Three Bedrooms
- Shower Room
- Large Fully Boarded Loft with Drop Down Ladder
- Modern Kitchen

Tenure: Freehold EPC Rating: D  
Council Tax Band: C

offers in excess of  
**£360,000**



**view this property online** [fox-and-sons.co.uk/Property/WLV106647](https://fox-and-sons.co.uk/Property/WLV106647)



Property Ref:  
WLV106647 - 0005

1. MONEY LAUNDERING REGULATIONS Intending purchasers will be asked to produce identification documentation at a later stage and we would ask for your co-operation in order that there is no delay in agreeing the sale. 2. These particulars do not constitute part or all of an offer or contract. 3. The measurements indicated are supplied for guidance only and as such must be considered incorrect. Potential buyers are advised to recheck measurements before committing to any expense. 4. We have not tested any apparatus, equipment, fixtures or services and it is in the buyers interest to check the working condition of any appliances. 5. Where an EPC, or a Home Report (Scotland only) is held for this property, it is available for inspection at the branch by appointment. If you require a printed version of a Home Report, you will need to pay a reasonable production charge reflecting printing and other costs. 6. We are not able to offer an opinion either written or verbal on the content of these reports and this must be obtained from your legal representative. 7. Whilst we take care in preparing these reports, a buyer should ensure that his/her legal representative confirms as soon as possible all matters relating to title including the extent and boundaries of the property and other important matters before exchange of contracts.

Fox & Sons is a trading name of Sequence (UK) Limited which is registered in England and Wales under company number 4268443, Registered Office is Cumbria House, 16-20 Hockliffe Street, Leighton Buzzard, Bedfordshire, LU7 1GN. VAT Registration Number is 500 2481 05.

fox & sons



**023 9226 2447**



[Waterlooville@fox-and-sons.co.uk](mailto:Waterlooville@fox-and-sons.co.uk)



81B London Road, WATERLOOVILLE,  
Hampshire, PO7 7ES



**[fox-and-sons.co.uk](https://fox-and-sons.co.uk)**