



Gloucester Road, Waterlooville PO7 7BJ



welcome to

Gloucester Road, Waterlooville

This substantial, versatile, and spacious four bedroom semi detached house in Gloucester Road. With multiple additional rooms, this property has potential for six bedrooms if required. Offering a range of options for buyers, with multiple reception rooms, and potential bedrooms on the ground floor.

Entrance Hall

uPVC door. Double glazed to side and front elevations. Textured ceiling. Spotlights. Radiator. Vinyl flooring.

Cloakroom W / C

Double glazed to side elevation. Textured ceiling. Tiled walls. Wall basin. Low level WC. Vinyl flooring.

Lounge

22' 7" x 11' 9" (6.88m x 3.58m)

Double glazed to front and rear elevations. Textured ceiling. Smooth walls. Two radiators. Electric fireplace.

Sitting Room

11' 6" x 18' 7" (3.51m x 5.66m)

Double glazed to front and side elevations. Smooth ceiling. Coving. Fan and light. Smooth walls. Radiator. Carpeted flooring.

Kitchen

11' 8" x 8' 9" (3.56m x 2.67m)

Double glazed to rear elevation. Textured ceiling. Part smooth part tiled walls. Wall and base units. Storage cupboard. Space for appliances. Sink and drainer unit. Tiled flooring. Double glazed uPVC door to rear elevation.

Study

7' 8" x 10' 4" (2.34m x 3.15m)

Double glazed to front elevation. Textured ceiling. Smooth walls. Radiator. Laminate flooring.

Utility Room

7' 7" x 6' (2.31m x 1.83m)

Textured ceiling. Smooth walls. Wall and base units. Space for appliances. One and a half bowl sink. Tiled flooring.

Conservatory

11' 7" x 16' 2" (3.53m x 4.93m)

Double glazed to side and rear elevations. uPVC roof and textured ceiling. Smooth walls. Radiator. Tiled flooring. Door to WC. Double glazed French door to rear elevation.

Landing

Double glazed to rear elevation. Textured ceiling. Loft access. Smooth walls. Radiator. Storage. Carpeted flooring.

Bedroom One

12' x 13' 4" (3.66m x 4.06m)

Double glazed to front elevation. Textured ceiling. Smooth walls. Radiator. Built in cupboard. Carpeted flooring.

Bedroom Two

11' 6" x 11' 1" (3.51m x 3.38m)

Double glazed to front elevation. Textured ceiling. Smooth walls. Radiator. Carpeted flooring.

Bedroom Three

11' 6" x 9' 6" (3.51m x 2.90m)

Double glazed to rear elevation. Textured ceiling. Smooth walls. Radiator. Carpeted flooring.

Bedroom Four

7' 7" x 13' 3" (2.31m x 4.04m)

Double glazed to rear elevation. Smooth ceiling. Smooth walls. Radiator. Storage. Laminate flooring.

Shower Room

Double glazed to rear elevation. Smooth ceiling. Spotlights. Part smooth part tiled walls. Radiator. Walk-in shower. Basin. Low level WC. Tiled flooring.

Bathroom

Double glazed to rear elevation. Textured ceiling. Spotlights. Part smooth part tiled walls. Radiator. Bath and shower. Pedestal wash hand basin. Low level WC. Tiled flooring.

Front Garden

Shingle drive for approx. Eight vehicles. Shrubs.

Rear Garden

Laid to patio. Laid to lawn. Shrubs and trees. Private area to side. Outside metal storage sheds. Double gates to front.



Ground Floor

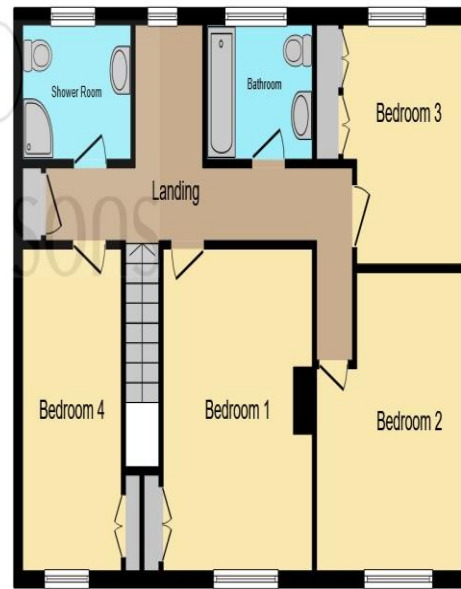

First Floor

This floor plan is for illustrative purposes only. It is not drawn to scale. Any measurements, floor areas (including any total floor area), openings and orientation are approximate. No details are guaranteed, they cannot be relied upon for any purpose and they do not form part of any agreement. No liability is taken for any error, omission or misstatement. A party must rely upon its own inspection(s). Powered by www.focalagent.com



welcome to
**Gloucester Road,
Waterlooville**

- Four Bedroom Semi-detached House
- Large Driveway for Multiple Cars
- Multiple Reception Rooms / Potential Bedrooms on the Ground Floor
- Converted Garage into Living Room
- Enclosed Rear Garden

Tenure: Freehold EPC Rating: D

£450,000



view this property online fox-and-sons.co.uk/Property/WLV108589



Property Ref:
WLV108589 - 0006

1. MONEY LAUNDERING REGULATIONS Intending purchasers will be asked to produce identification documentation at a later stage and we would ask for your co-operation in order that there is no delay in agreeing the sale. 2. These particulars do not constitute part or all of an offer or contract. 3. The measurements indicated are supplied for guidance only and as such must be considered incorrect. Potential buyers are advised to recheck measurements before committing to any expense. 4. We have not tested any apparatus, equipment, fixtures or services and it is in the buyers interest to check the working condition of any appliances. 5. Where an EPC, or a Home Report (Scotland only) is held for this property, it is available for inspection at the branch by appointment. If you require a printed version of a Home Report, you will need to pay a reasonable production charge reflecting printing and other costs. 6. We are not able to offer an opinion either written or verbal on the content of these reports and this must be obtained from your legal representative. 7. Whilst we take care in preparing these reports, a buyer should ensure that his/her legal representative confirms as soon as possible all matters relating to title including the extent and boundaries of the property and other important matters before exchange of contracts.

Fox & Sons is a trading name of Sequence (UK) Limited which is registered in England and Wales under company number 4268443, Registered Office is Cumbria House, 16-20 Hockliffe Street, Leighton Buzzard, Bedfordshire, LU7 1GN. VAT Registration Number is 500 2481 05.

fox & sons



023 9226 2447



Waterlooville@fox-and-sons.co.uk



81B London Road, WATERLOOVILLE,
Hampshire, PO7 7ES



fox-and-sons.co.uk