



**Winterslow Drive, Havant PO9 5EB**



**welcome to**

## **Winterslow Drive, Havant**

Located in the ever popular Leigh park area and is a perfect purchase for someone looking to renovate or put their own stamp on the home. Ideal for first time buyers, call today to arrange a viewing.

### **Front Garden**

Laid to lawn with path to entrance. Pedestrian gate to rear garden.

### **Entrance Hall**

Double glazed to front elevation. Textured ceiling. Textured walls. Carpeted 'turn and rise' stairs to first floor level. Internal door to inner hall and storage cupboard.

### **Kitchen**

Double glazed to front elevation. Textured ceiling. Smooth walls. Kitchen comprising wall and base unit with contouring rolled edge work surface over. Inset sink and drainer with mixer tap. Space and plumbing for appliances. Built in storage cupboard. Vinyl flooring.

### **Lounge**

Double glazed bay window to rear elevation. Textured ceiling. Coving. Part textured and part smooth walls. Radiator. Gas feature fireplace. Space for table and chairs. Carpeted flooring.

### **Landing**

Double glazed to side elevation. Textured ceiling. Loft access. Textured walls. Carpeted flooring. Doors to Bedrooms One, Two and Shower room.

### **Bedroom One**

Double glazed to rear elevation. Textured ceiling. Coving. Smooth walls. Radiator. Carpeted flooring. Built in ..... .

### **Bedroom Two**

Double glazed to front elevation. Textured ceiling. Smooth walls. Radiator. Carpeted flooring.

### **Shower Room**

Double glazed to front elevation. Textured ceiling. textured walls. Wet room comprising of Low level WC. Wash hand basin. Shower attachment. Radiator. Non slip soak away flooring.

### **Rear Garden**

Enclosed corner plot rear garden. Side and rear pedestrian access. mainly laid to lawn with patio area and brick built shed. Ideal for an extension (subject to planning).

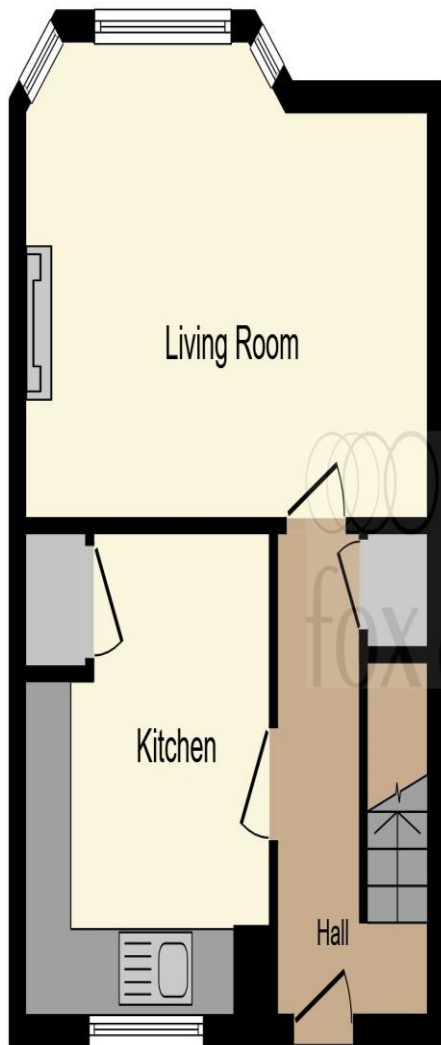

**Ground Floor**

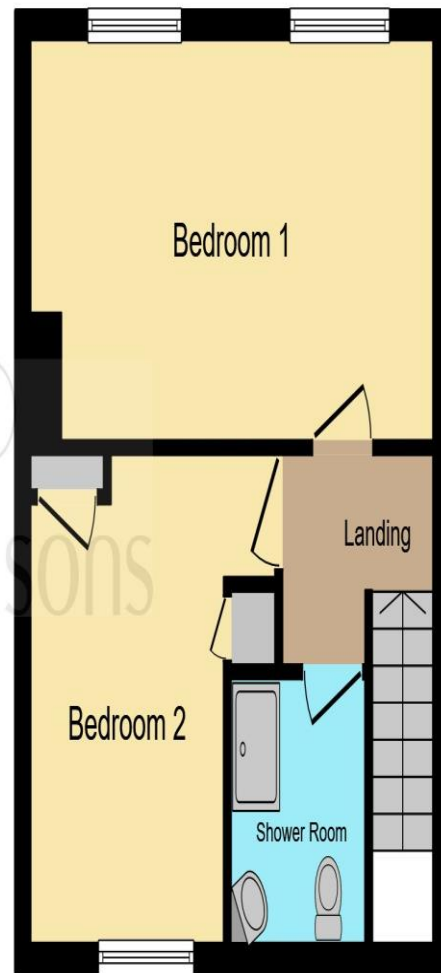

**First Floor**

This floor plan is for illustrative purposes only. It is not drawn to scale. Any measurements, floor areas (including any total floor area), openings and orientation are approximate. No details are guaranteed, they cannot be relied upon for any purpose and they do not form part of any agreement. No liability is taken for any error, omission or misstatement. A party must rely upon its own inspection(s). Powered by [www.focalagent.com](http://www.focalagent.com)



**welcome to**  
**Winterslow Drive,**  
**Havant**

- Council Tax Band: B
- Corner Plot
- End Terrace
- Large Rear Garden
- Two Bedrooms

Tenure: Freehold EPC Rating: B

guide price

**£240,000**



**view this property online** [fox-and-sons.co.uk/Property/WLV108714](https://fox-and-sons.co.uk/Property/WLV108714)



Property Ref:  
WLV108714 - 0007

1. MONEY LAUNDERING REGULATIONS Intending purchasers will be asked to produce identification documentation at a later stage and we would ask for your co-operation in order that there is no delay in agreeing the sale. 2. These particulars do not constitute part or all of an offer or contract. 3. The measurements indicated are supplied for guidance only and as such must be considered incorrect. Potential buyers are advised to recheck measurements before committing to any expense. 4. We have not tested any apparatus, equipment, fixtures or services and it is in the buyers interest to check the working condition of any appliances. 5. Where an EPC, or a Home Report (Scotland only) is held for this property, it is available for inspection at the branch by appointment. If you require a printed version of a Home Report, you will need to pay a reasonable production charge reflecting printing and other costs. 6. We are not able to offer an opinion either written or verbal on the content of these reports and this must be obtained from your legal representative. 7. Whilst we take care in preparing these reports, a buyer should ensure that his/her legal representative confirms as soon as possible all matters relating to title including the extent and boundaries of the property and other important matters before exchange of contracts.

Fox & Sons is a trading name of Sequence (UK) Limited which is registered in England and Wales under company number 4268443, Registered Office is Cumbria House, 16-20 Hockliffe Street, Leighton Buzzard, Bedfordshire, LU7 1GN. VAT Registration Number is 500 2481 05.

  
fox & sons



**023 9226 2447**



[Waterlooville@fox-and-sons.co.uk](mailto:Waterlooville@fox-and-sons.co.uk)



81B London Road, WATERLOOVILLE,  
Hampshire, PO7 7ES



**[fox-and-sons.co.uk](https://fox-and-sons.co.uk)**