



**Homeheights Clarence Parade, Southsea PO5 3NW**

**welcome to**  
**Homeheights Clarence Parade, Southsea**

1 bedroom retirement property in the Homeheights building, offering multiple different services and communal activities as well stunning sea views throughout the apartment. If you wish to view, please call us now.





### **Lounge/Dining Room**

17' 4" x 10' 3" ( 5.28m x 3.12m )

### **Kitchen**

7' 4" x 7' 4" ( 2.24m x 2.24m )

### **Bedroom**

13' 2" Max x 8' 7" ( 4.01m Max x 2.62m )

### **Bathroom**

welcome to

## Homeheights Clarence Parade, Southsea

- One Bedroom
- Retirement Property
- 8th Floor
- Stunning Seaviews
- Observation Deck

Tenure: Leasehold EPC Rating: Awaiting

This is a Leasehold property. We are awaiting further details about the Term of the lease. For further information please contact the branch. Please note additional fees could be incurred for items such as Leasehold packs.

guide price

**£150,000**

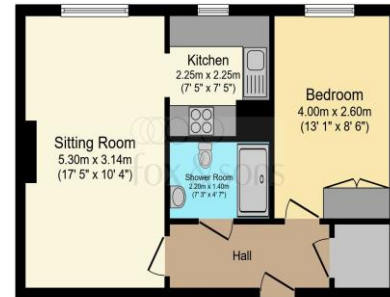

Total floor area 43.4 sq.m. (467 sq.ft.) approx.  
This diagram is for illustrative purposes only and is not drawn to scale. Measurements, floor areas, openings and orientations are approximate. They should not be relied upon for any purpose and do not form part of an agreement. No liability is taken for any error or mis-statement. All parties must view or their own reports.



Please note the marker reflects the postcode not the actual property

check out more properties at [fox-and-sons.co.uk](https://fox-and-sons.co.uk)



Property Ref:  
SOS105761 - 0003

1. MONEY LAUNDERING REGULATIONS Intending purchasers will be asked to produce identification documentation at a later stage and we would ask for your co-operation in order that there is no delay in agreeing the sale. 2. These particulars do not constitute part or all of an offer or contract. 3. The measurements indicated are supplied for guidance only and as such must be considered incorrect. Potential buyers are advised to recheck measurements before committing to any expense. 4. We have not tested any apparatus, equipment, fixtures or services and it is in the buyers interest to check the working condition of any appliances. 5. Where an EPC, or a Home Report (Scotland only) is held for this property, it is available for inspection at the branch by appointment. If you require a printed version of a Home Report, you will need to pay a reasonable production charge reflecting printing and other costs. 6. We are not able to offer an opinion either written or verbal on the content of these reports and this must be obtained from your legal representative. 7. Whilst we take care in preparing these reports, a buyer should ensure that his/her legal representative confirms as soon as possible all matters relating to title including the extent and boundaries of the property and other important matters before exchange of contracts.

**Not for marketing purposes INTERNAL USE ONLY**



**023 9229 3100**



[Southsea@fox-and-sons.co.uk](mailto:Southsea@fox-and-sons.co.uk)



65 Osborne Road, SOUTHSEA, Hampshire, PO5 3LS



[fox-and-sons.co.uk](https://fox-and-sons.co.uk)