



Revenge Close, Southsea PO4 8YE

welcome to

Revenge Close, Southsea

A spacious three bedroom semi-detached family home located in Revenge Close, Southsea. Being sold with no forward chain, showing great potential through out as well as having front and rear garden and a garage, this property is more than ideal for first time buyers and families.



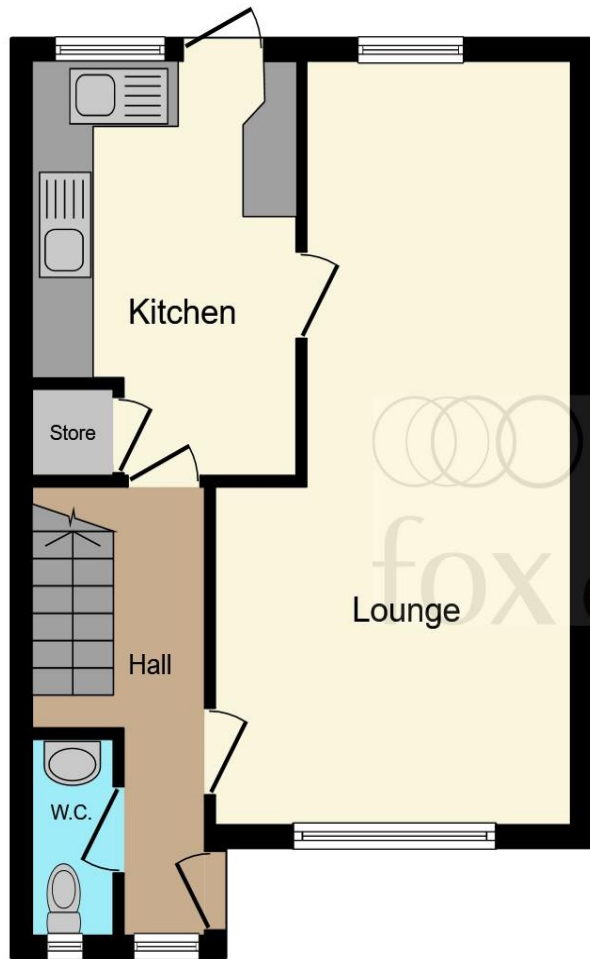

Ground Floor

Total floor area 75.9 m² (817 sq.ft.) approx

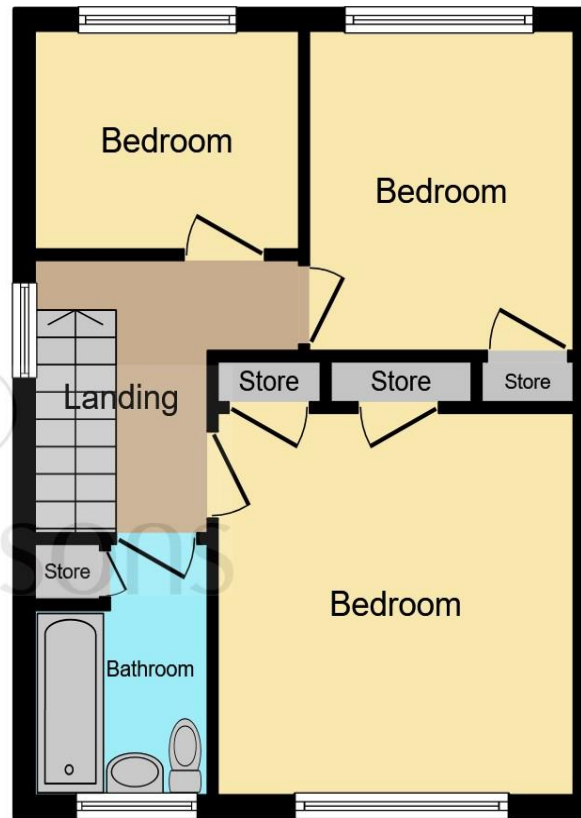

First Floor

Lounge

25' 1" x 11' 1" (7.65m x 3.38m)

Kitchen

13' 11" x 8' 8" (4.24m x 2.64m)

Bedroom 1

12' 5" x 11' 2" (3.78m x 3.40m)

Bedroom 2

10' 1" x 9' 1" (3.07m x 2.77m)

Bedroom 3

6' 8" x 8' 4" (2.03m x 2.54m)

Bathroom

Garage

16' 6" x 8' 1" (5.03m x 2.46m)

This floorplan is for illustrative purposes only and is not drawn to scale. Measurements, floor-areas, openings and orientations are approximate. They should not be relied upon for any purpose and do not form any part of an agreement. No liability is taken for any error or mis-statement. All parties must rely on their own inspections.

welcome to

Revenge Close, Southsea

- 3 BEDROOMS
- SEMI-DETACHED
- GARAGE
- FRONT AND REAR GARDEN
- DOWNSTAIRS WC

Tenure: Freehold EPC Rating: D

offers in excess of

£285,000



Please note the marker reflects the postcode not the actual property

view this property online fox-and-sons.co.uk/Property/SOS105462



Property Ref:
SOS105462 - 0007

1. MONEY LAUNDERING REGULATIONS Intending purchasers will be asked to produce identification documentation at a later stage and we would ask for your co-operation in order that there is no delay in agreeing the sale. 2. These particulars do not constitute part or all of an offer or contract. 3. The measurements indicated are supplied for guidance only and as such must be considered incorrect. Potential buyers are advised to recheck measurements before committing to any expense. 4. We have not tested any apparatus, equipment, fixtures or services and it is in the buyers interest to check the working condition of any appliances. 5. Where an EPC, or a Home Report (Scotland only) is held for this property, it is available for inspection at the branch by appointment. If you require a printed version of a Home Report, you will need to pay a reasonable production charge reflecting printing and other costs. 6. We are not able to offer an opinion either written or verbal on the content of these reports and this must be obtained from your legal representative. 7. Whilst we take care in preparing these reports, a buyer should ensure that his/her legal representative confirms as soon as possible all matters relating to title including the extent and boundaries of the property and other important matters before exchange of contracts.

fox & sons



023 9229 3100



Southsea@fox-and-sons.co.uk



65 Osborne Road, SOUTHSEA, Hampshire, PO5 3LS



fox-and-sons.co.uk