



Regent House, Cumberland Place, Southampton SO15 2BH

welcome to

Regent House, Cumberland Place, Southampton

Stylish Top Floor 1-Bedroom Flat in Grade II Listed Building - Regent House, Cumberland Place, Southampton

Nestled within the elegant and historic Regent House—a Grade II listed building—this beautifully presented top floor flat offers a unique blend of period charm and modern living.



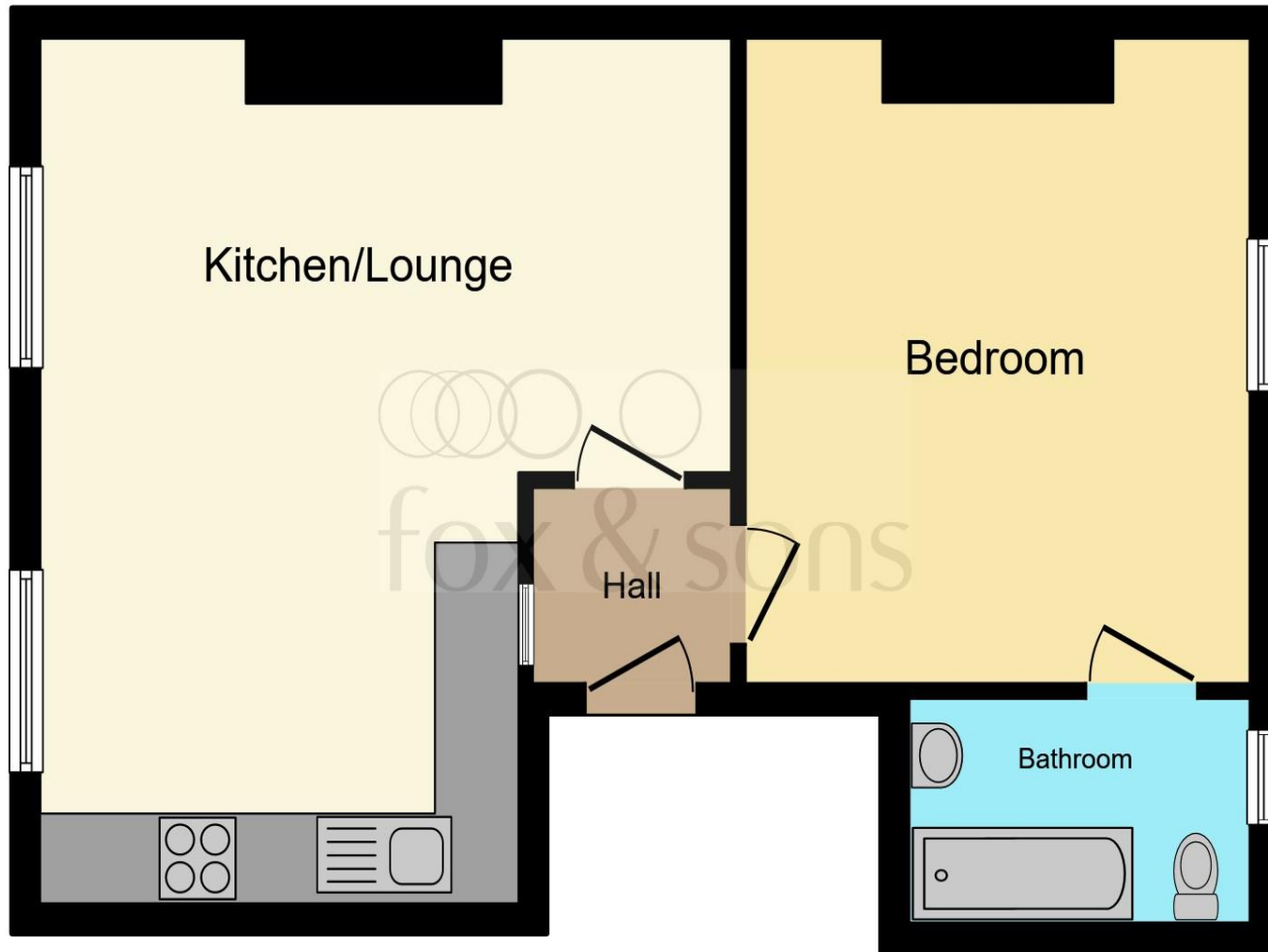

Entrance Hall

Kitchen/Lounge

18' 10" max x 16' 3" max (5.74m max x 4.95m max)

Bedroom

14' 7" max into alcove x 11' 10" (4.45m max into alcove x 3.61m)

Bathroom

This floor plan is for illustrative purposes only. It is not drawn to scale. Any measurements, floor areas (including any total floor area), openings and orientation are approximate. No details are guaranteed, they cannot be relied upon for any purpose and they do not form part of any agreement. No liability is taken for any error, omission or misstatement. A party must rely upon its own inspection(s). Powered by www.focalagent.com

welcome to

Regent House, Cumberland Place, Southampton

- Share of Freehold - 999 Year Lease & No Ground Rent
- No Onward Chain
- Allocated Parking Space
- Modern & Neutral Finish Throughout
- Easy Commute Links - Southampton Central Station within 5 Minute Walk

Tenure: Leasehold EPC Rating: F

Council Tax Band: A Service Charge: 676.95

Ground Rent: Ask Agent

This is a Leasehold property with details as follows; Term of Lease 999 years from 01 Jan 2024. Should you require further information please contact the branch. Please Note additional fees could be incurred for items such as Leasehold packs.

offers in excess of

£200,000



Please note the marker reflects the postcode not the actual property

view this property online fox-and-sons.co.uk/Property/SOU117505



Property Ref:
SOU117505 - 0010

1. MONEY LAUNDERING REGULATIONS Intending purchasers will be asked to produce identification documentation at a later stage and we would ask for your co-operation in order that there is no delay in agreeing the sale. 2. These particulars do not constitute part or all of an offer or contract. 3. The measurements indicated are supplied for guidance only and as such must be considered incorrect. Potential buyers are advised to recheck measurements before committing to any expense. 4. We have not tested any apparatus, equipment, fixtures or services and it is in the buyers interest to check the working condition of any appliances. 5. Where an EPC, or a Home Report (Scotland only) is held for this property, it is available for inspection at the branch by appointment. If you require a printed version of a Home Report, you will need to pay a reasonable production charge reflecting printing and other costs. 6. We are not able to offer an opinion either written or verbal on the content of these reports and this must be obtained from your legal representative. 7. Whilst we take care in preparing these reports, a buyer should ensure that his/her legal representative confirms as soon as possible all matters relating to title including the extent and boundaries of the property and other important matters before exchange of contracts.

Fox & Sons is a trading name of Sequence (UK) Limited which is registered in England and Wales under company number 4268443, Registered Office is Cumbria House, 16-20 Hockliffe Street, Leighton Buzzard, Bedfordshire, LU7 1GN. VAT Registration Number is 500 2481 05.



fox & sons



02380 225155



Southampton@fox-and-sons.co.uk



32 - 34 London Road, SOUTHAMPTON,
Hampshire, SO15 2AG



fox-and-sons.co.uk