



**Marsden Mews, Hemsworth Pontefract WF9 4SY**



***Welcome to***

**Marsden Mews, Hemsworth Pontefract**

Three-Bedroom End Townhouse in Hemsworth charming home features a lounge, kitchen with patio doors, three bedrooms, and a bathroom. Outside, enjoy off-street parking, a fully enclosed garden with a patio, soft play area, raised decking, and stylish seating. Viewing recommended!



### **Entrance Hall**

A composite front entrance door and luxury vinyl tile flooring.

### **Wc**

With a low level flush WC, wash hand basin, luxury vinyl tile flooring and a gas central heating radiator.

### **Lounge**

13' 8" x 15' 11" ( 4.17m x 4.85m )

With a UPVC double glazed French door to the rear, UPVC double glazed window to the rear, under stairs storage cupboard and two gas central heating radiators.

### **Kitchen**

7' 11" x 10' 5" ( 2.41m x 3.17m )

A fitted kitchen consisting wall, base and drawer units with work surfaces over, gas hob, electric oven, extractor fan, plumbing for washing machine, slim line dish washer, space for a fridge freezer, breakfast bar, tiled splash back, luxury vinyl tile and a UPVC double glazed window to the front aspect.

### **Landing**

With a cupboard housing the combi boiler and access to the boarded loft with a pull down ladder.

### **Bedroom One**

8' 5" x 12' 9" ( 2.57m x 3.89m )

With a UPVC double glazed window to the front aspect and a gas central heating radiator.

### **Bedroom Two**

8' 6" x 9' 10" ( 2.59m x 3.00m )

With a UPVC double glazed window to the rear aspect and a gas central heating radiator.

### **Bedroom Three**

6' 10" x 6' 3" ( 2.08m x 1.91m )

With a UPVC double glazed window to the rear aspect and a gas central heating radiator.

### **Bathroom**

A suite consisting of a low level flush WC, wash hand basin, bath with shower over, part tiled, luxury vinyl tile flooring, chrome heated towel rail and a UPVC double glazed window to the front aspect.

### **Front Garden**

With a driveway to the front and side providing ample off street parking.

### **Rear Garden**

A soft play area with climbing wall, decking and Wendy house to the lower and raised decking seating area and patio to the upper, timber fence surround and a grass lawn.

### **Container**

20' x 8' ( 6.10m x 2.44m )

A steel office with a single door pedestrian door, windows to both ends and electrics.

### **Summerhouse/Office**

12' x 10' ( 3.66m x 3.05m )

An insulated wooden constructed summerhouse, double doors, windows and electrics.



***view this property online*** [williamhbrown.co.uk/Property/PON117713](http://williamhbrown.co.uk/Property/PON117713)



**Welcome to**

## **Marsden Mews, Hemsworth Pontefract**

- Three Bedroom End Townhouse
- Downstairs WC
- Modern Housing Development
- Landscaped Tiered Rear Garden with Soft Play Area
- Driveway

Tenure: Freehold EPC Rating: Awaited

Council Tax Band: B

**£200,000**

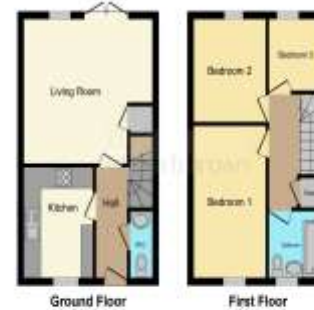

Please note the marker reflects the postcode not the actual property

**view this property online** [williamhbrown.co.uk/Property/PON117713](https://www.williamhbrown.co.uk/Property/PON117713)



Property Ref:  
PON117713 - 0003

1. MONEY LAUNDERING REGULATIONS Intending purchasers will be asked to produce identification documentation at a later stage and we would ask for your co-operation in order that there is no delay in agreeing the sale. 2. These particulars do not constitute part or all of an offer or contract. 3. The measurements indicated are supplied for guidance only and as such must be considered incorrect. Potential buyers are advised to recheck measurements before committing to any expense. 4. We have not tested any apparatus, equipment, fixtures or services and it is in the buyers interest to check the working condition of any appliances. 5. Where an EPC, or a Home Report (Scotland only) is held for this property, it is available for inspection at the branch by appointment. If you require a printed version of a Home Report, you will need to pay a reasonable production charge reflecting printing and other costs. 6. We are not able to offer an opinion either written or verbal on the content of these reports and this must be obtained from your legal representative. 7. Whilst we take care in preparing these reports, a buyer should ensure that his/her legal representative confirms as soon as possible all matters relating to title including the extent and boundaries of the property and other important matters before exchange of contracts.

William H Brown is a trading name of Sequence (UK) Limited which is registered in England and Wales under company number 4268443, Registered Office is Cumbria House, 16-20 Hockliffe Street, Leighton Buzzard, Bedfordshire, LU7 1GN. VAT Registration Number is 500 2481 05.



**william h brown**



**01977 791406**



[Pontefract@williamhbrown.co.uk](mailto:Pontefract@williamhbrown.co.uk)



26 Market Place, PONTEFRAC, West Yorkshire,  
WF8 1AT



**[williamhbrown.co.uk](https://www.williamhbrown.co.uk)**