



**St. Giles Mount, Pontefract WF8 4BJ**

***Welcome to***

**St. Giles Mount, Pontefract**

\*\*\*GUIDE PRICE £140,000 - £150,000\*\*\* This well-presented three-bedroom terraced home in Pontefract features a spacious lounge with patio doors to a lovely rear garden, a kitchen/diner, and an entrance porch. With a private driveway and great location, it's perfect for comfortable living.



### **Entrance Hall**

With a front entrance door.

### **Lounge**

16' 6" x 12' 7" ( 5.03m x 3.84m )

With a double door to the rear, electric fire with surround, gas central heating radiator and a UPVC double glazed window to the front aspect.

### **Kitchen/ Diner**

16' 6" x 9' 8" ( 5.03m x 2.95m )

A fitted kitchen consisting of wall, base and drawer units with work surfaces over, stainless steel sink and drainer, electric oven, gas hob, extractor hood, microwave, integrated fridge freezer, space for washing machine and tumble dryer, under cabinet heaters, under lights, vinyl flooring, gas central heating radiator and a UPVC double glazed window to the rear aspect.

### **Rear Entrance**

Vinyl flooring and an under stairs storage cupboard.

### **Landing**

With a UPVC double glazed window to the rear aspect, loft access and a gas central heating radiator.

### **Bedroom One**

16' 6" x 9' 9" ( 5.03m x 2.97m )

With two UPVC double glazed windows to the front and rear aspect and a gas central heating radiator.

### **Bedroom Two**

9' 2" x 8' 11" ( 2.79m x 2.72m )

With a UPVC double glazed window to the rear aspect, laminate flooring and a gas central heating radiator.

### **Bedroom Three**

9' 2" x 6' 10" ( 2.79m x 2.08m )

With a UPVC double glazed window to the rear aspect, laminate flooring and a gas central heating radiator.

### **Bathroom**

A suite consisting of a low level flush WC, wash hand basin, bath with shower over, towel radiator, spot lights to the ceiling, extractor fan, fully tiled and a UPVC double glazed window to the front aspect.

### **Front Garden**

Driveway and wall surround.

### **Rear Garden**

Lawned garden, rear access from shared access, two wood sheds, patio area and fencing surround.



***view this property online*** [williamhbrown.co.uk/Property/PON118775](http://williamhbrown.co.uk/Property/PON118775)





**Welcome to**

## **St. Giles Mount, Pontefract**

- \*\*\*GUIDE PRICE £140,000 - £150,000\*\*\*
- Three Bedroom Mid-Town House
- Driveway
- Local Amenities
- Short Distance From Pontefract Town Centre

Tenure: Freehold EPC Rating: D

Council Tax Band: A

guide price

**£140,000 - £150,000**

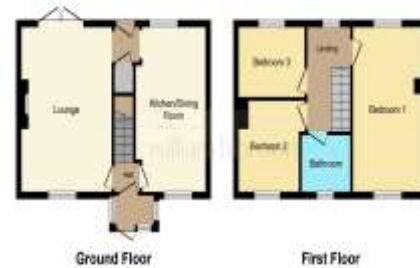

Please note the marker reflects the postcode not the actual property

**view this property online** [williamhbrown.co.uk/Property/PON118775](https://williamhbrown.co.uk/Property/PON118775)



Property Ref:  
PON118775 - 0002

1. MONEY LAUNDERING REGULATIONS Intending purchasers will be asked to produce identification documentation at a later stage and we would ask for your co-operation in order that there is no delay in agreeing the sale. 2. These particulars do not constitute part or all of an offer or contract. 3. The measurements indicated are supplied for guidance only and as such must be considered incorrect. Potential buyers are advised to recheck measurements before committing to any expense. 4. We have not tested any apparatus, equipment, fixtures or services and it is in the buyers interest to check the working condition of any appliances. 5. Where an EPC, or a Home Report (Scotland only) is held for this property, it is available for inspection at the branch by appointment. If you require a printed version of a Home Report, you will need to pay a reasonable production charge reflecting printing and other costs. 6. We are not able to offer an opinion either written or verbal on the content of these reports and this must be obtained from your legal representative. 7. Whilst we take care in preparing these reports, a buyer should ensure that his/her legal representative confirms as soon as possible all matters relating to title including the extent and boundaries of the property and other important matters before exchange of contracts.

William H Brown is a trading name of Sequence (UK) Limited which is registered in England and Wales under company number 4268443, Registered Office is Cumbria House, 16-20 Hockliffe Street, Leighton Buzzard, Bedfordshire, LU7 1GN. VAT Registration Number is 500 2481 05.



**william h brown**



**01977 791406**



[Pontefract@williamhbrown.co.uk](mailto:Pontefract@williamhbrown.co.uk)



26 Market Place, PONTEFRAC, West Yorkshire,  
WF8 1AT



**[williamhbrown.co.uk](https://williamhbrown.co.uk)**