



Garden Street, Ackworth Pontefract WF7 7BB

Welcome to

Garden Street, Ackworth Pontefract

Offered for sale is this two bedroom mid-terraced with NO ONWARD CHAIN located in the village of Ackworth. Driveway for off street parking, garage, local shops and amenities, ideal for first time buyers. MUST VIEW!!



Lounge

13' 5" x 11' 6" (4.09m x 3.51m)

With a UPVC double glazed window to the front aspect, brick inglenook fire place, timber shelf, gas log burner, gas central heating radiator and a UPVC front door.

Dining Kitchen

13' 4" x 13' 2" (4.06m x 4.01m)

A fitted kitchen consisting of wall, base and draw units with work surfaces over, stainless sink and drainer, gas hob, electric oven, extractor fan, plumbing for washing machine, space for fridge freezer, shelved pantry, cupboard housing the boiler, gas central heating radiator, vinyl floor covering, UPVC double glazed rear door and a UPVC double glazed window to the rear aspect.

Bedroom One

13' 6" x 11' 4" (4.11m x 3.45m)

With a UPVC double glazed window to the front aspect, storage cupboard with loft access and a gas central heating radiator.

Bedroom Two

13' 1" x 9' 2" (3.99m x 2.79m)

With a UPVC double glazed window to the rear aspect and a gas central heating radiator.

Bathroom

A suite consisting of a low level flush WC, wash hand basin, panelled bath, part tiled to walls, vinyl floor covering and a UPVC double glazed window to the rear aspect.

Front Garden

A good size lawned garden with a timber gate to the rear garage.

Rear Garden

Parking space to the rear.

Garage

With up and over door, light and electric.



view this property online williamhbrown.co.uk/Property/PON118606



Welcome to

Garden Street, Ackworth Pontefract

- Two Bedroom Victorian Mid-Terrace House
- NO ONWARD CHAIN
- Ideal For First time Buyers Or Investors
- Driveway And Garage
- Local Amenities

Tenure: Freehold EPC Rating: D

£140,000

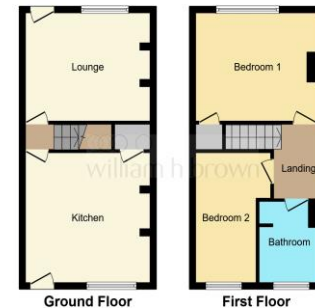

Please note the marker reflects the postcode not the actual property

view this property online [williamhbrown.co.uk/Property/PON118606](https://www.williamhbrown.co.uk/Property/PON118606)



Property Ref:
PON118606 - 0002

1. MONEY LAUNDERING REGULATIONS Intending purchasers will be asked to produce identification documentation at a later stage and we would ask for your co-operation in order that there is no delay in agreeing the sale. 2. These particulars do not constitute part or all of an offer or contract. 3. The measurements indicated are supplied for guidance only and as such must be considered incorrect. Potential buyers are advised to recheck measurements before committing to any expense. 4. We have not tested any apparatus, equipment, fixtures or services and it is in the buyers interest to check the working condition of any appliances. 5. Where an EPC, or a Home Report (Scotland only) is held for this property, it is available for inspection at the branch by appointment. If you require a printed version of a Home Report, you will need to pay a reasonable production charge reflecting printing and other costs. 6. We are not able to offer an opinion either written or verbal on the content of these reports and this must be obtained from your legal representative. 7. Whilst we take care in preparing these reports, a buyer should ensure that his/her legal representative confirms as soon as possible all matters relating to title including the extent and boundaries of the property and other important matters before exchange of contracts.

William H Brown is a trading name of Sequence (UK) Limited which is registered in England and Wales under company number 4268443, Registered Office is Cumbria House, 16-20 Hockliffe Street, Leighton Buzzard, Bedfordshire, LU7 1GN. VAT Registration Number is 500 2481 05.



william h brown



01977 791406



Pontefract@williamhbrown.co.uk



26 Market Place, PONTEFRAC, West Yorkshire,
WF8 1AT



[williamhbrown.co.uk](https://www.williamhbrown.co.uk)