



**Miners Lane, Hemsworth Pontefract WF9 4FQ**

***Welcome to***

**Miners Lane, Hemsworth Pontefract**

\*\*\*GUIDE PRICE £200,000 - £210,000\*\*\* NO ONWARD CHAIN, four bedroom spacious semi-detached, set over three floors, DRIVEWAY, good size rear garden. Modern popular development, short distance to the town centre!!



**Entrance Hall**

With a UPVC double glazed door, tiled floor and a gas central heating radiator.

**Wc**

With a UPVC double glazed window to the front aspect, low level flush WC, wash hand basin, tiled flooring and a gas central heating radiator.

**Lounge**

11' 7" x 14' 7" ( 3.53m x 4.45m )

With a UPVC double glazed French doors to the rear, under stairs cupboard, gas central heating radiator and tiled flooring.

**Dining Kitchen**

11' 7" x 13' 7" ( 3.53m x 4.14m )

A fitted kitchen consisting of wall, base and draw units with wood effect work surfaces over, gas hob, electric oven, extractor fan, stainless steel sink and drainer, washing machine, integrated fridge freezer, radiator, tiled flooring, cupboard housing combi boiler, gas central heating radiator and a UPVC double glazed window to the front aspect.

**First Floor Landing**

With a UPVC double glazed window to the front, storage cupboard, gas central heating radiator and stairs to the second floor.

**Bedroom Three**

12' 8" x 9' 5" ( 3.86m x 2.87m )

With a UPVC double glazed window to the rear aspect and gas central heating radiator.

**Bedroom Four**

9' 5" x 8' ( 2.87m x 2.44m )

With a UPVC double glazed Window to the front and a gas central heating radiator.

**Bedroom Four**

9' 5" x 8' ( 2.87m x 2.44m )

With a UPVC double glazed Window to the front and a gas central heating radiator.

**Bathroom**

A suite consisting of a low level flush WC, wash hand basin, panelled bath with shower attached, part tiled to walls, tiled flooring, extractor fan and a UPVC double glazed window to the side aspect.

**Second Floor Landing**

With stairs from the first floor, storage cupboard, access to the loft and a gas central heating radiator.

**Bedroom One**

14' 7" x 9' 9" ( 4.45m x 2.97m )

With a UPVC double glazed window to the rear aspect and a gas central heating radiator.

**Ensuite**

A suite consisting of a low level flush WC, wash hand basin, walk in shower cubicle, tiled flooring, tiled walls in shower and a UPVC double glazed window to the side aspect.

**Bedroom Two**

14' 8" x 10' 3" ( 4.47m x 3.12m )

With two UPVC double glazed windows to the front aspect, built in storage cupboard and a gas central heating radiator.

**Front Garden**

With a good size driveway to the front.

**Rear Garden**

A tiered garden mainly laid to lawn with a timber fencing surround, garden shed and patio seating area.



***view this property online*** [williamhbrown.co.uk/Property/PON118270](http://williamhbrown.co.uk/Property/PON118270)





**Welcome to**

## **Miners Lane, Hemsworth Pontefract**

- \*\*\*GUIDE PRICE £200,000 - £210,000\*\*\*
- Four Bedroom Semi-Detached Home
- NO ONWARD CHAIN
- Front And Rear Garden
- Off Street Parking

Tenure: Freehold EPC Rating: B

guide price

**£200,000 - £210,000**

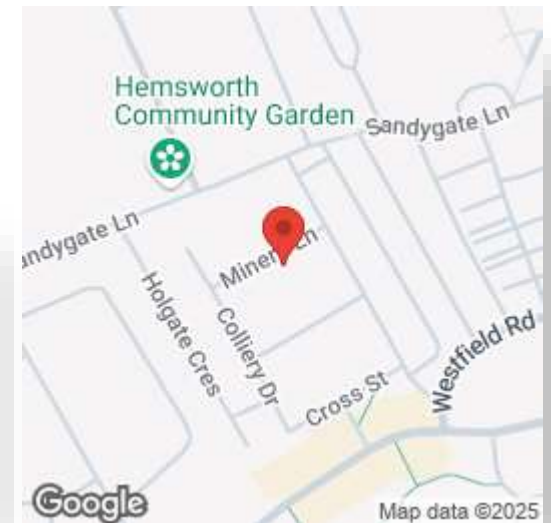
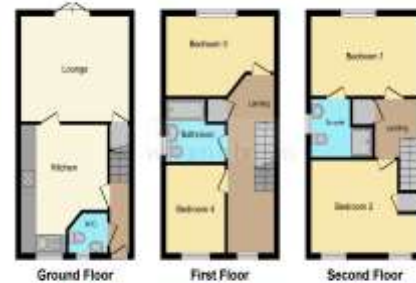

Please note the marker reflects the postcode not the actual property

**view this property online** [williamhbrown.co.uk/Property/PON118270](https://www.williamhbrown.co.uk/Property/PON118270)



Property Ref:  
PON118270 - 0003

1. MONEY LAUNDERING REGULATIONS Intending purchasers will be asked to produce identification documentation at a later stage and we would ask for your co-operation in order that there is no delay in agreeing the sale. 2. These particulars do not constitute part or all of an offer or contract. 3. The measurements indicated are supplied for guidance only and as such must be considered incorrect. Potential buyers are advised to recheck measurements before committing to any expense. 4. We have not tested any apparatus, equipment, fixtures or services and it is in the buyers interest to check the working condition of any appliances. 5. Where an EPC, or a Home Report (Scotland only) is held for this property, it is available for inspection at the branch by appointment. If you require a printed version of a Home Report, you will need to pay a reasonable production charge reflecting printing and other costs. 6. We are not able to offer an opinion either written or verbal on the content of these reports and this must be obtained from your legal representative. 7. Whilst we take care in preparing these reports, a buyer should ensure that his/her legal representative confirms as soon as possible all matters relating to title including the extent and boundaries of the property and other important matters before exchange of contracts.

William H Brown is a trading name of Sequence (UK) Limited which is registered in England and Wales under company number 4268443, Registered Office is Cumbria House, 16-20 Hockliffe Street, Leighton Buzzard, Bedfordshire, LU7 1GN. VAT Registration Number is 500 2481 05.



**william h brown**



**01977 791406**



[Pontefract@williamhbrown.co.uk](mailto:Pontefract@williamhbrown.co.uk)



26 Market Place, PONTEFRAC, West Yorkshire,  
WF8 1AT



**[williamhbrown.co.uk](https://www.williamhbrown.co.uk)**