



Cherville Court, Mill Lane, Romsey, SO51 8EX

welcome to

Cherville Court, Mill Lane, Romsey

Fox and Sons Romsey are pleased to bring to the market this one bedroom, First floor flat located in Central Romsey and offered with no onward chain. Modern throughout, Perfect for an investment, downsizing or as a first time buyer.



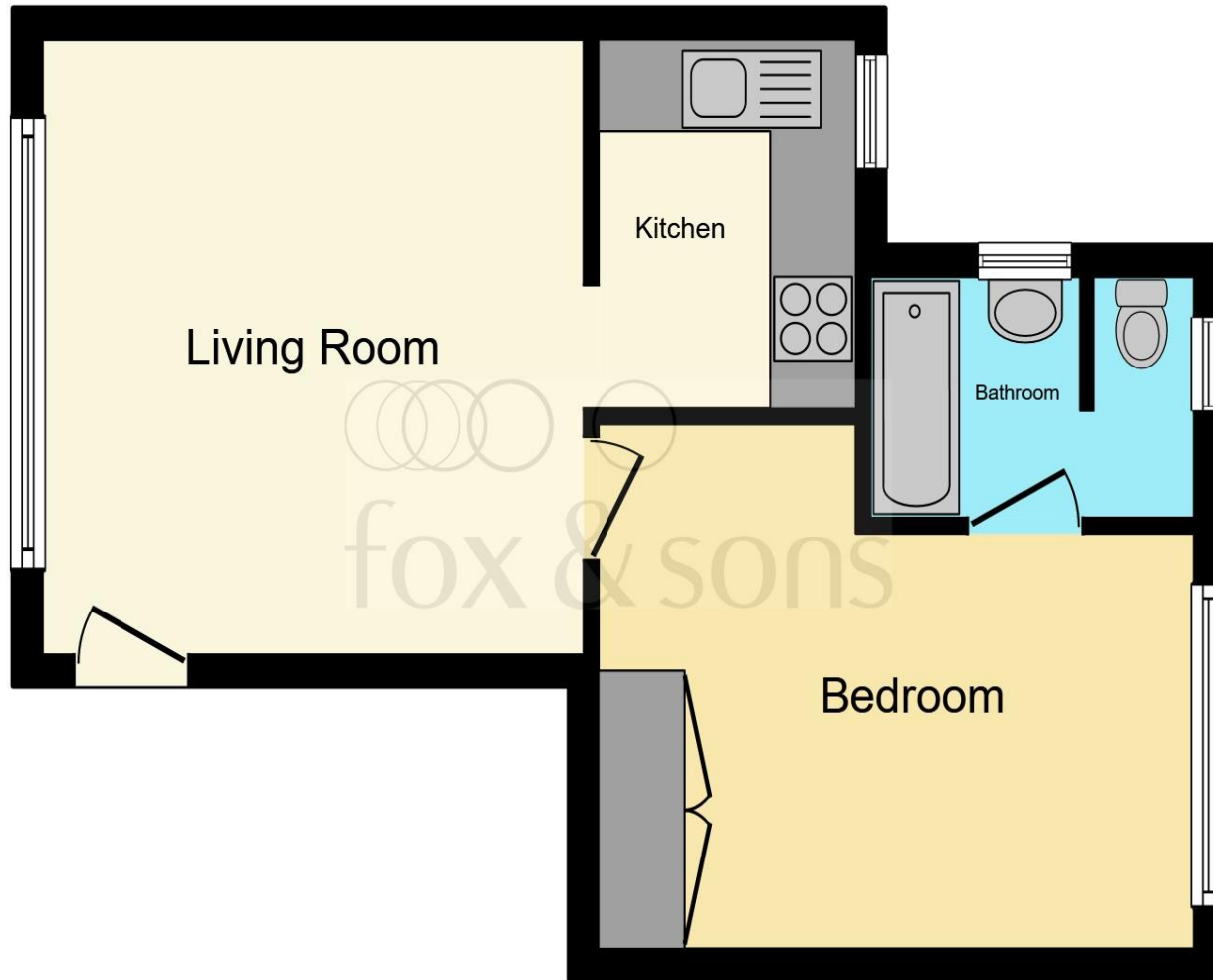

Living Room

12' 4" max x 13' 4" max (3.76m max x 4.06m max)

Kitchen

5' 9" max x 7' 9" max (1.75m max x 2.36m max)

Bedroom

13' 6" max x 8' 9" max (4.11m max x 2.67m max)

Bathroom

Agents Note:

It is our understanding that the Property is not registered at the Land Registry which is the case with a significant proportion of land across England and Wales. Your conveyancer will take the necessary steps and advise you accordingly.

This floor plan is for illustrative purposes only. It is not drawn to scale. Any measurements, floor areas (including any total floor area), openings and orientation are approximate. No details are guaranteed, they cannot be relied upon for any purpose and they do not form part of any agreement. No liability is taken for any error, omission or misstatement. A party must rely upon its own inspection(s). Powered by www.focalagent.com

welcome to

Cherville Court, Mill Lane, Romsey

- No Onward Chain
- Modern Ensuite Bathroom
- Central Romsey Location
- On Road Permit Parking
- Well Presented Throughout

Tenure: Leasehold EPC Rating: E

£150,000



view this property online fox-and-sons.co.uk/Property/RMY104635

Please note the marker reflects the postcode not the actual property

This is a Leasehold property. We are awaiting further details about the Term of the lease. For further information please contact the branch. Please note additional fees could be incurred for items such as Leasehold packs.

1. MONEY LAUNDERING REGULATIONS Intending purchasers will be asked to produce identification documentation at a later stage and we would ask for your co-operation in order that there is no delay in agreeing the sale. 2. These particulars do not constitute part or all of an offer or contract. 3. The measurements indicated are supplied for guidance only and as such must be considered incorrect. Potential buyers are advised to recheck measurements before committing to any expense. 4. We have not tested any apparatus, equipment, fixtures or services and it is in the buyers interest to check the working condition of any appliances. 5. Where an EPC, or a Home Report (Scotland only) is held for this property, it is available for inspection at the branch by appointment. If you require a printed version of a Home Report, you will need to pay a reasonable production charge reflecting printing and other costs. 6. We are not able to offer an opinion either written or verbal on the content of these reports and this must be obtained from your legal representative. 7. Whilst we take care in preparing these reports, a buyer should ensure that his/her legal representative confirms as soon as possible all matters relating to title including the extent and boundaries of the property and other important matters before exchange of contracts.



Property Ref:
RMY104635 - 0002

fox & sons



01794 513085



Romsey@fox-and-sons.co.uk



2 Market Place, ROMSEY, Hampshire, SO51 8NB



fox-and-sons.co.uk