



**Glenthorne Road, Portsmouth PO3 5DL**



**welcome to**

**Glenthorne Road, Portsmouth**

**\*\*CHAIN FREE FAMILY HOME IN COPNOR!\*\*** We are absolutely delighted to welcome to the market this charming three bedroom family home located in Copnor.



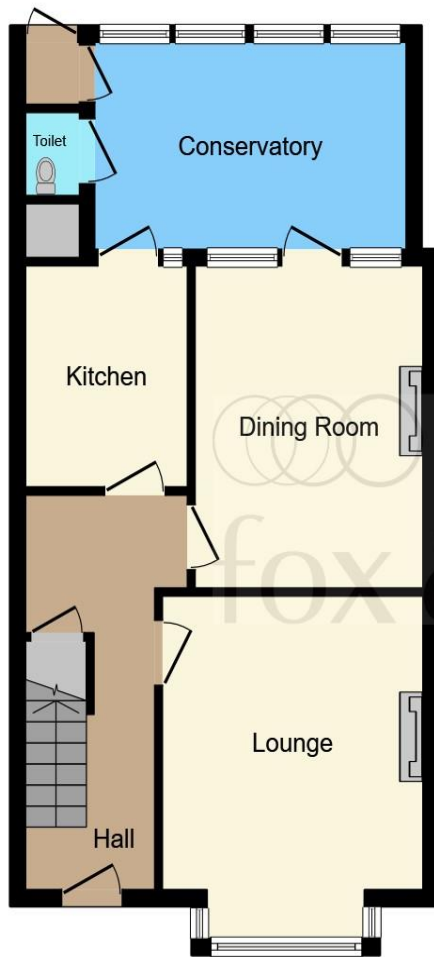

**Ground Floor**

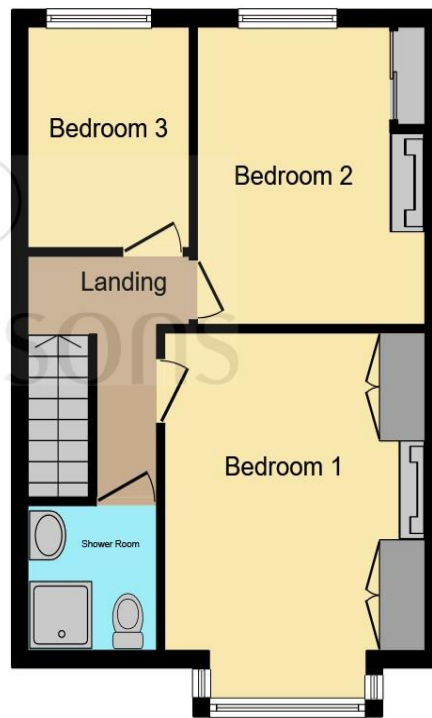

**First Floor**

## Entrance Porch

## Entrance Hall

## Lounge

13' 1" into bay x 11' 3" into recess ( 3.99m into bay x 3.43m into recess )

## Dining Room

12' 5" max x 9' 9" into recess ( 3.78m max x 2.97m into recess )

## Kitchen

9' 2" max x 6' 11" ( 2.79m max x 2.11m )

## Conservatory

8' 5" x 13' 5" ( 2.57m x 4.09m )

## Cloakroom

## Landing

## Bedroom One

14' 5" into bay x 11' 3" into recess ( 4.39m into bay x 3.43m into recess )

## Bedroom Two

12' x 9' 9" into recess ( 3.66m x 2.97m into recess )

## Bedroom Three

8' 1" x 6' 11" ( 2.46m x 2.11m )

## Wet Room

## Rear Garden

## Agents Notes

This floor plan is for illustrative purposes only. It is not drawn to scale. Any measurements, floor areas (including any total floor area), openings and orientation are approximate. No details are guaranteed, they cannot be relied upon for any purpose and they do not form part of any agreement. No liability is taken for any error, omission or misstatement. A party must rely upon its own inspection(s). Powered by [www.focalagent.com](http://www.focalagent.com)

welcome to

## Glenthorne Road, Portsmouth

- Chain Free
- Large garden with rear access
- Three Bedrooms
- Potential to modernise.
- Copnor

Tenure: Freehold EPC Rating: C

**£260,000**



Please note the marker reflects the  
postcode not the actual property

**view this property online** [fox-and-sons.co.uk/Property/POR111133](https://fox-and-sons.co.uk/Property/POR111133)



Property Ref:  
POR111133 - 0002

1. MONEY LAUNDERING REGULATIONS Intending purchasers will be asked to produce identification documentation at a later stage and we would ask for your co-operation in order that there is no delay in agreeing the sale. 2. These particulars do not constitute part or all of an offer or contract. 3. The measurements indicated are supplied for guidance only and as such must be considered incorrect. Potential buyers are advised to recheck measurements before committing to any expense. 4. We have not tested any apparatus, equipment, fixtures or services and it is in the buyers interest to check the working condition of any appliances. 5. Where an EPC, or a Home Report (Scotland only) is held for this property, it is available for inspection at the branch by appointment. If you require a printed version of a Home Report, you will need to pay a reasonable production charge reflecting printing and other costs. 6. We are not able to offer an opinion either written or verbal on the content of these reports and this must be obtained from your legal representative. 7. Whilst we take care in preparing these reports, a buyer should ensure that his/her legal representative confirms as soon as possible all matters relating to title including the extent and boundaries of the property and other important matters before exchange of contracts.

Fox & Sons is a trading name of Sequence (UK) Limited which is registered in England and Wales under company number 4268443, Registered Office is Cumbria House, 16-20 Hockliffe Street, Leighton Buzzard, Bedfordshire, LU7 1GN. VAT Registration Number is 500 2481 05.

  
fox & sons



**023 9267 1110**



[Portsmouth@fox-and-sons.co.uk](mailto:Portsmouth@fox-and-sons.co.uk)



126 London Road, PORTSMOUTH, Hampshire,  
PO2 9DE



**[fox-and-sons.co.uk](https://fox-and-sons.co.uk)**