



White Cottage, White Horse Lane, Briggate, North Walsham
NR28 9QZ

welcome to

White Cottage, White Horse Lane, Briggate North Walsham

****PRIVATE AND SECLUDED**** This spacious two bedroom cottage with stunning white frontage sits in a tucked away position within the Hamlet of Briggate and close to the town of North Walsham. Would make an ideal family home or retirement cottage with plenty of peace and quiet.



White cottage really needs to be seen to be believed. From the first moment when you park on the private driveway and see the beautiful white frontage you will instantly feel relaxed. Once you go through the side gate leading into the sizeable rear garden and terracotta seating area you will instantly feel relaxed in this peaceful private space. Located in Briggate which is a Hamlet close to North Walsham town centre this period property was built in 1810 but once you go inside you will see a modern yet cozy cottage with newly fitted kitchen and flooring throughout. When you put your shoes up in the entrance hall you will walk through to the kitchen and dining room to your left. The lounge will be found tucked away behind where you can look out to the mature garden area. The property is brightly illuminated with natural light and benefits from it's south facing position. Upstairs you will find two spacious double bedrooms and a newly furbished bathroom.

Entrance Porch

Karndean flooring, boiler, double glazed door to the rear aspect and window to the side aspect,

Lounge

Karndean Flooring, double glazed door to the side aspect and window to the rear aspect, Radiator and TV point

Dining Room

Karndean flooring, double glazed window to the front and rear aspect, wood fire connected to back burner and radiator

Kitchen

Newly fitted in September 2024, fully fitted with cupboard space and work surfaces, Karndean flooring, double glazed window to the side aspect, electric hob and oven with extractor, composite wash basin, integrated fridge, part tiled, plumbing for washing machine and spotlights.

Landing

Fully carpeted flooring, radiator and access to the loft.

Bedroom One

Karndean flooring, double glazed window to the rear aspect, radiator and spotlights.

Bedroom Two

Karndean flooring, double glazed window to the rear aspect, radiator and spotlights

Bathroom

Fully tiled shower unit with Mira shower and amazon style shower head, double glazed window to the rear, WC, sink basin and airing cupboard

External

Driveway with ample parking to the front and large patio, water tap, water butt, oil tank, greenhouse, Grass, mature trees and shrubs to the rear.

Outbuilding

Brick built building with electrics.

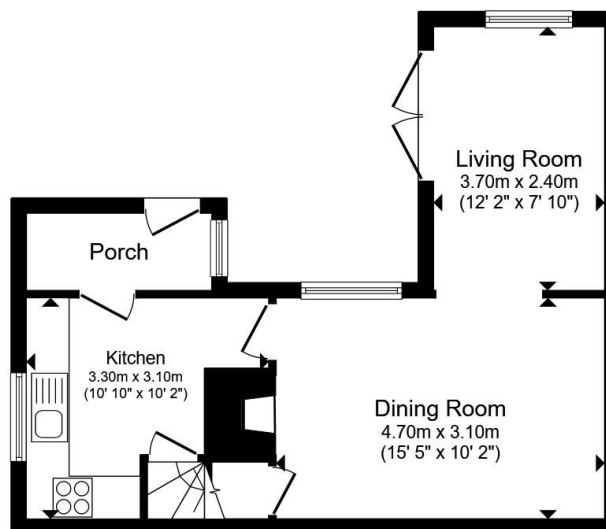

Ground Floor

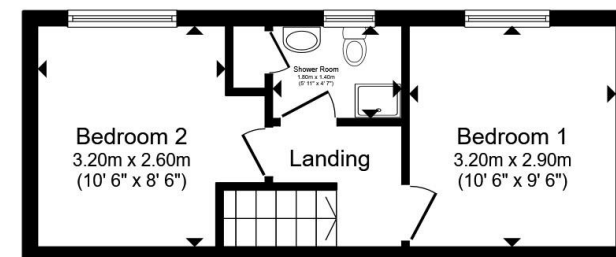

First Floor

Total floor area 62.4 m² (672 sq.ft.) approx

This floor plan is for illustrative purposes only. It is not drawn to scale. Any measurements, floor areas (including any total floor area), openings and orientation are approximate. No details are guaranteed, they cannot be relied upon for any purpose and they do not form part of any agreement. No liability is taken for any error, omission or misstatement. A party must rely upon its own inspection(s). Powered by www.propertybox.io



welcome to

White Cottage, White Horse Lane, Briggate, North Walsham

- Period property built in 1810
- Rural location
- Off-road parking on private driveway
- Beautiful white rendered frontage
- Fully enclosed private rear garden
- Kitchen renovated in September 2024
- Completely modernised since 2021

Tenure: Freehold EPC Rating: E
Council Tax Band: C

offers in the region of

£325,000



Please note the marker reflects the
postcode not the actual property

view this property online williamhbrown.co.uk/Property/NWM110006



Property Ref:
NWM110006 - 0006

1. MONEY LAUNDERING REGULATIONS Intending purchasers will be asked to produce identification documentation at a later stage and we would ask for your co-operation in order that there is no delay in agreeing the sale. 2. These particulars do not constitute part or all of an offer or contract. 3. The measurements indicated are supplied for guidance only and as such must be considered incorrect. Potential buyers are advised to recheck measurements before committing to any expense. 4. We have not tested any apparatus, equipment, fixtures or services and it is in the buyers interest to check the working condition of any appliances. 5. Where an EPC, or a Home Report (Scotland only) is held for this property, it is available for inspection at the branch by appointment. If you require a printed version of a Home Report, you will need to pay a reasonable production charge reflecting printing and other costs. 6. We are not able to offer an opinion either written or verbal on the content of these reports and this must be obtained from your legal representative. 7. Whilst we take care in preparing these reports, a buyer should ensure that his/her legal representative confirms as soon as possible all matters relating to title including the extent and boundaries of the property and other important matters before exchange of contracts.

William H Brown is a trading name of Sequence (UK) Limited which is registered in England and Wales under company number 4268443, Registered Office is Cumbria House, 16-20 Hockliffe Street, Leighton Buzzard, Bedfordshire, LU7 1GN. VAT Registration Number is 500 2481 05.



william h brown



01692 402861



NorthWalsham@williamhbrown.co.uk



16 Market Street, NORTH WALSHAM, Norfolk,
NR28 9BZ



williamhbrown.co.uk