



**Rainbows End Chalet Park Mill Lane, Bacton Norwich NR12
0HN**

welcome to

Rainbows End Chalet Park Mill Lane, Bacton Norwich

This immaculately presented two-bedroom chalet on the popular Rainbows End Chalet Park would make an ideal holiday home or holiday let, set within walking distance of Bacton Beach.



Description

Currently a successful holiday let, this immaculately presented and modern two-bedroom chalet would make an ideal investment purchase or second home for someone desiring a bolt hole within walking distance to the beach. The property offers accommodation comprising open plan lounge/ kitchen, inner hall, two double bedrooms and bathroom. Externally, the chalet boasts an allocated parking space, and an exterior decking area.

Lounge

Double glazed door and window to the front aspect, fitted blinds, decorative paneled walls, vertical radiator, television point, spotlights and laminate flooring.

Kitchen

Fitted kitchen with a range of wall and base units with work surfaces over, electric oven, induction hob with cooker hood, built in dishwasher, stainless steel sink drainer, built in fridge/ freezer, spotlights, vertical radiator, tiled splashback, laminate flooring and a double-glazed window to the rear aspect with fitted blinds.

Inner Hall

Access into loft space, heating controls, electric consumer unit, spotlights and laminate flooring.

Bedroom One

Double glazed window to the rear aspect with fitted blinds, decorative paneling, vertical radiator, spotlights and laminate flooring.

Bedroom Two

Double glazed window to the front aspect with fitted blinds, decorative paneling, vertical radiator, spotlights and laminate flooring.

Bathroom

Suite comprising bath with mixer tap and shower over, WC, wash hand basin, heated towel rail, extractor fan, part tiled walls, laminate flooring and a double glazed window to the rear aspect with fitted blinds.

Exterior

Externally, the property offers one allocated parking space and an enclosed decking area with space for seating.



view this property online williamhbrown.co.uk/Property/NWM109883



welcome to

Rainbows End Chalet Park Mill Lane, Bacton Norwich

- Immaculately Presented Chalet
- Walking Distance to the Beach
- One Allocated Parking Space
- Open Plan Lounge/ Diner
- Two Bedrooms

Tenure: EPC Rating: E
Council Tax Band: Deleted

We are currently awaiting Tenure details. For further information please contact the branch. Please note additional fees could be incurred for items such as leasehold packs.

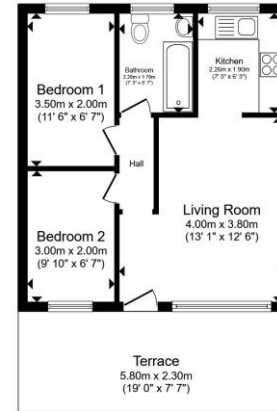

Total floor area 38.9 m² (419 sq.ft.) approx
This floor plan is for illustrative purposes only. It is not drawn to scale. Any measurements, floor areas (including any total floor area), openings and orientation are approximate. No details are guaranteed; they cannot be relied upon for any purpose and they do not form part of any agreement. No liability is taken for any error, omission or misstatement. A party must rely upon its own inspection(s). Powered by www.propertybox.io

£115,000



Please note the marker reflects the
postcode not the actual property

view this property online williamhbrown.co.uk/Property/NWM109883



Property Ref:
NWM109883 - 0003

1. MONEY LAUNDERING REGULATIONS Intending purchasers will be asked to produce identification documentation at a later stage and we would ask for your co-operation in order that there is no delay in agreeing the sale. 2. These particulars do not constitute part or all of an offer or contract. 3. The measurements indicated are supplied for guidance only and as such must be considered incorrect. Potential buyers are advised to recheck measurements before committing to any expense. 4. We have not tested any apparatus, equipment, fixtures or services and it is in the buyers interest to check the working condition of any appliances. 5. Where an EPC, or a Home Report (Scotland only) is held for this property, it is available for inspection at the branch by appointment. If you require a printed version of a Home Report, you will need to pay a reasonable production charge reflecting printing and other costs. 6. We are not able to offer an opinion either written or verbal on the content of these reports and this must be obtained from your legal representative. 7. Whilst we take care in preparing these reports, a buyer should ensure that his/her legal representative confirms as soon as possible all matters relating to title including the extent and boundaries of the property and other important matters before exchange of contracts.

William H Brown is a trading name of Sequence (UK) Limited which is registered in England and Wales under company number 4268443, Registered Office is Cumbria House, 16-20 Hockliffe Street, Leighton Buzzard, Bedfordshire, LU7 1GN. VAT Registration Number is 500 2481 05.

william h brown



01692 402861



NorthWalsham@williamhbrown.co.uk



16 Market Street, NORTH WALSHAM, Norfolk,
NR28 9BZ



williamhbrown.co.uk