



**Westbury Place North, Leeds LS10 3DE**

**welcome to**

## **Westbury Place North, Leeds**

PERFECT FTB/YOUNG FAMILY/INVESTMENT opportunity, THREE bedroom MID THROUGH TERRACE with GARDENS to front and REAR, LIVING ROOM, KITCHEN/DINER, HOUSE BATHROOM and ON STREET PARKING. Good access to motorway links.

### **Entrance Hall**

uPVC double glazed door to the front, gas central heating radiator, stairs leading to the first floor landing and door leading into the living room.

### **Living Room**

12' 10" x 12' 1" ( 3.91m x 3.68m )

uPVC double glazed bay window to the front, gas central heating radiator, electric fire and open access through to the kitchen/diner.

### **Kitchen/Diner**

9' 9" MAX x 12' 1" MAX ( 2.97m MAX x 3.68m MAX )

Having a fully fitted kitchen with a range of wall and base mounted units with complementary work surfaces over, incorporating sink and drainer, gas oven and gas hob, part tiled walls, space for a washing machine and fridge, uPVC double glazed window and door to the rear.

### **First Floor Landing**

Access to all three bedrooms, house bathroom and loft access.

### **Bedroom One**

11' 9" x 10' 9" ( 3.58m x 3.28m )

uPVC double glazed window and gas central heating radiator.

### **Bedroom Two**

9' x 11' 3" ( 2.74m x 3.43m )

uPVC double glazed window and gas central heating radiator.

### **Bedroom Three**

8' 9" x 6' 6" ( 2.67m x 1.98m )

uPVC double glazed window and gas central heating radiator.

### **Bathroom**

A three piece bathroom suite comprising of bath with taps and shower over, low level flush WC, wash hand basin, part tiled walls, uPVC double glazed window.

### **Exterior**

Pathway leading to the front door with paved area and wall boundary and to the rear is a lawned garden with paved area, outside tap, with wall and fence boundaries and access to internal storage cupboard. Shared ginnel with neighbouring property giving access to the rear.





***view this property online*** [williamhbrown.co.uk/Property/MLY111089](http://williamhbrown.co.uk/Property/MLY111089)





**welcome to**

## **Westbury Place North, Leeds**

- Three bedroom mid through terrace accommodation
- Perfect FTB/young family/investment
- Gardens to front and rear
- Kitchen/diner
- Good access to motorway links

Tenure: Freehold EPC Rating: C

Council Tax Band: A

**£150,000**

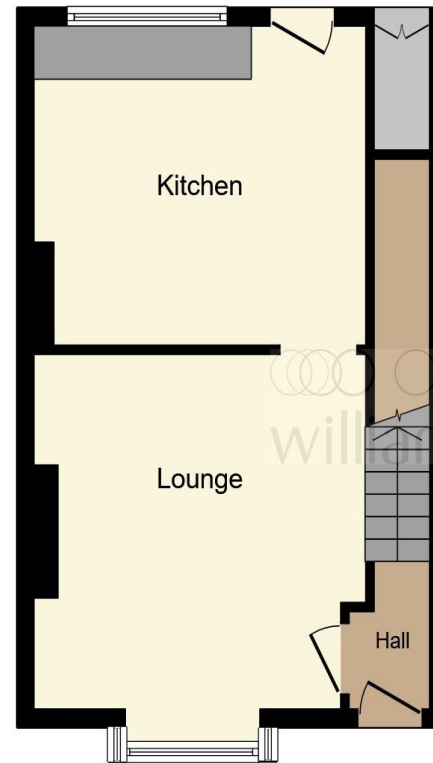

**Ground Floor**

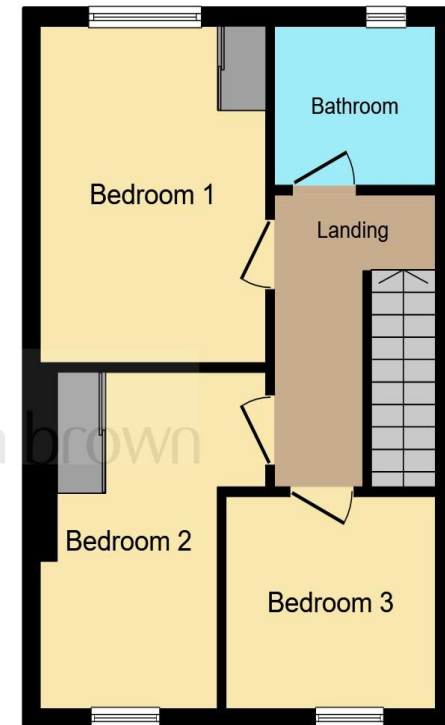

**First Floor**

This floor plan is for illustrative purposes only. It is not drawn to scale. Any measurements, floor areas (including any total floor area), openings and orientation are approximate. No details are guaranteed, they cannot be relied upon for any purpose and they do not form part of any agreement. No liability is taken for any error, omission or misstatement. A party must rely upon its own inspection(s). Powered by [www.focalagent.com](http://www.focalagent.com)

**view this property online** [williamhbrown.co.uk/Property/MLY111089](http://williamhbrown.co.uk/Property/MLY111089)



Property Ref:  
MLY111089 - 0005

1. MONEY LAUNDERING REGULATIONS Intending purchasers will be asked to produce identification documentation at a later stage and we would ask for your co-operation in order that there is no delay in agreeing the sale. 2. These particulars do not constitute part or all of an offer or contract. 3. The measurements indicated are supplied for guidance only and as such must be considered incorrect. Potential buyers are advised to recheck measurements before committing to any expense. 4. We have not tested any apparatus, equipment, fixtures or services and it is in the buyers interest to check the working condition of any appliances. 5. Where an EPC, or a Home Report (Scotland only) is held for this property, it is available for inspection at the branch by appointment. If you require a printed version of a Home Report, you will need to pay a reasonable production charge reflecting printing and other costs. 6. We are not able to offer an opinion either written or verbal on the content of these reports and this must be obtained from your legal representative. 7. Whilst we take care in preparing these reports, a buyer should ensure that his/her legal representative confirms as soon as possible all matters relating to title including the extent and boundaries of the property and other important matters before exchange of contracts.

William H Brown is a trading name of Sequence (UK) Limited which is registered in England and Wales under company number 4268443, Registered Office is Cumbria House, 16-20 Hockliffe Street, Leighton Buzzard, Bedfordshire, LU7 1GN. VAT Registration Number is 500 2481 05.

  
**william h brown**



**0113 253 7100**



[morley@williamhbrown.co.uk](mailto:morley@williamhbrown.co.uk)



80 Queen Street, Morley, LEEDS, West  
Yorkshire, LS27 9BP



**[williamhbrown.co.uk](http://williamhbrown.co.uk)**