



**Flaxton Street, Leeds LS11 6DH**

**welcome to**

## **Flaxton Street, Leeds**

Situated on a corner plot position is this THREE bedroom END TERRACE accommodation, with GARDENS to three sides and ON STREET PARKING, TWO RECEPTION ROOMS, FITTED KITCHEN, plenty of storage and a HOUSE BATHROOM. Total floor area 85 square metres.

### **Entrance Porch**

uPVC double glazed door to the front, double glazed door to the side and further sliding door and door leading into the hallway.

### **Entrance Hall**

Storage cupboards, stairs leading to the first floor landing with downstairs storage. Access into the downstairs WC, living room and kitchen.

### **Downstairs Wc**

Having a low level flush WC and wash hand basin.

### **Kitchen**

12' MAX x 8' 7" ( 3.66m MAX x 2.62m )

Has a fully fitted kitchen with a range of wall and base mounted units with complementary work surfaces over, incorporating sink and drainer with mixer tap, integrated oven with electric hob and fitted extractor fan, space for fridge freezer, dishwasher and washing machine, gas central heating radiator, uPVC double glazed window to the front and French doors leading into the dining room.

### **Living Room**

11' 5" x 11' 2" ( 3.48m x 3.40m )

uPVC double glazed window to the rear, gas central heating radiator, door leading through to the dining room.

### **Dining Room**

11' 4" x 6' 11" ( 3.45m x 2.11m )

uPVC double glazed French doors leading out to the rear, gas central heating radiator, French doors leading into the kitchen and door leading into the living room.

### **First Floor Landing**

Storage cupboard, further cupboard housing the gas central heating boiler, loft access. Access into all three bedrooms and the house bathroom.

### **Bedroom One**

14' 4" x 8' 5" ( 4.37m x 2.57m )

uPVC double glazed window to the rear, gas central heating radiator.

### **Bedroom Two**

11' 6" x 9' 8" ( 3.51m x 2.95m )

uPVC double glazed window to the rear, gas central heating radiator, fitted wardrobes.

### **Bedroom Three**

5' 8" x 9' 11" ( 1.73m x 3.02m )

uPVC double glazed window to the front, gas central heating radiator.

### **House Bathroom**

A three piece bathroom suite comprising of bath with taps and shower over, low level flush WC, wash hand basin, part tiled walls, chrome heated towel rail, uPVC double glazed window to the front.

### **Outside Workshop/Storage**

Great additional space or storage use with double glazed window and doors to the front and rear and having power and lighting.

### **Exterior**

Gardens to three sides with paved, graveled and artificial lawn areas, all with fence boundaries and gated access.







***view this property online*** [williamhbrown.co.uk/Property/MLY110587](http://williamhbrown.co.uk/Property/MLY110587)



welcome to

## Flaxton Street, Leeds

- Three bedroom end terrace accommodation
- Corner plot position
- Gardens to three sides
- Two reception rooms
- On street parking

Tenure: Freehold EPC Rating: C

**£165,000**

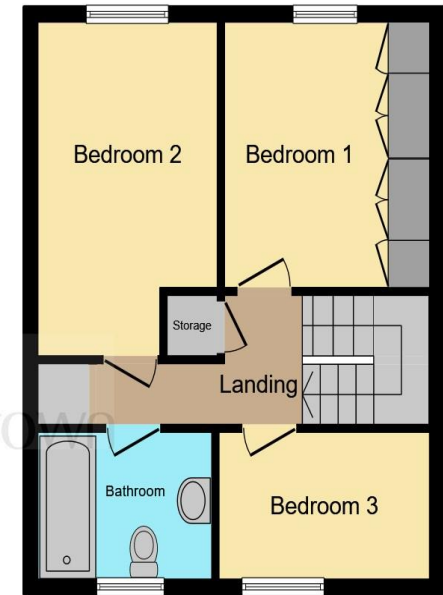

This floor plan is for illustrative purposes only. It is not drawn to scale. Any measurements, floor areas (including any total floor area), openings and orientation are approximate. No details are guaranteed, they cannot be relied upon for any purpose and they do not form part of any agreement. No liability is taken for any error, omission or misstatement. A party must rely upon its own inspection(s). Powered by [www.focalagent.com](http://www.focalagent.com)

**view this property online** [williamhbrown.co.uk/Property/MLY110587](http://williamhbrown.co.uk/Property/MLY110587)



Property Ref:  
MLY110587 - 0005

1. MONEY LAUNDERING REGULATIONS Intending purchasers will be asked to produce identification documentation at a later stage and we would ask for your co-operation in order that there is no delay in agreeing the sale. 2. These particulars do not constitute part or all of an offer or contract. 3. The measurements indicated are supplied for guidance only and as such must be considered incorrect. Potential buyers are advised to recheck measurements before committing to any expense. 4. We have not tested any apparatus, equipment, fixtures or services and it is in the buyers interest to check the working condition of any appliances. 5. Where an EPC, or a Home Report (Scotland only) is held for this property, it is available for inspection at the branch by appointment. If you require a printed version of a Home Report, you will need to pay a reasonable production charge reflecting printing and other costs. 6. We are not able to offer an opinion either written or verbal on the content of these reports and this must be obtained from your legal representative. 7. Whilst we take care in preparing these reports, a buyer should ensure that his/her legal representative confirms as soon as possible all matters relating to title including the extent and boundaries of the property and other important matters before exchange of contracts.

William H Brown is a trading name of Sequence (UK) Limited which is registered in England and Wales under company number 4268443, Registered Office is Cumbria House, 16-20 Hockliffe Street, Leighton Buzzard, Bedfordshire, LU7 1GN. VAT Registration Number is 500 2481 05.

  
william h brown



**0113 253 7100**



[morley@williamhbrown.co.uk](mailto:morley@williamhbrown.co.uk)



80 Queen Street, Morley, LEEDS, West  
Yorkshire, LS27 9BP



**[williamhbrown.co.uk](http://williamhbrown.co.uk)**