



Turnpike Lane, Red Lodge IP28 8LF

welcome to

Turnpike Lane, Red Lodge BURY ST. EDMUNDS

A modern and expansive THREE DOUBLE BEDROOM Scandinavian chalet style house which benefits from flexible living, large and light rooms and is spanning over 2300 sq ft. There is also a DOUBLE GARAGE and INSULATED OUTBUILDING with many potential uses.

Entrance Hall

16' max x 12' 4" max (4.88m max x 3.76m max)

With vaulted ceiling, exposed staircase leading to first floor and door to:

Kitchen/Breakfast Room

22' 10" max x 18' 5" max (6.96m max x 5.61m max)

With a fitted range of base units and drawers, matching wall units, inset one and a half bowl sink with mixer tap and drainer, built in eye level oven, separate induction hob with extractor over, space for American style fridge/freezer, window to front aspect and double doors opening to front.

Utility Room

11' 7" x 6' 10" (3.53m x 2.08m)

With a fitted range of base units, matching all units, space and plumbing for washing machine, space for tumble dryer, freestanding boiler, water softener, door to side and door returning to entrance hall.

Bathroom

12' 4" x 6' 5" (3.76m x 1.96m)

Fitted with a suite comprising Jacuzzi style bath tub with shower over, low level w.c, wash hand basin, bidet and window to side.

Bedroom 3

13' x 11' 8" (3.96m x 3.56m)

With window to side aspect.

Dining Room

13' x 10' 9" (3.96m x 3.28m)

With two windows to side aspect and opening to:

Living Room

22' 11" max x 17' 11" max (6.99m max x 5.46m max)

With two set of double doors opening to rear garden.





First Floor Landing

26' 2" max x 10' max (7.98m max x 3.05m max)

Galleried landing with two skylights and doors to:

Bedroom 1

22' 11" max x 17' 11" max (6.99m max x 5.46m max)

With window to front aspect, door to balcony and door to:

En-Suite

9' 6" x 6' 2" (2.90m x 1.88m)

Dressing Room

14' 7" max x 13' max (4.45m max x 3.96m max)

With a range of storage, skylight and door to:

Bedroom 2

22' 10" max x 18' 1" max (6.96m max x 5.51m max)

With window to rear aspect, door to balcony and door to:

En-Suite

13' 7" max x 3' 8" max (4.14m max x 1.12m max)

Fitted with a large shower enclosure, low level w.c and wash hand basin

Outside

To the front of the property is a block paved patio with parking area for two cars and gated access to the rear garden,

The rear garden is neatly landscaped, laid to block paving and artificial grass for ease of maintenance. There is a covered Veranda with bar and seating area.

Insulated Outbuilding

23' 8" x 18' 9" (7.21m x 5.71m)

With two rooms both with electric and water offering versatile usage.

Double Garage

22' 3" x 18' 9" (6.78m x 5.71m)

With up and over door and personal door to garden.

Agents Note

Heating to the property is served by oil. Please contact the branch for more details.

There is a easement on the title, please enquire with the branch.



view this property online williamhbrown.co.uk/Property/MDH108150



welcome to

Turnpike Lane, Red Lodge

- Circa 2300 Sq Ft
- Deceptively Spacious
- Detached Family Home
- Three Bedrooms
- Two En-suites

Tenure: Freehold

EPC Rating: C

Council Tax Band: F

guide price

£575,000



Ground Floor



First Floor

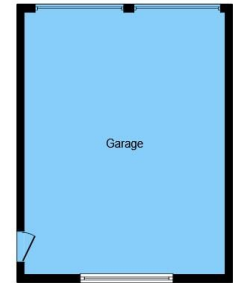
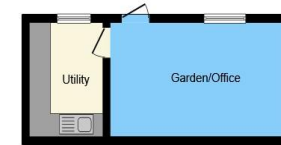

Outbuilding

This floor plan is for illustrative purposes only. It is not drawn to scale. Any measurements, floor areas (including any total floor area), openings and orientation are approximate. No details are guaranteed, they cannot be relied upon for any purpose and they do not form part of any agreement. No liability is taken for any error, omission or misstatement. A party must rely upon its own inspection(s). Powered by www.focalagent.com

view this property online williamhbrown.co.uk/Property/MDH108150



Property Ref:
MDH108150 - 0004

1. MONEY LAUNDERING REGULATIONS Intending purchasers will be asked to produce identification documentation at a later stage and we would ask for your co-operation in order that there is no delay in agreeing the sale. 2. These particulars do not constitute part or all of an offer or contract. 3. The measurements indicated are supplied for guidance only and as such must be considered incorrect. Potential buyers are advised to recheck measurements before committing to any expense. 4. We have not tested any apparatus, equipment, fixtures or services and it is in the buyers interest to check the working condition of any appliances. 5. Where an EPC, or a Home Report (Scotland only) is held for this property, it is available for inspection at the branch by appointment. If you require a printed version of a Home Report, you will need to pay a reasonable production charge reflecting printing and other costs. 6. We are not able to offer an opinion either written or verbal on the content of these reports and this must be obtained from your legal representative. 7. Whilst we take care in preparing these reports, a buyer should ensure that his/her legal representative confirms as soon as possible all matters relating to title including the extent and boundaries of the property and other important matters before exchange of contracts.

William H Brown is a trading name of Sequence (UK) Limited which is registered in England and Wales under company number 4268443, Registered Office is Cumbria House, 16-20 Hockliffe Street, Leighton Buzzard, Bedfordshire, LU7 1GN. VAT Registration Number is 500 2481 05.



william h brown



01638 713274



Mildenhall@williamhbrown.co.uk



17 High Street, Mildenhall, BURY ST.
EDMUNDS, Suffolk, IP28 7EQ



williamhbrown.co.uk