



Birch Walk, RAF Lakenheath IP27 9RA

welcome to

Birch Walk, Raf Lakenheath Brandon

A well presented house located on the Popular Lord's Walk Development with two double bedrooms, modern updated kitchen and offered to the market with no onward chain.

Living Room

18' 8" x 10' 8" (5.69m x 3.25m)

With stairs leading to first floor, storage cupboard and doors to:

Dining Room

10' 4" x 8' 3" (3.15m x 2.51m)

With tiled flooring, storage cupboard, window and door to rear and opening to:

Kitchen

Fitted with a modern range of base units and drawers, matching wall units, inset sink and drainer unit, built in under oven with hob and extractor over, space for washing machine, tiled flooring, spot lighting and double glazed window to rear aspect.





First Floor Landing

With storage cupboard and doors to:

Bedroom 1

14' x 9' 1" (4.27m x 2.77m)

With built in wardrobe, further large storage cupboard, window to front aspect and door to:

Dressing Room/Study

With slanted ceiling and window to side aspect.

Bedroom 2

12' x 10' 4" (3.66m x 3.15m)

With fitted wardrobe and double glazed window to rear aspect.

Bathroom

Fitted with a suite comprising bath with shower over, wash hand basin, W.C, fully tiled, shaver point and window to rear.

Outside

To the front of the property is a driveway with off road parking for two cars, by the front door there is external storage.

The rear garden has an initial patio area with the remainder being laid to lawn and fully enclosed by fencing.



view this property online williamhbrown.co.uk/Property/MDH108394



welcome to

Birch Walk, Raf Lakenheath Brandon

- No Onward Chain
- Updated & Improved
- Modern Kitchen
- Two Double Bedrooms
- Circa 900 Sq Ft

Tenure: Freehold

EPC Rating: D

guide price

£210,000

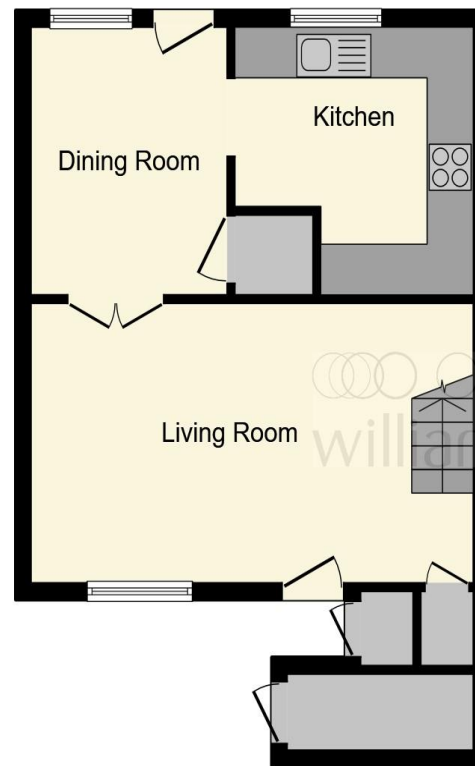

Ground Floor



First Floor

This floor plan is for illustrative purposes only. It is not drawn to scale. Any measurements, floor areas (including any total floor area), openings and orientation are approximate. No details are guaranteed, they cannot be relied upon for any purpose and they do not form part of any agreement. No liability is taken for any error, omission or misstatement. A party must rely upon its own inspection(s). Powered by www.focalagent.com

view this property online williamhbrown.co.uk/Property/MDH108394



Property Ref:
MDH108394 - 0004

1. MONEY LAUNDERING REGULATIONS Intending purchasers will be asked to produce identification documentation at a later stage and we would ask for your co-operation in order that there is no delay in agreeing the sale. 2. These particulars do not constitute part or all of an offer or contract. 3. The measurements indicated are supplied for guidance only and as such must be considered incorrect. Potential buyers are advised to recheck measurements before committing to any expense. 4. We have not tested any apparatus, equipment, fixtures or services and it is in the buyers interest to check the working condition of any appliances. 5. Where an EPC, or a Home Report (Scotland only) is held for this property, it is available for inspection at the branch by appointment. If you require a printed version of a Home Report, you will need to pay a reasonable production charge reflecting printing and other costs. 6. We are not able to offer an opinion either written or verbal on the content of these reports and this must be obtained from your legal representative. 7. Whilst we take care in preparing these reports, a buyer should ensure that his/her legal representative confirms as soon as possible all matters relating to title including the extent and boundaries of the property and other important matters before exchange of contracts.

William H Brown is a trading name of Sequence (UK) Limited which is registered in England and Wales under company number 4268443, Registered Office is Cumbria House, 16-20 Hockliffe Street, Leighton Buzzard, Bedfordshire, LU7 1GN. VAT Registration Number is 500 2481 05.

william h brown



01638 713274



Mildenhall@williamhbrown.co.uk



17 High Street, Mildenhall, BURY ST.
EDMUNDS, Suffolk, IP28 7EQ



williamhbrown.co.uk