



Holly Grove, Wath-Upon-Dearne Rotherham S63 7PJ

welcome to

Holly Grove, Wath-Upon-Dearne Rotherham

Discover this 3-bed detached dormer bungalow, situated in the highly sought-after Sandygate area of Wath. Perfectly placed for amenities, schools & shops. Whilst in need of modernisation, this property offers a fantastic opportunity to create a dream family home. With extensive gardens & 2 garages!





Ground Floor

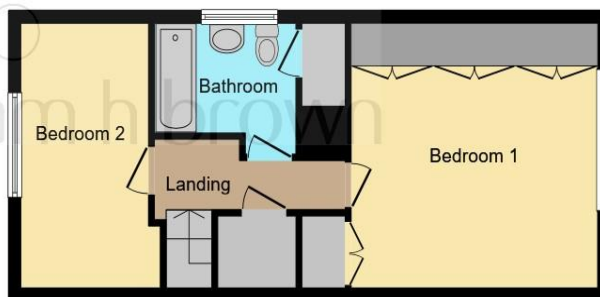

First Floor

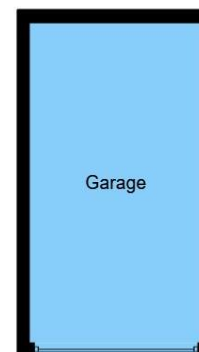

Garage

Ground Floor:

Entrance Hallway

Downstairs W.C

Lounge

16' 11" x 11' 10" (5.16m x 3.61m)

Dining Room

9' 11" x 9' 11" into recess (3.02m x 3.02m into recess)

Kitchen/Diner

15' 11" x 11' 9" into recess (4.85m x 3.58m into recess)

Bedroom Three

8' 9" x 12' 8" (2.67m x 3.86m)

1st Floor:

Landing

Bedroom One

14' 1" x 9' 10" to wardrobe (4.29m x 3.00m to wardrobe)

Bedroom Two

7' 6" x 12' 2" (2.29m x 3.71m)

Bathroom

Exterior:

Garage 1

Garage 2

This floor plan is for illustrative purposes only. It is not drawn to scale. Any measurements, floor areas (including any total floor area), openings and orientation are approximate. No details are guaranteed, they cannot be relied upon for any purpose and they do not form part of any agreement. No liability is taken for any error, omission or misstatement. A party must rely upon its own inspection(s). Powered by www.focalagent.com

welcome to

Holly Grove, Wath-Upon-Dearne Rotherham

- Offers in the Region of £275 000 - 3 bedroom detached dorma bungalow. EPC D. Council Tax D
- Extremely sought after location in Wath
- Excellently placed for local amenities, schools, shops & transport links
- Spacious throughout - lounge, dining room, kitchen/diner, d/stairs W.C
- 2 Driveways providing ample off street parking

Tenure: Freehold EPC Rating: D

offers in the region of

£275,000



Please note the marker reflects the postcode not the actual property

view this property online williamhbrown.co.uk/Property/MXB117987



Property Ref:
MXB117987 - 0008

1. MONEY LAUNDERING REGULATIONS Intending purchasers will be asked to produce identification documentation at a later stage and we would ask for your co-operation in order that there is no delay in agreeing the sale. 2. These particulars do not constitute part or all of an offer or contract. 3. The measurements indicated are supplied for guidance only and as such must be considered incorrect. Potential buyers are advised to recheck measurements before committing to any expense. 4. We have not tested any apparatus, equipment, fixtures or services and it is in the buyers interest to check the working condition of any appliances. 5. Where an EPC, or a Home Report (Scotland only) is held for this property, it is available for inspection at the branch by appointment. If you require a printed version of a Home Report, you will need to pay a reasonable production charge reflecting printing and other costs. 6. We are not able to offer an opinion either written or verbal on the content of these reports and this must be obtained from your legal representative. 7. Whilst we take care in preparing these reports, a buyer should ensure that his/her legal representative confirms as soon as possible all matters relating to title including the extent and boundaries of the property and other important matters before exchange of contracts.

William H Brown is a trading name of Sequence (UK) Limited which is registered in England and Wales under company number 4268443, Registered Office is Cumbria House, 16-20 Hockliffe Street, Leighton Buzzard, Bedfordshire, LU7 1GN. VAT Registration Number is 500 2481 05.



william h brown



01709 583267



mexborough@williamhbrown.co.uk



4 Main Street, MEXBOROUGH, South Yorkshire,
S64 9DW



williamhbrown.co.uk