



**95 Deerfield Road, March PE15 9AD**

**welcome to**

**Deerfield Road, March**

\*\* End Terraced Bungalow \*\* NO ONWARD CHAIN \*\* Gas Central Heating \*\* Ample Parking \*\* Convenient to Town Centre & Park \*\*



**Entrance Porch**

Tiled floor.

**Entrance Door**

part glazed to

**Hall**

Radiator.

**Lounge**

13' 8" x 12' 7" ( 4.17m x 3.84m )

(measured into sealed bay window to front.) Wall lights. Radiator. Coved ceiling. Fire surround. Glazed door to hall.

**Kitchen**

11' 3" x 9' 10" ( 3.43m x 3.00m )

Single drainer stainless steel sink. Worktop surfaces with cupboards and drawers under. Wall cupboards. Glazed door from hall. Sealed unit double glazed window to rear. Serving hatch to lounge. Store cupboard. Radiator. Door to rear covered entrance with doors to side and rear.

**Utility Room**

8' 2" x 7' 3" ( 2.49m x 2.21m )

Single drainer stainless steel sink. Worktop surfaces. Plumbing for washing machine. Single glazed window to rear. Store cupboards. Gas central heating boiler.

**Bedroom One**

9' 7" x 9' 3" ( 2.92m x 2.82m )

Sealed unit double glazed window to front. Radiator. Range of wardrobe cupboards to one wall.

**Bedroom Two**

11' 2" x 9' 8" ( 3.40m x 2.95m )

Sealed unit double glazed window to rear. Radiator. Bed lights.

**Bathroom**

Frosted window to rear. Panelled bath with mixer shower tap over. Pedestal wash hand basin. Low level wc. Store cupboard. Loft access. Electric wall heater.

**Outside**

The property has an open plan gravelled front garden with paths leading to front and side. There is a gravelled side drive leading to the covered car port and additional gravelled side parking area.

Gated access lead to the rear gardens with patio, paths and being predominately laid to gravel for ease of maintenance. Timber store.

**Please Note**

It is our understanding that the Property is not registered at the Land Registry which is the case with a significant proportion of land across England and Wales. Your conveyancer will take the necessary steps and advise you accordingly.



**view this property online** [williamhbrown.co.uk/Property/MCH111053](http://williamhbrown.co.uk/Property/MCH111053)



welcome to

## Deerfield Road, March

- End Terrace Bungalow
- Two Bedrooms
- Town Centre Location
- NO ONWARD CHAIN
- Ample Parking

Tenure: Freehold  
EPC Rating: Awaited

**£190,000**

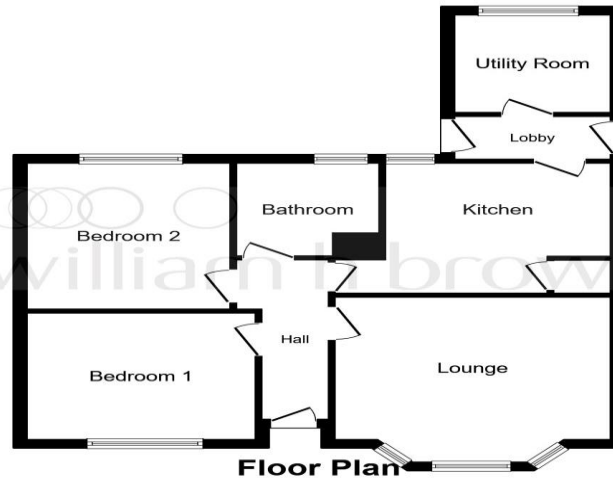

This floor plan is for illustrative purposes only. It is not drawn to scale. Any measurements, floor areas (including any total floor area), openings and orientation are approximate. No details are guaranteed, they cannot be relied upon for any purpose and they do not form part of any agreement. No liability is taken for any error, omission or misstatement. A party must rely upon its own inspection(s). Plan produced for William H Brown. Powered by www.focalagent.com



Please note the marker reflects the postcode not the actual property

**view this property online** [williamhbrown.co.uk/Property/MCH111053](http://williamhbrown.co.uk/Property/MCH111053)

**see all our properties on** [zoopla.co.uk](http://zoopla.co.uk) | [rightmove.co.uk](http://rightmove.co.uk) | [williamhbrown.co.uk](http://williamhbrown.co.uk)



Property Ref:  
MCH111053 - 0003

1. MONEY LAUNDERING REGULATIONS Intending purchasers will be asked to produce identification documentation at a later stage and we would ask for your co-operation in order that there is no delay in agreeing the sale. 2. These particulars do not constitute part or all of an offer or contract. 3. The measurements indicated are supplied for guidance only and as such must be considered incorrect. Potential buyers are advised to recheck measurements before committing to any expense. 4. We have not tested any apparatus, equipment, fixtures or services and it is in the buyers interest to check the working condition of any appliances. 5. Where an EPC, or a Home Report (Scotland only) is held for this property, it is available for inspection at the branch by appointment. If you require a printed version of a Home Report, you will need to pay a reasonable production charge reflecting printing and other costs. 6. We are not able to offer an opinion either written or verbal on the content of these reports and this must be obtained from your legal representative. 7. Whilst we take care in preparing these reports, a buyer should ensure that his/her legal representative confirms as soon as possible all matters relating to title including the extent and boundaries of the property and other important matters before exchange of contracts.



william h brown



**01354 654545**



[march@williamhbrown.co.uk](mailto:march@williamhbrown.co.uk)



34 High Street, MARCH, Cambridgeshire, PE15 9JR



[williamhbrown.co.uk](http://williamhbrown.co.uk)