



Plot 4 The Osiers, Edwards Way, Manera PE15 0HY

The Maple

Dimensions provided are all taken to face of plaster unless stated otherwise.



Ground Floor

Lounge/Dining – 4620 x 4430mm excluding cupboard

Kitchen – 3720 x 2345mm

WC – 1015 x 2080mm

ST – 885 x 965mm raised floor

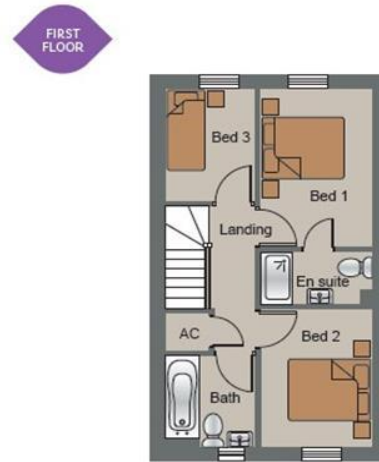

First Floor

Bed 1 – 3660 x 2500mm

Bed 2 – 3170 x 2495mm

Bed 3 – 2600 x 2000mm

Bath – 1995 x 2060mm

En suite – 1200 x 2475mm

AC – 945 x 1712mm

Gross internal floor area – 78.5 m²

*Diminishing under stairs

All images, photographs and dimensions are for illustrative purposes only and are not intended to be relied upon for, nor to form part of, any contract unless specifically incorporated in writing into the contract. The dimensions given are illustrative for this house type, individual properties may differ and dimensions should not be used for carpet or flooring sizes, appliance spaces or items of furniture.

welcome to

The Osiers Edwards Way, Manea

- BRAND NEW Link Detached House
- Three Bedrooms
- En Suite to Bedroom One
- Garage
- Floor Coverings Throughout

Tenure: Freehold EPC Rating: Exempt

£309,995

Lounge/ Dining Room

15' 2" x 14' 5" excl. cupboard (4.62m x 4.39m excl. cupboard)

Kitchen

12' 2" x 7' 7" (3.71m x 2.31m)

W.C

First Floor

Bedroom One

12' x 8' 2" (3.66m x 2.49m)

En Suite

8' 11" x 3' 9" (2.72m x 1.14m)

Bedroom Two

10' 4" x 8' 2" (3.15m x 2.49m)

Bedroom Three

8' 5" x 6' 6" (2.57m x 1.98m)

Bathroom

view this property online williamhbrown.co.uk/Property/MCH113703



Property Ref:

MCH113703 - 0004

1. MONEY LAUNDERING REGULATIONS Intending purchasers will be asked to produce identification documentation at a later stage and we would ask for your co-operation in order that there is no delay in agreeing the sale. 2. These particulars do not constitute part or all of an offer or contract. 3. The measurements indicated are supplied for guidance only and as such must be considered incorrect. Potential buyers are advised to recheck measurements before committing to any expense. 4. We have not tested any apparatus, equipment, fixtures or services and it is in the buyers interest to check the working condition of any appliances. 5. Where an EPC, or a Home Report (Scotland only) is held for this property, it is available for inspection at the branch by appointment. If you require a printed version of a Home Report, you will need to pay a reasonable production charge reflecting printing and other costs. 6. We are not able to offer an opinion either written or verbal on the content of these reports and this must be obtained from your legal representative. 7. Whilst we take care in preparing these reports, a buyer should ensure that his/her legal representative confirms as soon as possible all matters relating to title including the extent and boundaries of the property and other important matters before exchange of contracts.

William H Brown is a trading name of Sequence (UK) Limited which is registered in England and Wales under company number 4268443, Registered Office is Cumbria House, 16-20 Hockliffe Street, Leighton Buzzard, Bedfordshire, LU7 1GN. VAT Registration Number is 500 2481 05.



william h brown



01354 654545



march@williamhbrown.co.uk



34 High Street, MARCH, Cambridgeshire, PE15 9JR



williamhbrown.co.uk