



Bevills Close, Doddington PE15 0TT

welcome to

Bevills Close, Doddington

**** NO ONWARD CHAIN **** Three Bedroom Semi Detached House - Gas Fired Central Heating
Off Road Parking - Generous Rear Garden - Village Location



Entrance Door

to

Hall

Door to side. Radiator.

Lounge

14' 3" max x 11' 1" max (4.34m max x 3.38m max)

Two windows to front. Stairs leading off. Radiator. TV point.

Kitchen

10' 6" x 8' 7" (3.20m x 2.62m)

Open plan to Lounge. Window to rear. Single drainer sink with mixer taps, 1 1/4 bowl. Radiator. Electric oven, gas hob and cooker hood above. Wall units with matching work surfaces and storage under.

Stairs To First Floor Landing

Window to side. Storage cupboard housing gas central heating boiler. Loft access.

Bedroom One

11' 2" x 9' 10" (3.40m x 3.00m)

Window to front. Radiator.

Bedroom Two

12' 8" x 6' 8" (3.86m x 2.03m)

Window to rear. Radiator.

Bedroom Three

7' 6" x 7' 2" (2.29m x 2.18m)

Window to rear. Radiator. Low level wc. Pedestal wash hand basin.

Wet Room (Ground Floor)

Window to rear. Low level wc. Shower area. Pedestal wash hand basin. Extractor fan. Radiator.

Outside

Front garden is open plan, laid to gravel for multi vehicle off road parking.

Rear garden is enclosed with patio area, pond and outside tap.

Summer House - 11ft 6ins x 7ft 9ins. Electric and lighting laid on. Door and window to front.



view this property online williamhbrown.co.uk/Property/MCH113511



welcome to

Bevills Close, Doddington

- Semi Detached House
- Three Bedrooms
- Gas Central Heating
- Recently Fitted Kitchen
- Generous Rear Garden
- Village Location
- Off Road Parking
- NO ONWARD CHAIN

Tenure: Freehold
EPC Rating: Awaited

£205,000



Ground Floor

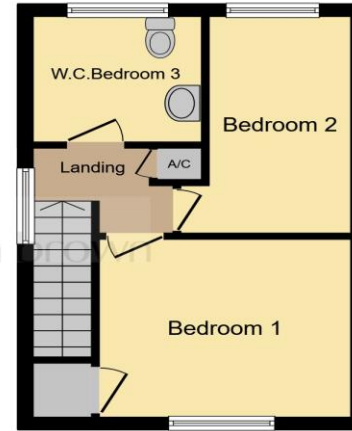

First Floor

This floor plan is for illustrative purposes only. It is not drawn to scale. Any measurements, floor areas (including any total floor area), openings and orientation are approximate. No details are guaranteed, they cannot be relied upon for any purpose and they do not form part of any agreement. No liability is taken for any error, omission or misstatement. A party must rely upon its own inspection(s). Powered by www.focalagent.com



Please note the marker reflects the postcode not the actual property

view this property online [williamhbrown.co.uk/Property/MCH113511](https://www.williamhbrown.co.uk/Property/MCH113511)



Property Ref:
MCH113511 - 0002

1. MONEY LAUNDERING REGULATIONS Intending purchasers will be asked to produce identification documentation at a later stage and we would ask for your co-operation in order that there is no delay in agreeing the sale. 2. These particulars do not constitute part or all of an offer or contract. 3. The measurements indicated are supplied for guidance only and as such must be considered incorrect. Potential buyers are advised to recheck measurements before committing to any expense. 4. We have not tested any apparatus, equipment, fixtures or services and it is in the buyers interest to check the working condition of any appliances. 5. Where an EPC, or a Home Report (Scotland only) is held for this property, it is available for inspection at the branch by appointment. If you require a printed version of a Home Report, you will need to pay a reasonable production charge reflecting printing and other costs. 6. We are not able to offer an opinion either written or verbal on the content of these reports and this must be obtained from your legal representative. 7. Whilst we take care in preparing these reports, a buyer should ensure that his/her legal representative confirms as soon as possible all matters relating to title including the extent and boundaries of the property and other important matters before exchange of contracts.

William H Brown is a trading name of Sequence (UK) Limited which is registered in England and Wales under company number 4268443, Registered Office is Cumbria House, 16-20 Hockliffe Street, Leighton Buzzard, Bedfordshire, LU7 1GN. VAT Registration Number is 500 2481 05.



william h brown



01354 654545



march@williamhbrown.co.uk



34 High Street, MARCH, Cambridgeshire, PE15 9JR



[williamhbrown.co.uk](https://www.williamhbrown.co.uk)