



Homedene House Seldown Road, POOLE BH15 1UJ

welcome to

Homedene House Seldown Road, POOLE

This self-contained flat offers a perfect living space for those who wish to have ease of access to the many parks and amenities provided in central Poole, with the security of a property in a secure development.



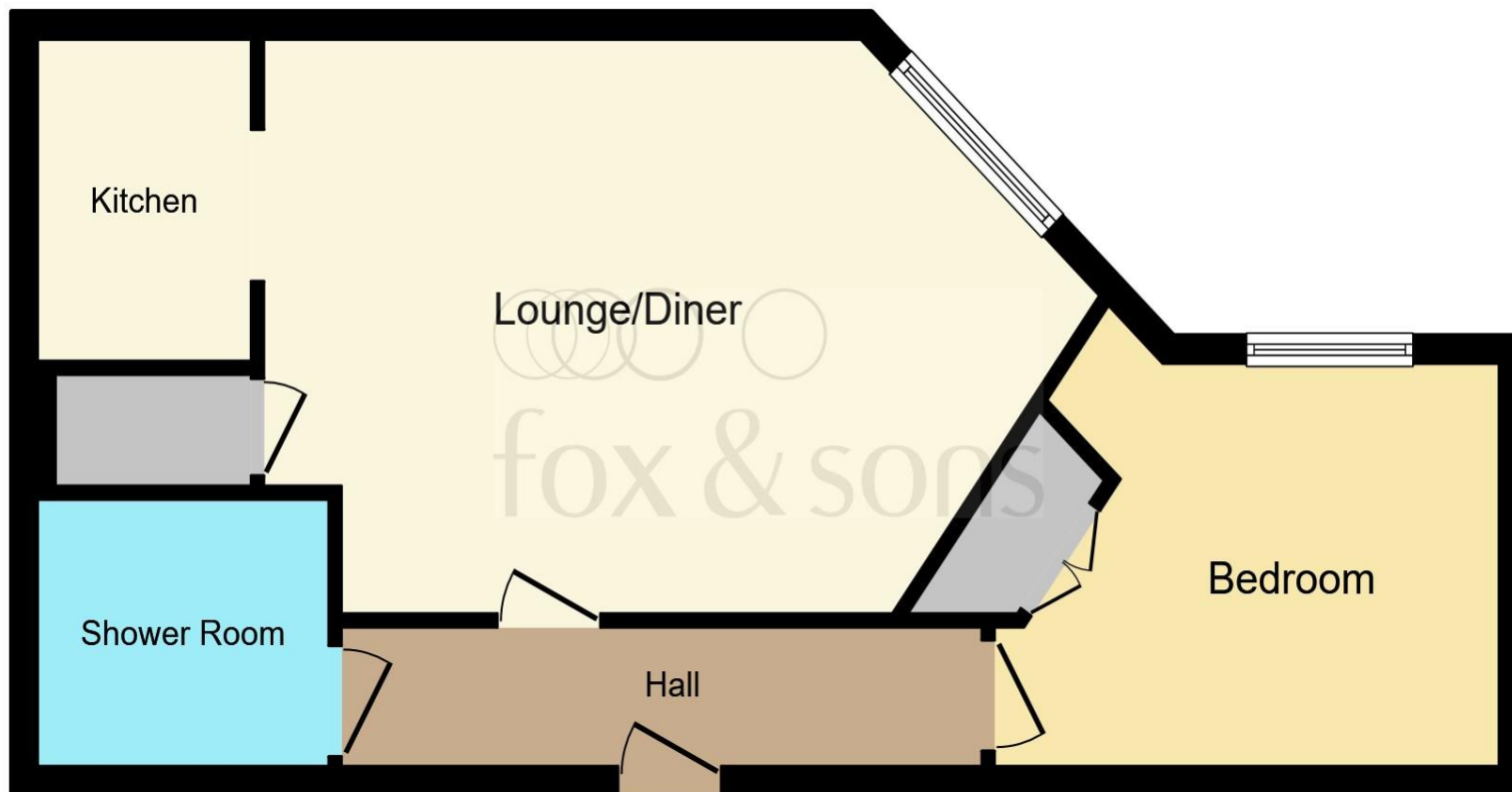

Lounge / Diner
20' 7" x 12' 9" (6.27m x 3.89m)

Kitchen
7' 5" x 5' 1" (2.26m x 1.55m)

Bedroom
11' x 8' 8" (3.35m x 2.64m)

Bathroom

This floorplan is for illustrative purposes only and is not drawn to scale. Measurements, floor-areas, openings and orientations are approximate. They should not be relied upon for any purpose and do not form any part of an agreement. No liability is taken for any error or mis-statement. All parties must rely on their own inspections.

welcome to

Homedene House Seldown Road, POOLE

- NO FORWARD CHAIN
- RETIREMENT PROPERTY
- GREAT CONDITION
- TOWN CENTRE LOCATION
-

Tenure: Leasehold EPC Rating: C

guide price

£95,000



Please note the marker reflects the postcode not the actual property

view this property online fox-and-sons.co.uk/Property/PLE106240

This is a Leasehold property with details as follows; Term of Lease 98 years from 01 Sep 1981. Should you require further information please contact the branch. Please Note additional fees could be incurred for items such as Leasehold packs.



Property Ref:
PLE106240 - 0014

1. MONEY LAUNDERING REGULATIONS Intending purchasers will be asked to produce identification documentation at a later stage and we would ask for your co-operation in order that there is no delay in agreeing the sale. 2. These particulars do not constitute part or all of an offer or contract. 3. The measurements indicated are supplied for guidance only and as such must be considered incorrect. Potential buyers are advised to recheck measurements before committing to any expense. 4. We have not tested any apparatus, equipment, fixtures or services and it is in the buyers interest to check the working condition of any appliances. 5. Where an EPC, or a Home Report (Scotland only) is held for this property, it is available for inspection at the branch by appointment. If you require a printed version of a Home Report, you will need to pay a reasonable production charge reflecting printing and other costs. 6. We are not able to offer an opinion either written or verbal on the content of these reports and this must be obtained from your legal representative. 7. Whilst we take care in preparing these reports, a buyer should ensure that his/her legal representative confirms as soon as possible all matters relating to title including the extent and boundaries of the property and other important matters before exchange of contracts.

fox & sons



01202 672736



Poole@fox-and-sons.co.uk



80 High Street, POOLE, Dorset, BH15 1DB



fox-and-sons.co.uk