



Stableford Close, Shepshed

welcome to

Stableford Close, Shepshed

****FOR SALE**** Deceptively spacious three-bedroom semi-detached property in Shepshed. Property is double glazed and has gas fired central heating, lounge, ground floor wc and three well-proportioned bedrooms. Call now 01509 214686!

Entrance

Entrance is via a UPVC double glazed front door into the hallway. Hallway has a radiator, stairs off to the first floor, access to ground floor wc, lounge and kitchen.

Ground Floor Wc

Ground floor wc has a low level wc, vanity hand wash basin with tiled splashbacks, vinyl flooring and a upvc double glazed window to the side elevation.

Lounge

16' 4" x 12' (4.98m x 3.66m)
Lounge has carpeted flooring, radiator, upvc double glazed windows to the front and side elevation, coving to the ceiling and understairs storage.

Kitchen

13' 5" x 8' 9" (4.09m x 2.67m)
Kitchen has vinyl flooring and is fitted with base and wall mounted units with roll edge work surfaces, extractor fan, upvc double glazed doors to the rear, a radiator, space and plumbing for a washing machine and tumble dryer, space for a free-standing fridge freezer, sink with drainer, integrated oven and gas hob.

Bedroom One

12' 7" x 9' (3.84m x 2.74m)
Bedroom one has laminate flooring, upvc double glazed window to the rear elevation, fitted wardrobes, a radiator and access to the loft which is partially boarded.

Bedroom Two

11' 11" x 9' 1" (3.63m x 2.77m)
Bedroom two has laminate flooring, upvc double glazed window to the side elevation and a radiator.

Bedroom Three

7' x 6' 9" (2.13m x 2.06m)
Bedroom three has laminate flooring, upvc double glazed window to the front and a radiator.

Bathroom

Bathroom has a three-piece suite comprising of panel bath with shower over, tiled splashbacks, low level wc, wash hand basin located in a vanity unit, a Bluetooth mirror, heated towel rail, vinyl flooring, an airing cupboard which houses the conventional boiler.

Outside

To the front of the property there is a gravelled garden with a pathway leading to the front door. To the rear of the property there is an artificial lawn and decking with lighting, a brick-built barbecue and fenced to all borders.

Garage

16' 8" x 8' 5" (5.08m x 2.57m)
Garage is located to the side of the property, with an up and over door.





view this property online williamhbrown.co.uk/Property/LBH114704



welcome to

Stableford Close, Shepshed Loughborough

- Three Bedroom Semi Detached Property
- Double glazed and Gas Fired Central Heating
- Ground Floor wc
- Three well-proportioned bedrooms
- First floor bathroom

Tenure: Freehold EPC Rating: C

offers over

£260,000



Ground Floor

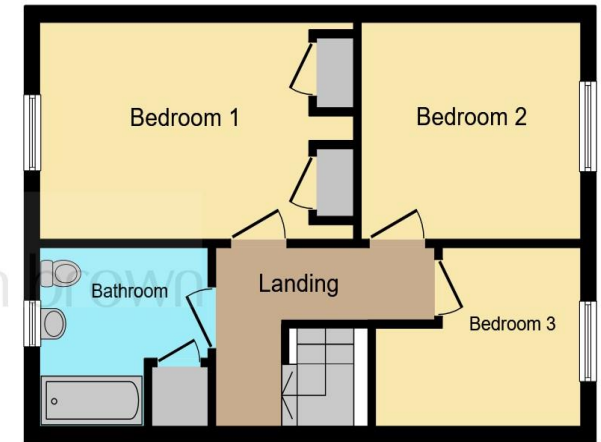

First Floor

This floor plan is for illustrative purposes only. It is not drawn to scale. Any measurements, floor areas (including any total floor area), openings and orientation are approximate. No details are guaranteed, they cannot be relied upon for any purpose and they do not form part of any agreement. No liability is taken for any error, omission or misstatement. A party must rely upon its own inspection(s). Powered by www.focalagent.com

view this property online williamhbrown.co.uk/Property/LBH114704



Property Ref:
LBH114704 - 0005

1. MONEY LAUNDERING REGULATIONS Intending purchasers will be asked to produce identification documentation at a later stage and we would ask for your co-operation in order that there is no delay in agreeing the sale. 2. These particulars do not constitute part or all of an offer or contract. 3. The measurements indicated are supplied for guidance only and as such must be considered incorrect. Potential buyers are advised to recheck measurements before committing to any expense. 4. We have not tested any apparatus, equipment, fixtures or services and it is in the buyers interest to check the working condition of any appliances. 5. Where an EPC, or a Home Report (Scotland only) is held for this property, it is available for inspection at the branch by appointment. If you require a printed version of a Home Report, you will need to pay a reasonable production charge reflecting printing and other costs. 6. We are not able to offer an opinion either written or verbal on the content of these reports and this must be obtained from your legal representative. 7. Whilst we take care in preparing these reports, a buyer should ensure that his/her legal representative confirms as soon as possible all matters relating to title including the extent and boundaries of the property and other important matters before exchange of contracts.

William H Brown is a trading name of Sequence (UK) Limited which is registered in England and Wales under company number 4268443, Registered Office is Cumbria House, 16-20 Hockliffe Street, Leighton Buzzard, Bedfordshire, LU7 1GN. VAT Registration Number is 500 2481 05.

william h brown



01509 214686



loughborough@williamhbrown.co.uk



22-23 Swan Street, LOUGHBOROUGH,
Leicestershire, LE11 5BL



williamhbrown.co.uk