



Old Ashby Road, Loughborough

welcome to

Old Ashby Road, Loughborough

We are pleased to offer for sale this three-bedroom semi-detached occupying a position within the popular university town of Loughborough. Internal viewing is highly recommended to appreciate the accommodation on offer. Call 01509 214686.

Auctioneer's Comments

This property is offered through Modern Method of Auction. Should you view, offer or bid your data will be shared with the Auctioneer, iamsold Limited. This method requires both parties to complete the transaction within 56 days, allowing buyers to proceed with mortgage finance (subject to lending criteria, affordability and survey).

The buyer is required to sign a reservation agreement and make payment of a non-refundable Reservation Fee of 4.5% of the purchase price including VAT, subject to a minimum of £6600.00 including VAT. This fee is paid in addition to purchase price and will be considered as part of the chargeable consideration for the property in the calculation for stamp duty liability. Buyers will be required to complete an identification process with iamsold and provide proof of how the purchase would be funded.

The property has a Buyer Information Pack containing documents about the property. The documents may not tell you everything you need to know, so you must complete your own due diligence before bidding. A sample of the Reservation Agreement and terms and conditions are contained within this pack. The buyer will also make payment of £300 inc VAT towards the preparation cost of the pack.

The estate agent and auctioneer may recommend the services of other providers to you, in which they will be paid for the referral. These services are optional, and you will be advised of any payment, in writing before any services are accepted. Listing is subject to a start price and undisclosed reserve price that can change.

Entrance

Property is entered via a upvc double glazed door into the hallway providing access to the kitchen/diner, lounge and stairs rising to the first floor.

Lounge

18' 1" x 10' 7" (5.51m x 3.23m)
Lounge has a upvc double glazed window to the rear, a feature fireplace and a radiator.

Kitchen/Diner

17' 9" x 14' 3" (5.41m x 4.34m)
Kitchen/Diner has carpeted flooring, a range of built in wall and base units, space for a cooker, a radiator, upvc door to the side, plumbing for a washing machine and under stairs storage.

Bedroom One

11' 5" x 12' 2" (3.48m x 3.71m)
Bedroom one has carpeted flooring, a radiator and a UPVC double glazed window to the front elevation.

Bedroom Two

10' 6" x 9' 6" (3.20m x 2.90m)
Bedroom two has carpeted flooring, a UPVC double glazed window to the rear elevation and a storage cupboard.



Bedroom Three

8' 2" x 7' 6" (2.49m x 2.29m)

Bedroom three has carpeted flooring, a UPVC double glazed window to the front elevation and a radiator.

Bathroom

Bathroom has carpeted flooring, a panelled bath with shower over, wash hand basin, a upvc double glazed window to the front elevation and a radiator.

Separate Wc

Separate wc has a low level wc and a radiator.

Outside

To the front of the property there is a front garden which is laid to lawn and on street parking. To the rear of the property there is an extensive rear garden which is laid to lawn and fenced to boundaries with an outside water tap.



view this property online williamhbrown.co.uk/Property/LBH114749



welcome to

Old Ashby Road, Loughborough

- Sale by Modern Auction (T&Cs apply)
- Subject to an undisclosed Reserve Price
- Buyers fees apply
- No Upward Chain
- Private Rear Garden

Tenure: Freehold EPC Rating: Awaited

guide price

£155,000

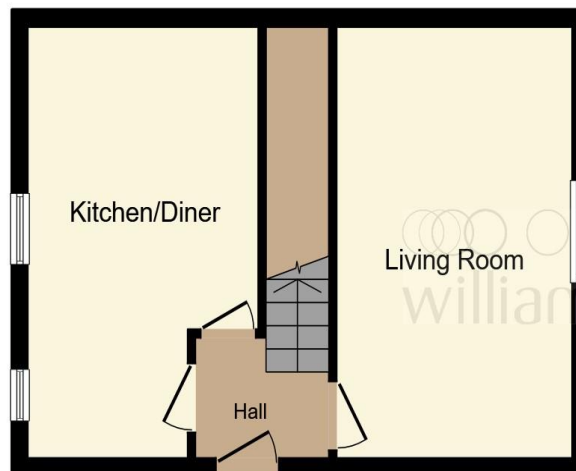

Ground Floor

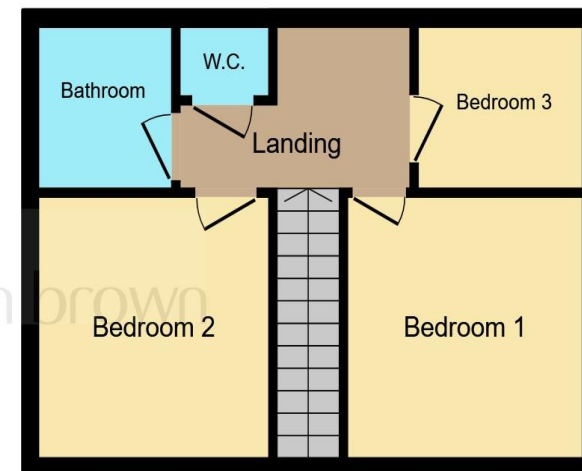

First Floor

This floor plan is for illustrative purposes only. It is not drawn to scale. Any measurements, floor areas (including any total floor area), openings and orientation are approximate. No details are guaranteed, they cannot be relied upon for any purpose and they do not form part of any agreement. No liability is taken for any error, omission or misstatement. A party must rely upon its own inspection(s). Powered by www.focalagent.com

view this property online williamhbrown.co.uk/Property/LBH114749



Property Ref:
LBH114749 - 0006

1. MONEY LAUNDERING REGULATIONS Intending purchasers will be asked to produce identification documentation at a later stage and we would ask for your co-operation in order that there is no delay in agreeing the sale. 2. These particulars do not constitute part or all of an offer or contract. 3. The measurements indicated are supplied for guidance only and as such must be considered incorrect. Potential buyers are advised to recheck measurements before committing to any expense. 4. We have not tested any apparatus, equipment, fixtures or services and it is in the buyers interest to check the working condition of any appliances. 5. Where an EPC, or a Home Report (Scotland only) is held for this property, it is available for inspection at the branch by appointment. If you require a printed version of a Home Report, you will need to pay a reasonable production charge reflecting printing and other costs. 6. We are not able to offer an opinion either written or verbal on the content of these reports and this must be obtained from your legal representative. 7. Whilst we take care in preparing these reports, a buyer should ensure that his/her legal representative confirms as soon as possible all matters relating to title including the extent and boundaries of the property and other important matters before exchange of contracts.

William H Brown is a trading name of Sequence (UK) Limited which is registered in England and Wales under company number 4268443, Registered Office is Cumbria House, 16-20 Hockliffe Street, Leighton Buzzard, Bedfordshire, LU7 1GN. VAT Registration Number is 500 2481 05.

william h brown



01509 214686



loughborough@williamhbrown.co.uk



22-23 Swan Street, LOUGHBOROUGH,
Leicestershire, LE11 5BL



williamhbrown.co.uk