



St John Street, Lewes BN7 2QE

welcome to

St John Street, Lewes

£650,000-£700,000. Set in the centre of Lewes. This end of terrace four bedroom town house built in 1979 is arranged over three floors and benefits from generously sized bedrooms and benefits from its own driveway.



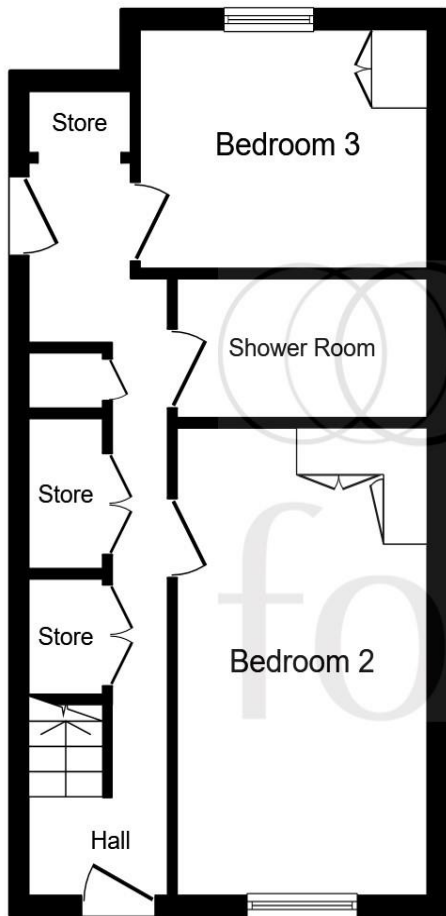

Ground Floor

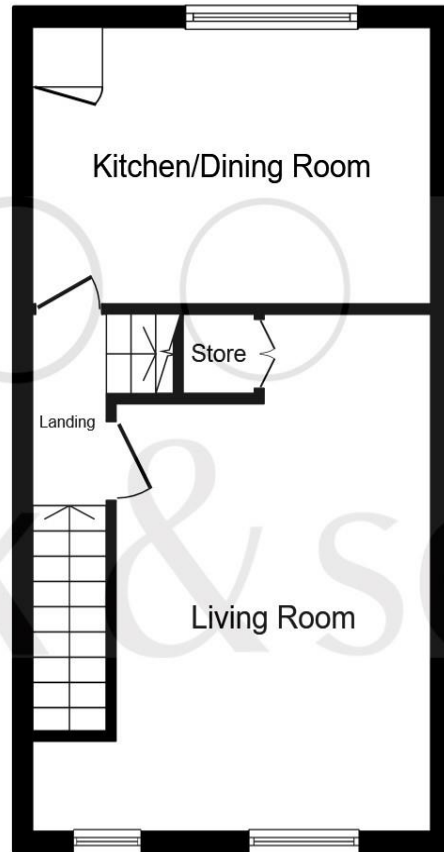

First Floor

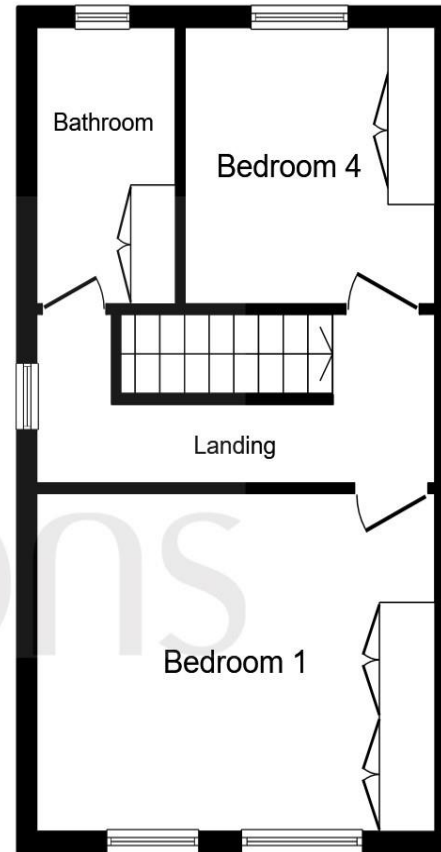

Second Floor

Lounge

17' 8" x 11' 1" (5.38m x 3.38m)

Kitchen

10' 3" x 14' 4" (3.12m x 4.37m)

Bedroom One

12' 3" x 11' 5" (3.73m x 3.48m)

Bedroom Two

8' 8" x 10' 4" (2.64m x 3.15m)

Bedroom Three

16' 2" x 9' (4.93m x 2.74m)

Bedroom Four/ Study

9' 6" x 8' 11" (2.90m x 2.72m)

This floor plan is for illustrative purposes only. It is not drawn to scale. Any measurements, floor areas (including any total floor area), openings and orientation are approximate. No details are guaranteed, they cannot be relied upon for any purpose and they do not form part of any agreement. No liability is taken for any error, omission or misstatement. A party must rely upon its own inspection(s). Plan produced for Fox & Sons Powered by www.focalagent.com

welcome to

St John Street, Lewes

- Popular Central Lewes Area
- End-of-Terrace Property
- Four Bedrooms
- Spacious Lounge
- Kitchen / Diner

Tenure: Freehold EPC Rating: D

£650,000



Please note the marker reflects the postcode not the actual property

view this property online fox-and-sons.co.uk/Property/LEW104687

see all our properties on zoopla.co.uk | rightmove.co.uk | fox-and-sons.co.uk



Property Ref:
LEW104687 - 0008

1. MONEY LAUNDERING REGULATIONS Intending purchasers will be asked to produce identification documentation at a later stage and we would ask for your co-operation in order that there is no delay in agreeing the sale. 2. These particulars do not constitute part or all of an offer or contract. 3. The measurements indicated are supplied for guidance only and as such must be considered incorrect. Potential buyers are advised to recheck measurements before committing to any expense. 4. We have not tested any apparatus, equipment, fixtures or services and it is in the buyers interest to check the working condition of any appliances. 5. Where an EPC, or a Home Report (Scotland only) is held for this property, it is available for inspection at the branch by appointment. If you require a printed version of a Home Report, you will need to pay a reasonable production charge reflecting printing and other costs. 6. We are not able to offer an opinion either written or verbal on the content of these reports and this must be obtained from your legal representative. 7. Whilst we take care in preparing these reports, a buyer should ensure that his/her legal representative confirms as soon as possible all matters relating to title including the extent and boundaries of the property and other important matters before exchange of contracts.

fox & sons



01273 476378



Lewes@fox-and-sons.co.uk



192 High Street, LEWES, East Sussex, BN7 2NS



fox-and-sons.co.uk