



Hollybush Close, Leicester LE5 2HZ

welcome to

Hollybush Close, Leicester

A three bedroom end-terraced house located in a popular area offering entrance hall, cloakroom, lounge/dining room, kitchen, utility room, three bedrooms and a bathroom. To the front of the property is parking. To the rear of the property is a large garden laid to lawn with a shed and side access

Auctioneer's Comments

This property is offered through Modern Method of Auction. Should you view, offer or bid your data will be shared with the Auctioneer, iamsold Limited. This method requires both parties to complete the transaction within 56 days, allowing buyers to proceed with mortgage finance (subject to lending criteria, affordability and survey).

The buyer is required to sign a reservation agreement and make payment of a non-refundable Reservation Fee of 4.5% of the purchase price including VAT, subject to a minimum of £6600.00 including VAT. This fee is paid in addition to purchase price and will be considered as part of the chargeable consideration for the property in the calculation for stamp duty liability. Buyers will be required to complete an identification process with iamsold and provide proof of how the purchase would be funded.

The property has a Buyer Information Pack containing documents about the property. The documents may not tell you everything you need to know, so you must complete your own due diligence before bidding. A sample of the Reservation Agreement and terms and conditions are contained within this pack. The buyer will also make payment of £300 inc VAT towards the preparation cost of the pack.

The estate agent and auctioneer may recommend the services of other providers to you, in which they will be paid for the referral. These services are optional, and you will be advised of any payment, in writing before any services are accepted. Listing is subject to a start price and undisclosed reserve price that can change.

Entrance Hall

Door to the front and radiator.

Cloakroom

Window to the side, WC, hand wash basin and radiator.

Lounge / Dining Room

24' 10" x 10' 3" (7.57m x 3.12m)

Window to the front, window to the rear and two radiators.

Kitchen

8' 8" x 10' 8" (2.64m x 3.25m)

Fitted kitchen comprising of wall and base units with work surfaces over, sink drainer unit, radiator and space for appliances. Window to the rear and door to the rear.

Utility Room

Fitted with wall and base units.

First Floor Landing

Storage cupboard.

Bedroom One

11' 8" x 10' 3" (3.56m x 3.12m)

Window to the front and radiator.

Bedroom Two

11' 5" x 10' 3" (3.48m x 3.12m)

Window to the rear and radiator.

Bedroom Three

8' 5" x 8' 5" (2.57m x 2.57m)

Window to the front and radiator.



Bathroom

Window to the rear, bath with shower over, WC, hand wash basin, storage cupboard and towel rail.

Front & Rear Of Property

To the front of the property is parking. To the rear of the property is a large garden laid to lawn with a shed and side access.



view this property online williamhbrown.co.uk/Property/LHS115457



welcome to

Hollybush Close, Leicester

- Sale by Modern Auction (T&Cs apply)
- Subject to an undisclosed Reserve Price
- Buyers fees apply
- Auction Ends 02-10-2024 at 14:00
- Three Bedroom End-Terraced

Tenure: Freehold EPC Rating: C

guide price

£225,000

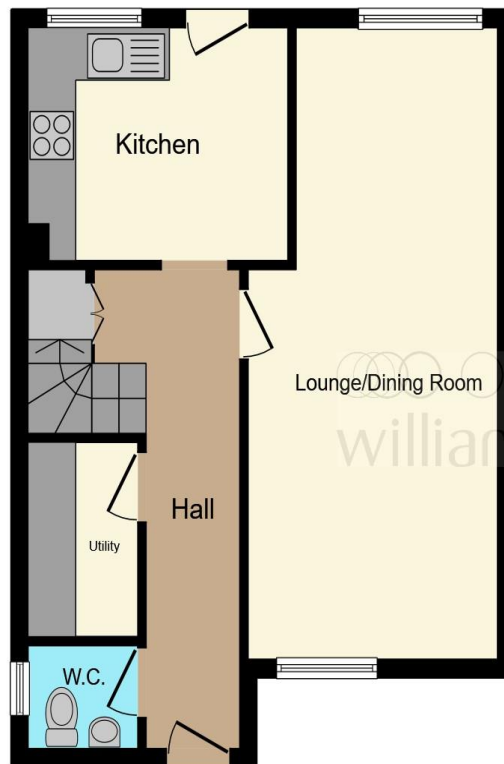

Ground Floor

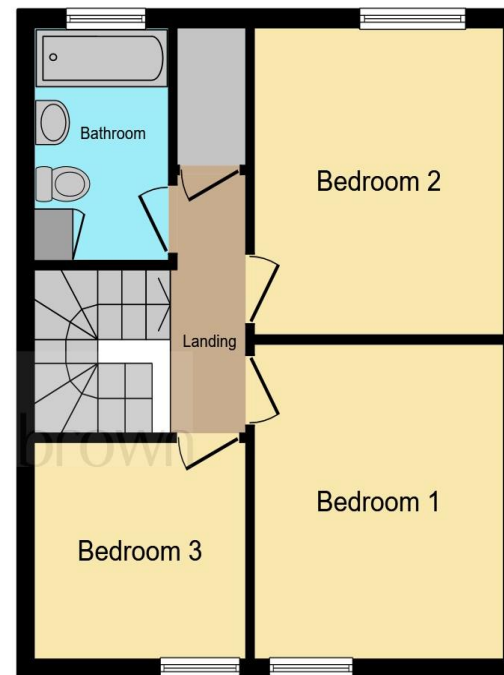

First Floor

This floor plan is for illustrative purposes only. It is not drawn to scale. Any measurements, floor areas (including any total floor area), openings and orientation are approximate. No details are guaranteed, they cannot be relied upon for any purpose and they do not form part of any agreement. No liability is taken for any error, omission or misstatement. A party must rely upon its own inspection(s). Powered by www.focalagent.com

view this property online williamhbrown.co.uk/Property/LHS115457



Property Ref:
LHS115457 - 0004

1. MONEY LAUNDERING REGULATIONS Intending purchasers will be asked to produce identification documentation at a later stage and we would ask for your co-operation in order that there is no delay in agreeing the sale. 2. These particulars do not constitute part or all of an offer or contract. 3. The measurements indicated are supplied for guidance only and as such must be considered incorrect. Potential buyers are advised to recheck measurements before committing to any expense. 4. We have not tested any apparatus, equipment, fixtures or services and it is in the buyers interest to check the working condition of any appliances. 5. Where an EPC, or a Home Report (Scotland only) is held for this property, it is available for inspection at the branch by appointment. If you require a printed version of a Home Report, you will need to pay a reasonable production charge reflecting printing and other costs. 6. We are not able to offer an opinion either written or verbal on the content of these reports and this must be obtained from your legal representative. 7. Whilst we take care in preparing these reports, a buyer should ensure that his/her legal representative confirms as soon as possible all matters relating to title including the extent and boundaries of the property and other important matters before exchange of contracts.

William H Brown is a trading name of Sequence (UK) Limited which is registered in England and Wales under company number 4268443. Registered Office is Cumbria House, 16-20 Hockliffe Street, Leighton Buzzard, Bedfordshire, LU7 1GN. VAT Registration Number is 500 2481 05.

william h brown



0116 251 4131



Leicester@williamhbrown.co.uk



16-18 Halford Street, LEICESTER, Leicestershire,
LE1 1JB



williamhbrown.co.uk