



The Exchange Lee Street, Leicester LE1 3AJ

welcome to

The Exchange Lee Street, Leicester

This two bedroom duplex apartment is situated in Leicester city centre and comprises of entrance hall, lounge and kitchen areas and bathroom downstairs with the two bedrooms upstairs. The property offers communal areas including a gym and viewing is highly recommended. No Upper Chain.



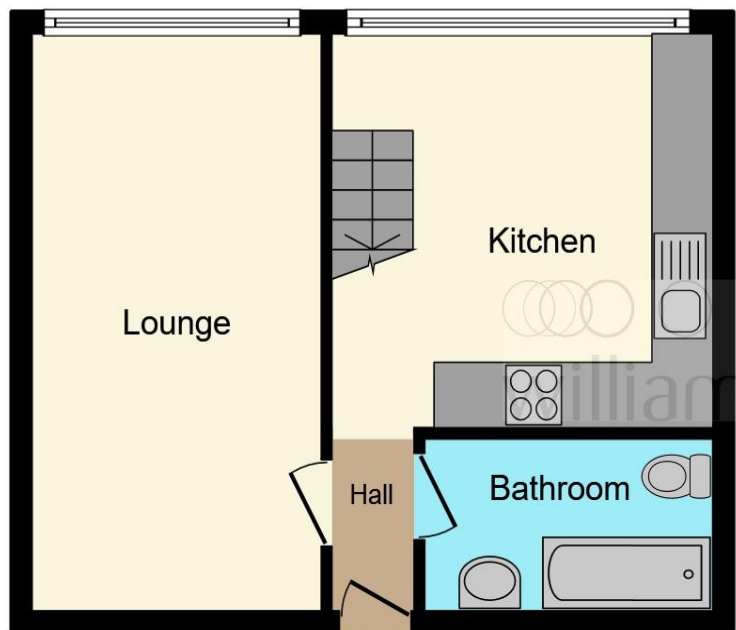

Ground Floor

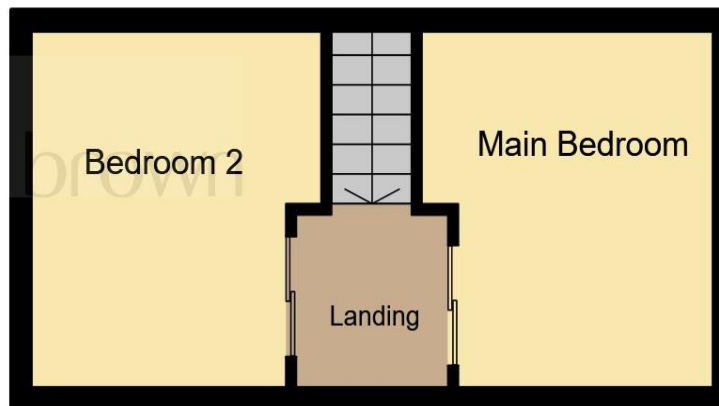

First Floor

Communal Entrance

Lounge Area

16' 10" x 9' 10" (5.13m x 3.00m)

Kitchen Area

11' x 9' 10" (3.35m x 3.00m)

Bathroom

First Floor

Bedroom One

11' x 9' 10" (3.35m x 3.00m)

Bedroom Two

10' 11" x 9' 10" (3.33m x 3.00m)

This floorplan is for illustrative purposes only and is not drawn to scale. Measurements, floor-areas, openings and orientations are approximate. They should not be relied upon for any purpose and do not form any part of an agreement. No liability is taken for any error or mis-statement. All parties must rely on their own inspections.

welcome to

The Exchange Lee Street, Leicester

- Duplex Apartment
- Two Bedrooms
- City Centre Location
- Residents Gym
- No Upper Chain

Tenure: Leasehold EPC Rating: C

Council Tax Band: C Service Charge: 2250.00

Ground Rent: 250.00

This is a Leasehold property with details as follows; Term of Lease 120 years from 01 Feb 2011.
Should you require further information please contact the branch. Please Note additional fees could be incurred for items such as Leasehold packs.

offers over

£80,000



Please note the marker reflects the postcode not the actual property

view this property online [williamhbrown.co.uk/Property/LHS117191](https://www.williamhbrown.co.uk/Property/LHS117191)



Property Ref:
LHS117191 - 0021

1. MONEY LAUNDERING REGULATIONS Intending purchasers will be asked to produce identification documentation at a later stage and we would ask for your co-operation in order that there is no delay in agreeing the sale. 2. These particulars do not constitute part or all of an offer or contract. 3. The measurements indicated are supplied for guidance only and as such must be considered incorrect. Potential buyers are advised to recheck measurements before committing to any expense. 4. We have not tested any apparatus, equipment, fixtures or services and it is in the buyers interest to check the working condition of any appliances. 5. Where an EPC, or a Home Report (Scotland only) is held for this property, it is available for inspection at the branch by appointment. If you require a printed version of a Home Report, you will need to pay a reasonable production charge reflecting printing and other costs. 6. We are not able to offer an opinion either written or verbal on the content of these reports and this must be obtained from your legal representative. 7. Whilst we take care in preparing these reports, a buyer should ensure that his/her legal representative confirms as soon as possible all matters relating to title including the extent and boundaries of the property and other important matters before exchange of contracts.

William H Brown is a trading name of Sequence (UK) Limited which is registered in England and Wales under company number 4268443, Registered Office is Cumbria House, 16-20 Hockliffe Street, Leighton Buzzard, Bedfordshire, LU7 1GN. VAT Registration Number is 500 2481 05.



william h brown



0116 251 4131



Leicester@williamhbrown.co.uk



16-18 Halford Street, LEICESTER, Leicestershire,
LE1 1JB



[williamhbrown.co.uk](https://www.williamhbrown.co.uk)